

# ProChipper®



tooling systems



**Fräswerkzeuge mit Bohrung, profiliert**  
*Bored, profiled Cutting Tools*

**Zum Fügen, Fasen bzw. Abrunden variabler Holzstärke**  
*For jointing, chamfering, or rounding wood of variable thickness*

MEC

HW

Nr.	D	B	d	Z	R	n <sub>max</sub>	Art. Nr.
1	140	60	30/50	3		8500	<b>8214.140.060</b>
2	153	18	30/50	3	5	8500	<b>8214.153.018</b>
3	153	18	30/50	3	5	8500	<b>8214.153.118</b>
1+2+3			30/50	3		8500	<b>8214.000.000</b>

- HW-bestückte Füge-, Fase- und Abrundfräser - Kombinationswerkzeuge zum Fügen, Fasen und Abrunden von Holz unterschiedlicher Stärke für mechanischen Vorschub
- *TC-tipped jointing, chamfering, and rounding cutters - combination tools for jointing, chamfering, and rounding wood of varying thicknesses for mechanical feed*

**Ersatzteile**  
*Spare parts*

	B	Art. Nr.
Zwischenringsatz - <i>Spacer set</i>	22	<b>703.015</b>

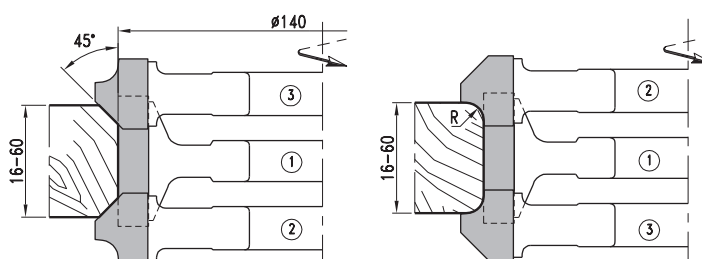

- Einstellung der Holzstärke über Zwischenringe von 16 mm - 60 mm
- *adjustment of wood thickness using spacer rings from 16 mm - 60 mm*



**Zum Fügen bzw. Abrunden variabler Holzstärken**  
*For jointing and rounding wood of variable thickness*

MEC

HW

Nr.	D	d	Z	R	n <sub>max</sub>	Art. Nr.
1	140	50	4	3	9500	<b>8284.140.003</b>
1	140	50	4	5	9500	<b>8284.140.005</b>
1	140	50	4	8	9500	<b>8284.140.008</b>
2	140	50	4	3	9500	<b>8284.140.103</b>
2	140	50	4	5	9500	<b>8284.140.105</b>
2	140	50	4	8	9500	<b>8284.140.108</b>

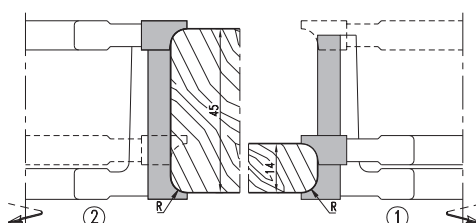
- HW-bestückte Füge- und Abrundfräser - Kombinationswerkzeuge zum Fügen und Abrunden von Holz unterschiedlicher Stärke für mechanischen Vorschub
- Einstellung der Holzstärke über Zwischenringe von 14 mm - 45 mm
- *TC-tipped jointing and rounding cutters - combination tools for jointing and rounding wood of varying thicknesses for mechanical feed*
- *adjustment of wood thickness using spacer rings from 14 mm - 45 mm*



3111

## HS-/HW-Hydro-Profilfräser – Festbestückt

### HSS/TC Hydro Profile Cutter - Tipped

PG  
02

#### Riffel Profilbeispiel am Hydrofräser

##### Example of a profiled hydro cutter

MEC

- Hydro-Profilhobelwerkzeuge mit hochpräziser, zentrischer Hydrospannung gewährleisten eine maximale Rundlaufgenauigkeit. Die Profilierung der festbestückten Hydro-Ausführung mit Schneiden aus HS bzw. HM erfolgt individuell nach Kundenwunsch. Diese Werkzeugsysteme erzeugen ein gleichmäßiges, nahezu messerschlagfreies Hobelbild. Durch die festbestückte Ausführung ist eine enge Verzahnung möglich, was zu erhöhter Produktivität bei hohen Vorschubgeschwindigkeiten führt.
- *Hydro profile planing tools with high-precision central hydro clamping ensure maximum running accuracy. The profile design of the fixed-tip hydro version, equipped with HSS or carbide, is manufactured according to customer specifications. These tool systems produce a consistent, nearly chatter-free surface finish. The fixed-tipped design allows for tight tooth spacing, resulting in increased productivity at high feed rates.*

4869

## HW-Füge-, Fase- und Radienfräser, verstellbar – Wendemesser

### TC Jointing, Chamfering, and Radius Cutter Set, Adjustable - Reversible Knives

PG  
02

#### Auslieferung mit Kantenrunder R=3

##### Cutter set supplied with edge rounding blade R=3

MAN

HW

D	B	d	Z	C	$n_{min} - n_{max}$	Art. Nr.
125	50	40/50	4	4	6200-12600	4869.125.050

- Fasefräser für Handvorschub: vielseitiger WP-Fase- oder Abrundfräser zum Fügen, Fasen bzw. Abrunden von Holz unterschiedlicher Stärke bei manuellem Vorschub
- Die Holzstärke wird über auf einer Skala verschiebbare Messträger eingestellt und ist im Bereich 12 mm bis 50 mm variabel einstellbar
- *chamfer cutter for manual feed: a versatile chamfer and rounding cutter for jointing, chamfering, and rounding wood of varying thicknesses in manual feed*
- *wood thickness is adjusted via holders that are movable along a scale and can be set between 12 mm and 50 mm*

#### Wendemesser/Ersatzteile

##### Reversible knives/Spare parts

	Dim.	Art. Nr.
Zwischenringsatz - Spacer set	50x12x1,5	750.106
Spannkeil - Clamping wedge		707.002.48
Gewindestift - Set screw	M8x16	705.542
Fasenmesser - Chamfering blade	45°	780.260
Kantenrunder - Edge rounding blade	R=2	780.250
Kantenrunder - Edge rounding blade	R=3	780.251
Spannschraube - Clamping screw	M5x13,5	705.318
Gewindestift - Set screw	M5x12	705.523
Sechskantschlüssel - Allen key	SW2,5 (M5)	706.102
Sechskantschlüssel - Allen key	SW4 (M8)	706.104

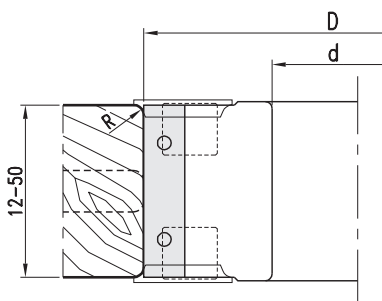
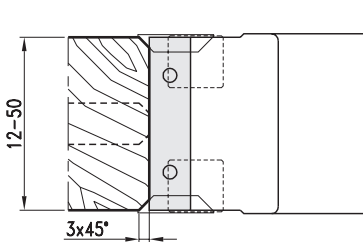

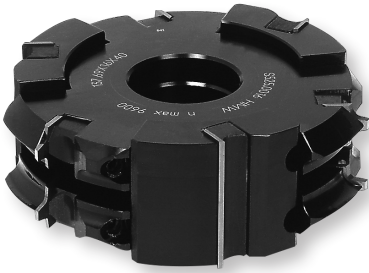

**Kombinationswerkzeuge zum Fasen bzw. Abrunden variabler Holzstärken**  
*Combination tools for chamfering and rounding wood of variable thickness*

MEC

HW

Nr.	D	B	d	Z	R	Art. Nr.
1	100	30	30	2		<b>5214.100.030</b>
1	100	50	30	2		<b>5214.100.050</b>
1	125	30	40/50	3		<b>5214.125.030</b>
1	125	50	40/50	3		<b>5214.125.050</b>
2	113	16	30	2	2,3,4,5,6 / 45°	① <b>5214.113.016</b>
2	137	16	40/50	3	2,3,4,5,6 / 45°	① <b>5214.137.016</b>
2	146	25	40/50	3	8,10 / 45°	① <b>5214.146.025</b>

① Ohne Wendemesser und Zwischenringsatz, bitte bestellen Sie diese separat.

① reversible blades and spacer set are not included, please order them separately

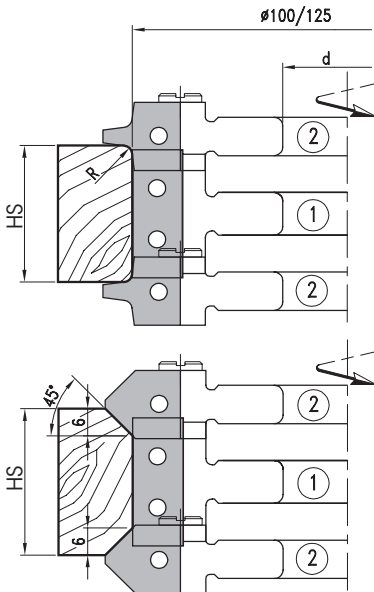

**Wendemesser/Ersatzteile**  
*Reversible knives/Spare parts*

	Dim.	R	Art. Nr.
Wendemesser - Reversible knife	30x12x1,5		<b>750.104</b>
	50x12x1,5		<b>750.106</b>
	16x17,5x2	R2	<b>765.101</b>
	16x17,5x2	R3	<b>765.102</b>
	16x17,5x2	R4	<b>765.103</b>
	16x17,5x2	R5	<b>765.104</b>
	16x17,5x2	R6	<b>765.105</b>
	25x25x2	R8	<b>765.107</b>
	25x25x2	R10	<b>765.109</b>
	16x17,5x2	7x45°	<b>765.501</b>
25x25x2	10x45°	<b>765.502</b>	
Spannkeil - Clamping wedge	B30		<b>707.001.28</b>
	B50		<b>707.001.48</b>
		R2-6 / 45°	<b>707.155</b>
		R8-10 / 45°	<b>707.280</b>
Gewindestift - Set screw	M6x10	R2-6 / 45°	<b>705.532</b>
	M8x12	R8-10 / 45°	<b>705.541</b>
Sechskantschlüssel - Allen key	SW3 (M6)		<b>706.103</b>
	SW4 (M8)		<b>706.104</b>

	Nr.1 (B 30)		Nr.1 (B 50)	
	HS min-max	2x(1)	HS min-max	2x(1)
R2-6/45°	12-39	703.009	16-60	703.015
R8-12/45°	20-47	703.010	20-67	703.012

(1) Verstellbarkeit der Holzstärke, Art. Nr. Zwischenringsatz

(1) adjustability of wood thickness (HS), Art. No. spacer set

• RPM	D100-113	n <sub>max</sub> 11800
	D125-137	n <sub>max</sub> 9100
	D125-146	n <sub>max</sub> 9100

**Einstellung der Holzstärke mit Zwischenringen – folgende Holzstärken sind einstellbar:**  
*Adjustment of wood thickness through spacer rings - available thickness settings*

Holzstärke	
D100/D113 B30 Z=2 R2-6 bzw. 45°	12-39 mm
D100/D113 B50 Z=2 R2-6 bzw. 45°	16-60 mm
D125/D137 B30 Z=3 R2-6 bzw. 45°	12-39 mm
D125/D137 B50 Z=3 R2-6 bzw. 45°	16-60 mm
D125/D146 B30 Z=3 R8-10 bzw. 45°	20-47 mm
D125/D146 B50 Z=3 R8-10 bzw. 45°	20-67 mm

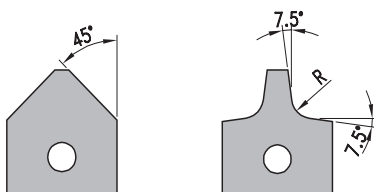

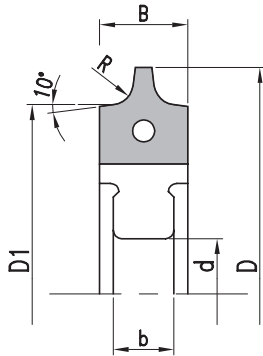

**WP-Abrundfräser für runde Anleimerkanten an Kantenbearbeitungsanlagen**  
*Rounding cutter with reversible knives for round edgebandings on edge processing machines*
**MEC****HW**

D	D1	B/d	d	DKN	R	Z	n <sub>max</sub>	Art. Nr.
<b>Homag - Gabbiani - Ott</b>								
73	61,0	16/11	16	5x2,3	2	3	18000	<b>5114.073.002</b>
73	61,0	16/11	16	5x2,3	3	3	18000	<b>5114.073.003</b>
73	61,0	16/11	16	5x2,3	4	3	18000	<b>5114.073.004</b>
73	61,0	16/11	16	5x2,3	5	3	18000	<b>5114.073.005</b>
<b>HolzHer</b>								
73	61,0	16/11	20	6x3,5	2	3	18000	<b>5114.173.002</b>
73	61,0	16/11	20	6x3,5	3	3	18000	<b>5114.173.003</b>
73	61,0	16/11	20	6x3,5	4	3	18000	<b>5114.173.004</b>
73	61,0	16/11	20	6x3,5	5	3	18000	<b>5114.173.005</b>
<b>IDM</b>								
73,3	61,3	16/10	16	5x2,3	2	3	18000	<b>5114.273.002</b>
73,3	61,3	16/10	16	5x2,3	3	3	18000	<b>5114.273.003</b>
73,3	61,3	16/10	16	5x2,3	4	3	18000	<b>5114.273.004</b>
73,3	61,3	16/10	16	5x2,3	5	3	18000	<b>5114.273.005</b>
<b>IMA - Wilmsmeyer</b>								
82	70,0	16/10	20	6x3,5	2	4	18000	<b>5114.082.002</b>
82	70,0	16/10	20	6x3,5	3	4	18000	<b>5114.082.003</b>
82	70,0	16/10	20	6x3,5	4	4	18000	<b>5114.082.004</b>
82	70,0	16/10	20	6x3,5	5	4	18000	<b>5114.082.005</b>

**Wendemesser/Ersatzteile**
*Reversible knives/Spare parts*

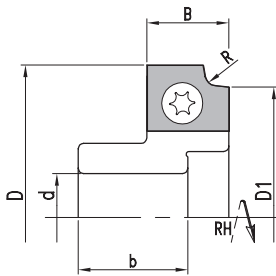
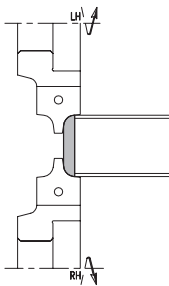
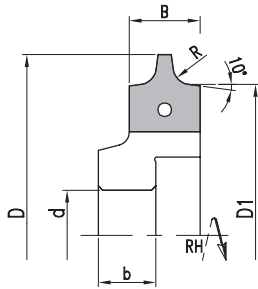
	Dim.	R	Art. Nr.
Wendemesser - <i>Reversible knife</i>	16x17,5x2	R 2	<b>765.101</b>
	16x17,5x2	R 3	<b>765.102</b>
	16x17,5x2	R 4	<b>765.103</b>
	16x17,5x2	R 5	<b>765.104</b>
Spannkeil - <i>Clamping wedge</i>			<b>707.155</b>
Gewindestift - <i>Set screw</i>	M6x12		<b>705.533</b>
Sechskantschlüssel - <i>Allen key</i>	SW3		<b>706.103</b>

**WP-Abrundfräser für runde Anleimerkanten an Kantenbearbeitungsanlagen**  
*Rounding cutter with reversible knives for round edgebandings on edge processing machines*
**MEC****HW**

D	D1	B/d	d	DKN	R	Z	n <sub>max</sub>	Art. Nr. RH	Art. Nr. LH
<b>IMA</b>									
82	70	16/13	20	6x3,5	2	4	18000	<b>5174.082.002</b>	<b>5174.082.102</b>
	70	16/13	20	6x3,5	3	4	18000	<b>5174.082.003</b>	<b>5174.082.103</b>
	70	16/13	20	6x3,5	4	4	18000	<b>5174.082.004</b>	<b>5174.082.104</b>
	70	16/13	20	6x3,5	5	4	18000	<b>5174.082.005</b>	<b>5174.082.105</b>

**Wendemesser/Ersatzteile***Reversible knives/Spare parts*

	Dim.	R	Art. Nr.
Wendemesser - <i>Reversible knife</i>	16x17,5x2	R 2	<b>765.101</b>
	16x17,5x2	R 3	<b>765.102</b>
	16x17,5x2	R 4	<b>765.103</b>
	16x17,5x2	R 5	<b>765.104</b>
Spannkeil - <i>Clamping wedge</i>			<b>707.155</b>
Gewindestift - <i>Set screw</i>	M6x12		<b>705.533</b>
Sechskantschlüssel - <i>Allen key</i>	SW3		<b>706.103</b>

**WP-Abrundfräser für runde Anleimerkanten an Kantenbearbeitungsanlagen**  
*Rounding cutter with reversible knives for round edgebandings on edge processing machines*
**MEC****HW**

D	D1	B/d	d	DKN	R	Z	n <sub>max</sub>	Art. Nr. RH	Art. Nr. LH
<b>SCM</b>									
55,5	47,5	15/20	20	6x3,5	1,0	2	18000	<b>5174.056.001</b>	<b>5174.056.101</b>
	47,5	15/20	20	6x3,5	1,5	2	18000	<b>5174.056.002</b>	<b>5174.056.102</b>
	47,5	15/20	20	6x3,5	2,0	2	18000	<b>5174.056.202</b>	<b>5174.056.302</b>
	47,5	15/20	20	6x3,5	2,5	2	18000	<b>5174.056.003</b>	<b>5174.056.103</b>
	47,5	15/20	20	6x3,5	3,0	2	18000	<b>5174.056.203</b>	<b>5174.056.303</b>

**Wendemesser/Ersatzteile***Reversible knives/Spare parts*

	Dim.	R	Art. Nr.
Wendemesser - <i>Reversible knife</i>	15x12x1,5	R 1,0	<b>765.200</b>
	15x12x1,5	R 1,5	<b>765.201</b>
	15x12x1,5	R 2,0	<b>765.202</b>
	15x12x1,5	R 2,5	<b>765.203</b>
	15x12x1,5	R 3,0	<b>765.204</b>
Spannkeil - <i>Clamping wedge</i>	15x12x1,5	R 3,0	<b>765.204</b>
Torx Schrauben - <i>Torx screws</i>	M3,5x7,5		<b>705.352</b>
Sechskantschlüssel - <i>Allen key</i>	T15		<b>706.302</b>

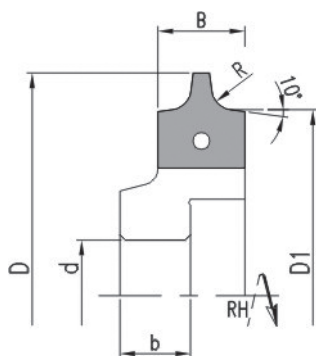
**WP-Abrundfräser für runde Anleimerkanten an Kantenbearbeitungsanlagen**  
*Rounding cutter with reversible knives for edge bandings on edge processing machines*
**MEC****HW**

D	B/d	d	DKN	R	Z	n <sub>max</sub>	Art. Nr. RH	Art. Nr. LH
<b>Biese</b>								
70	16/19	16	5x2,3	2	6	18000	<b>5174.070.002</b>	<b>5174.070.102</b>
70	16/19	16	5x2,3	3	6	18000	<b>5174.070.003</b>	<b>5174.070.103</b>
70	16/19	16	5x2,3	4	6	18000	<b>5174.070.004</b>	<b>5174.070.104</b>
70	16/19	16	5x2,3	5	6	18000	<b>5174.070.005</b>	<b>5174.070.105</b>

**Wendemesser/Ersatzteile***Reversible knives/Spare parts*

	Dim.	R	Art. Nr.
Wendemesser - <i>Reversible knife</i>	16x17,5x2	R 2	<b>765.101</b>
	16x17,5x2	R 3	<b>765.102</b>
	16x17,5x2	R 4	<b>765.103</b>
	16x17,5x2	R 5	<b>765.104</b>
Spannkeil - <i>Clamping wedge</i>			<b>707.155</b>
Gewindestift - <i>Set screw</i>	M6x12		<b>705.533</b>
Sechskantschlüssel - <i>Allen key</i>	SW3		<b>706.103</b>

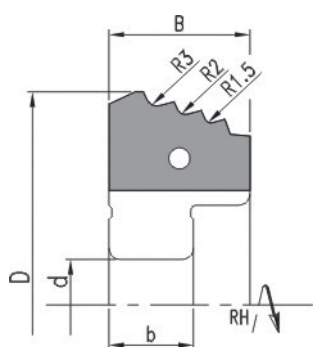
**WP-Multi-Abrundfräser für unterschiedliche Radien der Anleimerkante**  
*Multi-radius edge rounding cutter with reversible knives for different edgeband radii*
**MEC****HW**

D	B	d	DKN	R	Z	n <sub>max</sub>	Art. Nr. RH	Art. Nr. LH
<b>Biese</b>								
75	25	20	6x3,5	1,5/2/3	4	18000	<b>5174.075.002</b>	<b>5174.075.102</b>

**Wendemesser/Ersatzteile***Reversible knives/Spare parts*

	Dim.	R	Art. Nr.
Wendemesser - <i>Reversible knife</i>	25x18,5x2	R 1,5/R2/R3	<b>765.112</b>
Spannkeil - <i>Clamping wedge</i>			<b>707.557.01</b>
Gewindestift - <i>Set screw</i>	M6x12		<b>705.533</b>
Sechskantschlüssel - <i>Allen key</i>	SW3		<b>706.103</b>



**WP-Abrundfräser mit HSK25R Aufnahme für runde Anleimerkanten an Kantenbearbeitungsanlagen**  
*Rounding cutter with replaceable knives and HSK25R shank for edge banding on edge processing machines*

**MEC****HW**

D	b	d	Z	R	n <sub>max</sub>	Art. Nr. RH	Art. Nr. LH
<b>Homag - IMA</b>							
79	23	HSK25R	4	2	18000	<b>5112.079.002</b>	<b>5112.079.102</b>
79	23	HSK25R	4	3	18000	<b>5112.079.003</b>	<b>5112.079.103</b>
85	24	HSK25R	4	4	17700	<b>5112.085.004</b>	<b>5112.085.104</b>
85	24	HSK25R	4	5	17700	<b>5112.085.005</b>	<b>5112.085.105</b>

**Wechselmesser/Ersatzteile***Replacement knives/Spare parts*

	R	Dim.	Art. Nr. RH	Art.Nr. LH
Wechselmesser - <i>Replacement knife</i>	2	12x17x2	<b>765.201</b>	<b>765.202</b>
	3	12x17x2	<b>765.203</b>	<b>765.204</b>
	4	12x20x2	<b>765.205</b>	<b>765.206</b>
	5	12x20x2	<b>765.207</b>	<b>765.208</b>
Spannkeil - <i>Clamping wedge</i>			<b>707.900.01</b>	<b>707.900.02</b>
Gewindestift - <i>Set screw</i>		M6x12		<b>705.533</b>
Sechskantschlüssel - <i>Allen key</i>		SW3		<b>706.103</b>
Spannschraube für HSK25R - <i>Clamping screw for HSK25R</i>		M10x1,25		<b>705.099</b>
Sechskantschlüssel - <i>Allen key</i>		SW10		<b>706.107</b>

**Ausführung mit ziehendem Schnitt***With axial angle*

D	b	d	Z	R	n <sub>max</sub>	Art. Nr. RH	Art. Nr. LH
<b>Homag - IMA</b>							
79	23	HSK25R	4	2	18000	<b>5112.079.202</b>	<b>5112.079.302</b>
79	23	HSK25R	4	3	18000	<b>5112.079.203</b>	<b>5112.079.303</b>

**Wechselmesser/Ersatzteile***Replacement knives/Spare parts*

	R	Dim.	Art. Nr. RH	Art.Nr. LH
Wendemeser - <i>Replacement knife</i>	2	12x17x2	<b>765.209</b>	<b>765.210</b>
	3	12x17x2	<b>765.211</b>	<b>765.212</b>
Spannkeil - <i>Clamping wedge</i>			<b>707.902.03</b>	<b>707.902.04</b>
Gewindestift - <i>Set screw</i>		M6x12		<b>705.533</b>
Spannschraube für HSK25R - <i>Clamping screw for HSK25R</i>		M10x1,25		<b>705.099</b>
Sechskantschlüssel - <i>Allen key</i>		SW10		<b>706.107</b>

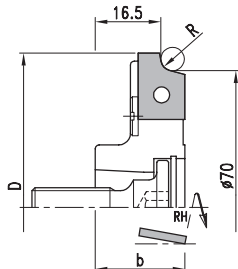
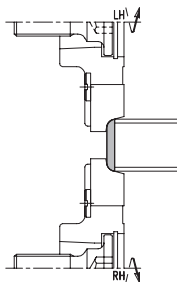
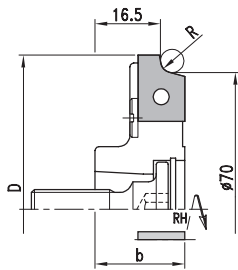

- Mit ziehendem Schnitt
- with axial angle

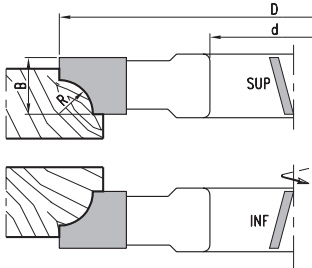

- Mit ziehemdem Schnitt
- with axial angle

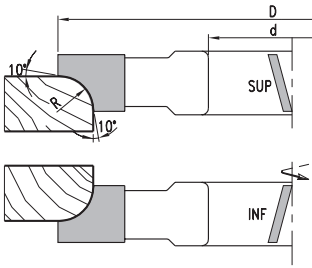

- Mit ziehemdem Schnitt
- with axial angle

**HW-bestückter Viertelstabfräser zum Abrunden mit ziehemdem Schnitt**  
*TC-tipped quarter-round cutter for rounding with axial angle*
**MAN**
**HW**

D	B	d	Z	R	$n_{min} - n_{max}$	Art. Nr. RH	Art. Nr. LH
140	12	30/50	4	5	5500-9500	<b>8619.140.012</b>	<b>8619.140.112</b>
	14	30/50	4	7	5500-9500	<b>8619.140.014</b>	<b>8619.140.114</b>
	15	30/50	4	8	5500-9500	<b>8619.140.015</b>	<b>8619.140.115</b>
	17	30/50	4	10	5500-9500	<b>8619.140.017</b>	<b>8619.140.117</b>
	19	30/50	4	12	5500-9500	<b>8619.140.019</b>	<b>8619.140.119</b>
	22	30/50	4	15	5500-9500	<b>8619.140.022</b>	<b>8619.140.122</b>
	27	30/50	4	20	5500-9500	<b>8619.140.027</b>	<b>8619.140.127</b>
150	33	30/50	4	25	5200-8900	<b>8619.150.033</b>	<b>8619.150.133</b>
160	40	30/50	4	30	4800-8300	<b>8619.160.040</b>	<b>8619.160.140</b>
180	50	30/50	4	40	4300-7400	<b>8619.180.050</b>	<b>8619.180.150</b>

- Ausführung zum Kehlen für manuellen Vorschub ohne Auslauf
- for moulding on manual feed without profile relief

**HW-bestückter Viertelstabfräser zum Abrunden mit ziehemdem Schnitt**  
*TC-tipped quarter-round cutter for rounding with axial angle*

D	B	d	Z	R	$n_{min} - n_{max}$	Art. Nr. RH	Art. Nr. LH
140	12	30/50	4	5	5500-9500	<b>8619.140.212</b>	<b>8619.140.312</b>
	14	30/50	4	7	5500-9500	<b>8619.140.214</b>	<b>8619.140.314</b>
	15	30/50	4	8	5500-9500	<b>8619.140.215</b>	<b>8619.140.315</b>
	17	30/50	4	10	5500-9500	<b>8619.140.217</b>	<b>8619.140.317</b>
	19	30/50	4	12	5500-9500	<b>8619.140.219</b>	<b>8619.140.319</b>
	22	30/50	4	15	5500-9500	<b>8619.140.222</b>	<b>8619.140.322</b>
	27	30/50	4	20	5500-9500	<b>8619.140.227</b>	<b>8619.140.327</b>
150	33	30/50	4	25	5200-8900	<b>8619.150.233</b>	<b>8619.150.333</b>
160	40	30/50	4	30	4800-8300	<b>8619.160.240</b>	<b>8619.160.340</b>
180	50	30/50	4	40	4300-7400	<b>8619.180.250</b>	<b>8619.180.350</b>

- Ausführung mit beidseitigem Auslauf für manuellen Vorschub
- Ausführung mit 10° Auslauf
- design with double-sided profile relief for manual feed
- design with 10° profile relief

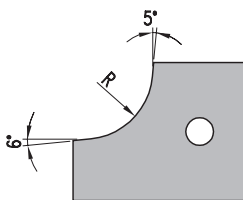
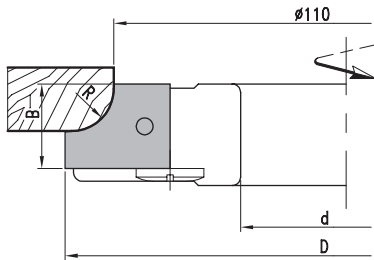
**WP-Abrundfräser für verschiedene Radienprofile**
*Rounding cutter with replaceable knives for various radius profiles*

MAN

HW

D	B	d	Z	R	$n_{min} - n_{max}$	Art. Nr.
125,5	20	30/50	3	5/7	6100-10500	① <b>4119.126.020</b>
132,5	20	30/50	3	8/10	5800-10000	① <b>4119.133.020</b>
141,0	25	30/50	3	12/15	5400-9400	① <b>4119.141.025</b>

- ① Ohne Wechselmesser, bitte bestellen Sie diese separat.
- ① *replacement knives are not included, please order them separately*

- Ausformung des Grundkörpers eignet sich zur Verwendung unterschiedlicher Radienprofile
- Ausführung für manuellen Vorschub
- *the tool body is suitable for use with different radius profiles for manual feed*

**Wechselmesser/ Ersatzteile**
*Replacement knives/Spare parts*

	R	Dim.	Art.Nr.
Wechselmesser - Replacement knife	5	20x20x2	<b>775.201</b>
	7	20x20x2	<b>775.202</b>
	8	20x25x2	<b>775.203</b>
	10	20x25x2	<b>775.204</b>
	12	25x30x2	<b>775.205</b>
	15	25x30x2	<b>775.206</b>
Spannkeil - Clamping wedge	5/7		<b>707.180</b>
	8/10		<b>707.181</b>
	12/15		<b>707.182</b>
Gewindestift - Set screw		M8x16	<b>705.542</b>
Sechskantschlüssel - Allen key		SW4	<b>706.104</b>

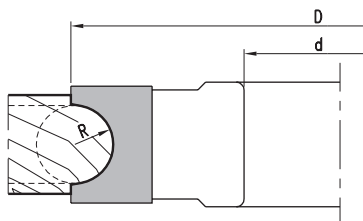
**HW-bestückter Halbstabfräser mit achsparallelen Schneiden**
*TC-tipped half-round cutter with axis-parallel blades*

MAN

HW

D	B	d	Z	R	$n_{min} - n_{max}$	Art. Nr.
140	28	30/50	4	7,5	5500-9500	<b>8119.140.028</b>
30	30/50	4	10		5500-9500	<b>8119.140.030</b>
40	30/50	4	12,5		5500-9500	<b>8119.140.040</b>
45	30/50	4	15		5500-9500	<b>8119.140.045</b>
50	30/50	4	17,5		5500-9500	<b>8119.140.050</b>
55	30/50	4	20		5500-9500	<b>8119.140.055</b>

- Serienartikel, kurzfristige Fertigung bei Bestellung
- *standard product, manufactured promptly upon order*

4179

## HW-Halbstafräser – Wechselmesser

### TC Half-Round Cutter - Replaceable Knives

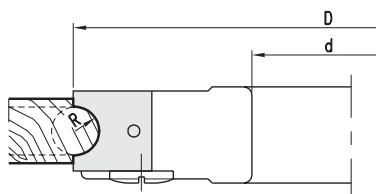
PG  
02

#### HW-bestückter Halbstafräser mit achsparallelen Schneiden

##### TC-tipped half-round cutter with axis-parallel blades

MAN

HW

D	B	d	Z	R	$n_{min} - n_{max}$	Art. Nr.
140	20	30/50	3	4/5/6	5500-9500	① 4179.140.020
	30	30/50	3	8/10	5500-9500	① 4179.140.030

- ① Ohne Wechselmesser, bitte bestellen Sie diese separat.
- ① replacement knives are not included, please order them separately

- Ausführung für manuellen Vorschub
- Bitte bestellen Sie mit Angabe des gewünschten Radius
- for manual feed
- please order specifying the requested radius

#### Wechselmesser/Ersatzteile

##### Replacement knives/Spare parts

	R	Dim.	Art.Nr.
Wechselmesser - Replacement knife	4	20x20x2	785.761
	5	20x20x2	785.762
	6	20x20x2	785.763
	8	30x25x2	785.764
	10	30x25x2	785.765
Spannkeil - Clamping wedge	4/5/6		707.002.18
	8/10		707.812
Gewindestift - Set screw		M8x16	705.542
Sechskantschlüssel - Allen key		SW4	706.104

8184

## HW-Hochkehlfräser – Festbestückt

### TC High-Cove Cutter - Tipped

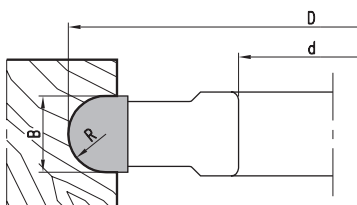
PG  
02

#### HW-bestückter Hohlkehlfräser mit achsparallelen Schneiden

##### TC-tipped high-cove cutter with axis-parallel blades

MAN

HW

D	B	d	Z	R	$n_{min} - n_{max}$	Art. Nr.
140	5	30/50	4	2,5	5500-9500	8184.140.005
	6	30/50	4	3,0	5500-9500	8184.140.006
	8	30/50	4	4,0	5500-9500	8184.140.008
	10	30/50	4	5,0	5500-9500	8184.140.010
	12	30/50	4	6,0	5500-9500	8184.140.012
	15	30/50	4	7,5	5500-9500	8184.140.015
	20	30/50	4	10,0	5500-9500	8184.140.020
	40	30/50	4	20,0	5500-9500	8184.140.040

- Ausführung für manuellen Vorschub
- for manual feed



8679

## HW-Halbhohlkehlfräser – Festbestückt

TC Half-Cove Cutter - Tipped

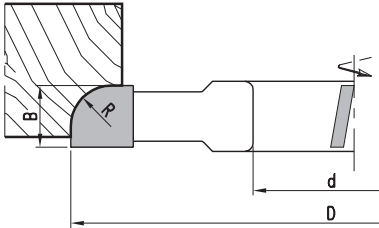
PG  
02

### HW-bestückter Halbhohlkehlfräser mit achswinkligen Schneiden

TC-tipped half-cove cutter with axis-angled blades

MAN

HW

D	B	d	Z	R	$n_{min}$ - $n_{max}$	Art. Nr.
140	10	30/50	4	5	5500-9500	<b>8679.140.010</b>
	15	30/50	4	10	5500-9500	<b>8679.140.015</b>
	20	30/50	4	15	5500-9500	<b>8679.140.020</b>
	25	30/50	4	20	5500-9500	<b>8679.140.025</b>

- Ausführung für manuellen Vorschub
- Mit ziehendem Schnitt
- *for manual feed*
- *with axial angle*

8869

## HW-Nutfräser Lamello P-System „Clamex“

TC Groove Cutter Lamello P-System „Clamex“ - Tipped

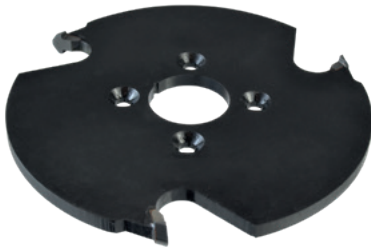
PG  
02

### HW-bestückter Nutfräser

TC-tipped groove cutter

MAN

HW

D	B	d	Z	ML/TK	Art. Nr.
100,7	7	22	3	4/6,6/48	<b>8869.100.007</b>

- Einfräsen von Nuten mit Lamello Zeta®-Maschinen. Für formschlüssige Verbindungen mit dem Lamello P-System.
- *groove cutting with Lamello Zeta® machines, designed for interlocking connections using the Lamello P-System*

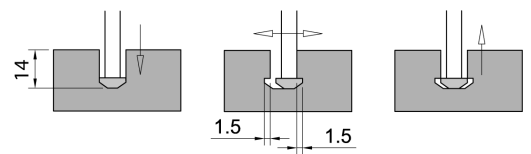
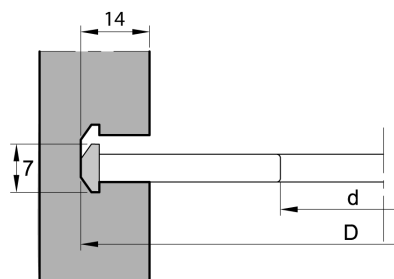

8719

**HW-Harzgallenfräser – Festbestückt**  
*TC Resin Pocket Cutter - Tipped*

PG  
02

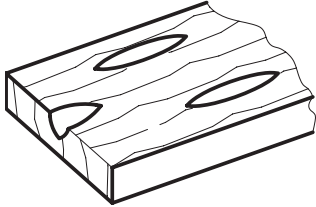

**Zum Ausfräsen von verharteten oder beschädigten Stellen mit Handmaschinen**  
*To cut out resinous or damaged areas with hand-held machines*

MAN

HW

D	B	d	Z	ML	n <sub>min</sub> - n <sub>max</sub>	Art. Nr.
100	8	22	4	4/4,3/36	7800-13300	<b>8719.100.008</b>
	15	22	4	2/4,3/36	7800-13300	<b>8719.100.015</b>

- Ausführung für manuellen Vorschub
- *for manual feed*

4189

**HW-Konkav-Konvex-Radienfräser – Wechselmesser**  
*TC Concave-Convex Radius Cutter - Replaceable Knives*

PG  
02

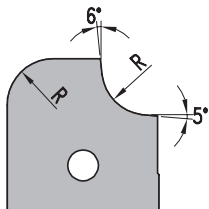
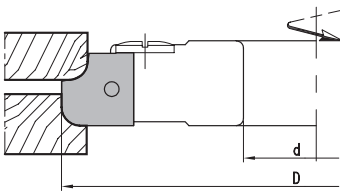

**WP-Radiusprofilfräser für verschiedene Radienprofile**  
*Radius profile cutter with replaceable knives for various radius profiles*

MAN

HW

D	B	d	Z	R	n <sub>min</sub> - n <sub>max</sub>	Art. Nr.
140	20	30/50	3	5/6/7	5500-9500	① <b>4189.140.020</b>
	25	30/50	3	8/10	5500-9500	① <b>4189.140.025</b>
	35	30/50	3	12/15	5500.9500	① <b>4189.140.035</b>

- ① Ohne Wechselmesser, bitte bestellen Sie diese separat.  
 ① *replacement knives are not included, please order them separately*
- Einseitig als Abplattfräser (gerade Abplattung) einsetzbar
- Ausführung für manuellen Vorschub
- *tool can be used as panel raising cutter (straight panel raising) one one side for manual feed*

**Wechselmesser/Ersatzteile**  
*Replacement knives/Spare parts*

	R	Dim.	Art.Nr.
Wechselmesser - Replacement knife	5	20x20x2	<b>785.766</b>
	6	20x20x2	<b>785.767</b>
	7	20x20x2	<b>785.772</b>
	8	25x25x2	<b>785.773</b>
Spannkeil - Clamping wedge	5/6/7		<b>707.002.18</b>
	8/10		<b>707.811</b>
Gewindestift - Set screw	5/6/7	M8x16	<b>705.542</b>
	8/10	M10x20	<b>705.552</b>
Sechskantschlüssel - Allen key		SW4 (M8)	<b>706.104</b>
		SW5 (M10)	<b>706.105</b>





**HW-bestückte Multi-Dübelfräser zum Fräsen glatter oder geriffelter Rundstäbe**  
*TC-tipped multi-dowel cutter for smooth or serrated dowels*

MAN

HW

D	d	n <sub>max</sub>	Art. Nr. RH	Art.Nr. LH
120-130	30(-50)	10200	<b>8114.120.102</b>	<b>8114.120.202</b>
131-140	30(-50)	9500	<b>8114.131.095</b>	<b>8114.131.195</b>
141-150	30(-50)	8900	<b>8114.141.089</b>	<b>8114.141.189</b>
151-160	30(-50)	8300	<b>8114.151.083</b>	<b>8114.151.183</b>

- Gemäß DIN 68150
- according to DIN 68150

- Ausführung mit achsparallelen Schneiden mechanischen Vorschub
- Serienartikel, kurzfristige Fertigung bei Bestellung
- with axis-parallel blades for mechanical feed
- standard product, manufactured promptly upon order

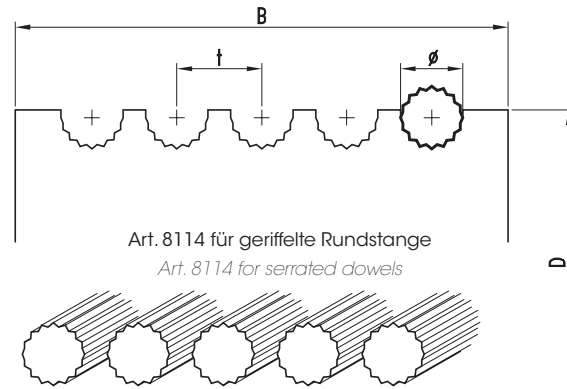
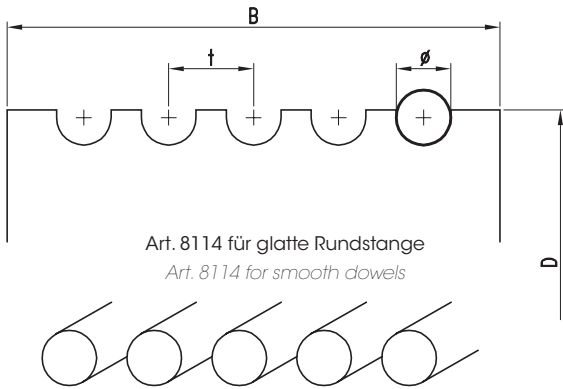

HS

	6	8	10	12	14	15	16	18	20	25
t	7	9	11	13,5	15,5	16,5	17,5	19,5	22	27
B = Schnittbreite - B = cutter width										
2	23	27	31	35,5	39,5	41,5	43,5	47,5	56	66
3	30	36	42	49	55	58	61	67	78	93
• Stabanzahl • no. of dowels	4	37	45	53	62,5	70,5	74,5	78,5	86,5	100
	5	44	54	64	76	86	91	96	106	122
	6	51	63	75	89,5	101,5	107,5	113,5	125,5	-
	7	58	72	86	103	117	124	-	-	-
	8	65	81	97	116,5	-	-	-	-	-

Berechnung für Randstegbreite 5 mm  
*calculation for edge width of 5 mm*

- Für optimale Ergebnisse sind Niederhalter erforderlich
- in order to ensure perfect machining of dowels, the use of a guide rail is recommended

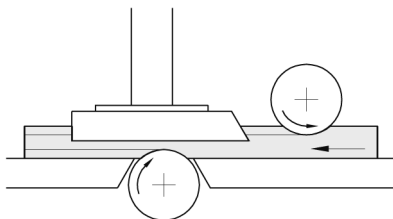

8169

**HW-Multi-Profilfräser – Festbestückt**  
 TC Multi-Profile Cutter - Tipped

PG  
02



**HW-bestückter Multiprofilfräser mit achsparallelen Schneiden**  
 TC-tipped multi-profile cutter with axis-parallel blades

MAN

HW

Nr	D	B	d	Z	n <sub>min</sub> - n <sub>max</sub>	Art.Nr.
1	120	40	30	2	6400-11100	<b>8169.120.040</b>
1	140	40	50	3	5500-9500	<b>8169.140.040</b>
2		50	50	3	5500-9500	<b>8169.140.050</b>

- Ausführung für manuellen Vorschub
- for manual feed

- Profilbeispiel
- example profile

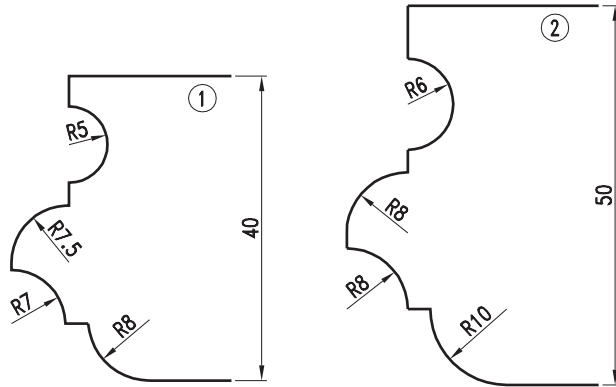

9199

**HW-Multi-Profilfräser – Wechselsmesser**  
 TC Multi-Profile Cutter - Replaceable Knives

PG  
02



**WP-Multiprofilfräser mit achsparallelen Schneiden**  
 Multi-profile cutter with replaceable knives and axis-parallel blades

MAN

HW

D	B	d	Z	n <sub>min</sub> - n <sub>max</sub>	Art.Nr.
140	50	30/50	2	5500-9500	① <b>9199.140.050</b>

- ① Ausführung mit Leichtmetall-Grundkörper
- ① featuring a light metal body
- HW-Sonderprofilmesser können bis zu ca. 3-4 Mal nachgeschärft werden
- Ausführung für manuellen Vorschub
- TC-tipped special profile knives can be resharpened approx. 3-4 times for manual feed

**Wechselsmesser/Ersatzteile**  
 Replacement knives/Spare parts

	Dim.	Art.Nr.
Wechselsmesser - Replacement knife	50x30x2	<b>785.771</b>
Spannkeil - Clamping wedge		<b>707.952</b>
Gewindestift - Set screw	M8x16	<b>705.542</b>
Sechskantschlüssel - Allen key	SW4	<b>706.104</b>

- Blanketts nach Kundenwunsch frei profilierbar
- blank knives can be profiled individually according to customer requirements

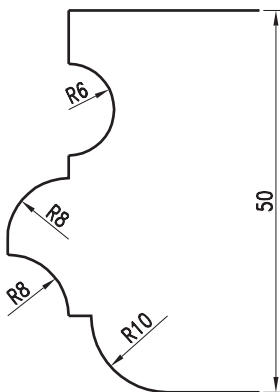

- Profilbeispiel
- example profile





**Multi-Abrundfräser mit beidseitig profilierten Wendemessern**  
*Multi-Roundingcutter with double-sided profiled turnable knives*

MAN

HW

D	B	d	Z	R	n min. - n max.	Art. Nr.
140	25	30/50	2	2/3/5	5400-8800	<b>4199.140.025</b>
180	50	30/50	2	4/6/8/10	4500-7500	<b>4199.180.050</b>

- Zum Abrunden der Kanten von Massivholz, Hartholz, furnierten beschichteten und unbeschichteten Holzwerkstoffen wie Spanplatten, Sperrholz, MDF usw.
- *For rounding edges of solid wood, hardwood, veneered coated and uncoated wood base materials such as chipboard, plywood, MDF etc.*

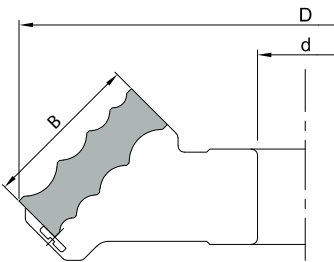

**Wendemesser/Ersatzteile**  
*Reversible knives/Spare parts*

	Dim.	R	Art. Nr.
Wendemesser - Reversible knife	25x16x2	2/3/5	<b>765.588.01</b>
	50x16x2	4/6/8/10	<b>765.588.02</b>
Spannkeil - Clamping wedge	B25	2/3/5	<b>707.588.01</b>
	B50	4/6/8/10	<b>707.588.02</b>
Gewindestift - Screw	M8x16		<b>705.542</b>
Sechskantschlüssel - T Wrench	SW4		<b>706.104</b>

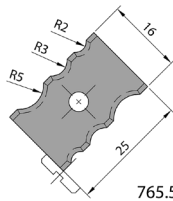
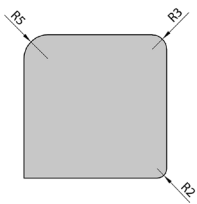

765.588.01

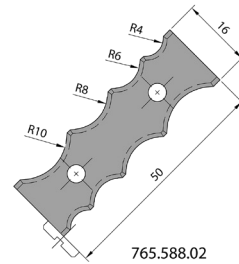
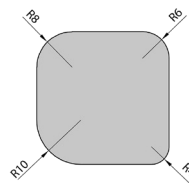

765.588.02



**Handlaufräser mit Bohrung, profiliert**  
*Handrail profilecutter with bore, profiled*

MAN

HW

Nr.	D	B	d	Z	n.min-n.max	Art.Nr.
1	150	40	30/50	3	5200-8900	<b>8689.150.040</b>
2		70	30/50	3	5200-8900	<b>8689.150.070</b>
3		55	30/50	3	5200-8900	<b>8689.150.055</b>
4	160	75	30/50	3	4800-8300	<b>8689.160.075</b>

- Serienartikel, kurzfristige Fertigung bei Bestellung
- *Standard article, short-time production after order*

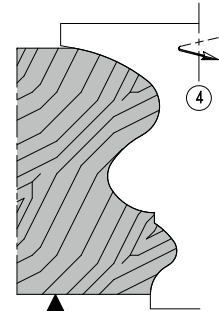
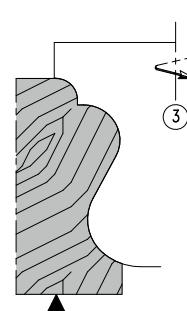
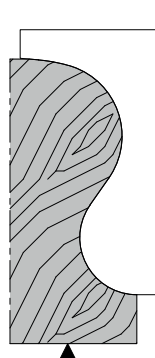
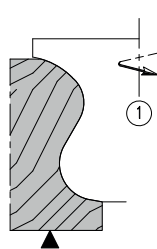

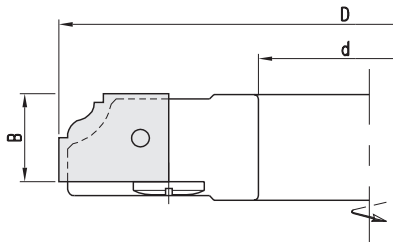

•Typ A: Standard Blankett  
 •Type A: standard blank knife

**Mit achsparallelen Schneiden zur Aufnahme von HW-Sonderprofilmessern mit Stützplatte**  
*With axis-parallel blades for holding TC-tipped special profile blades with back support plate*

**MEC**

**HW**

D	B	d	Z	n <sub>min</sub> - n <sub>max</sub>	Art.Nr. LH
140	20	50	3	9500	9114.140.020

- ① Ohne Wechselmesser, bitte bestellen Sie diese separat.
- ① *replacement knives are not included, please order them separately*
- Zur Aufnahme von HW-Sonderprofilmessern
- HW-Sonderprofilmesser können bis zu ca. 3-4 Mal nachgeschärft werden
- Ausführung für mechanischen Vorschub
- *standard product, manufactured promptly upon order*
- *TC-tipped special profile knives can be resharpened approx. 3-4 times for mechanical feed*

**Wechselmesser/Ersatzteile**  
*Replacement knives/Spare parts*

	P	Dim.	Art.Nr.
Wechselmesser - Replacement knife	1	20x25x2	785.631
	2	20x25x2	785.632
	3	20x25x2	785.633
	4	20x25x2	785.634
	5	20x25x2	785.635
	6	20x25x2	785.636
	7	20x25x2	785.637
	8	20x25x2	785.638
	9	20x25x2	785.639
	10	20x25x2	785.640
	11	20x25x2	785.641
	12	20x25x2	785.642
	13	20x25x2	785.643
	14	20x25x2	785.644
	15	20x25x2	785.645
	16	20x25x2	785.646
Spannkeil - Clamping wedge			707.090
Gewindestift - Set screw		M8x16	705.542
Sechskantschlüssel - Allen key		SW4	706.104

- Blanketts nach Kundenwunsch frei profilierbar
- *blank knives can be profiled individually according to customer requirements*

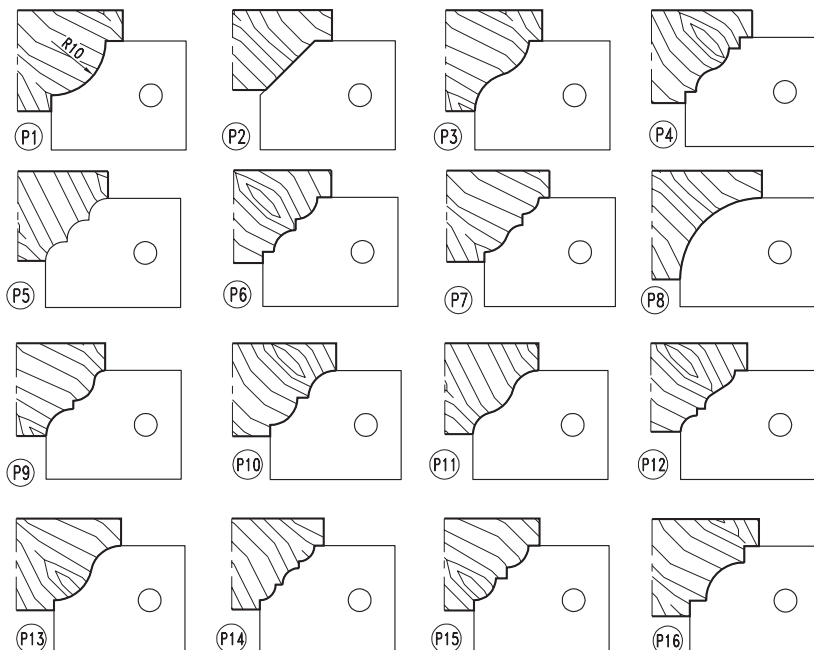

Mit achsparallelen Schneiden zur Aufnahme von HW-Sonderprofilmessern mit Stützplatte  
 With axis-parallel blades for holding TC-tipped special profile knives with back support plate

MEC

HW

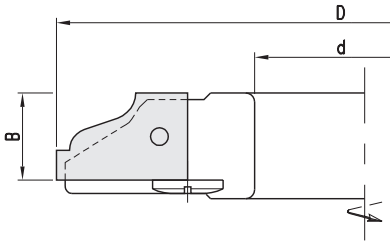

•Typ B: Standardblankett  
 •Type B: standard blank knife

D	B	d	Z	n <sub>min</sub> - n <sub>max</sub>	Art.Nr. LH
140	20	50	3	9500	4134.140.020

- ① Ohne Wechselmesser, bitte bestellen Sie diese separat.  
 ① replacement knives are not included, please order them separately
- HW-Sonderprofilmesser können bis zu ca. 3-4 Mal nachgeschärft werden  
 Ausführung für mechanischen Vorschub
- TC-tipped special profile knives can be resharpened approx. 3-4 times  
 for mechanical feed

**Wechselmesser/Ersatzteile**  
 Replacement knives/Spare parts

	P	Dim.	Art.Nr.
Wechselmesser - Replacement knife	1	20x30x2	785.651
	2	20x30x2	785.652
	3	20x30x2	785.653
	4	20x30x2	785.654
	5	20x30x2	785.655
	6	20x30x2	785.656
	7	20x30x2	785.657
	8	20x30x2	785.658
	9	20x30x2	785.659
	10	20x30x2	785.660
	11	20x30x2	785.661
	12	20x30x2	785.662
	13	20x30x2	785.663
	14	20x30x2	785.664
	15	20x30x2	785.665
	16	20x30x2	785.666
	17	20x30x2	785.667
	18	20x30x2	785.668
Spannkeil - Clamping wedge			707.086
Gewindestift - Set screw		M8x16	705.542
Sechskantschlüssel - Allen key		SW4	706.104

- Blanketts nach Kundenwunsch frei profilierbar  
 • blank knives can be profiled individually according to customer requirements

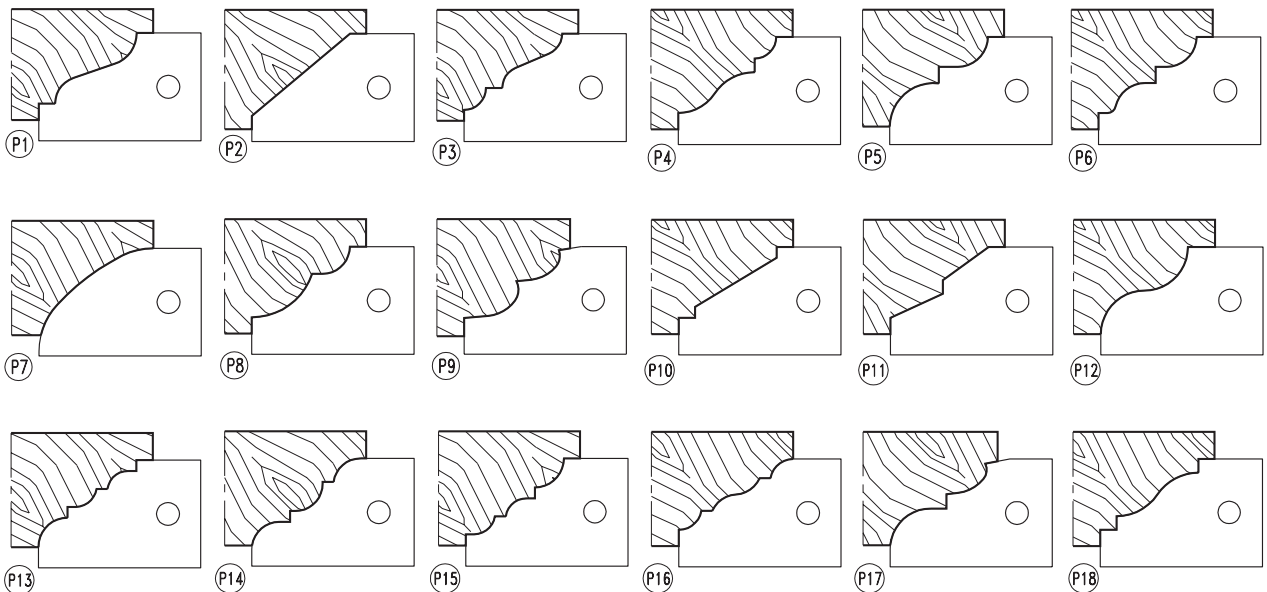

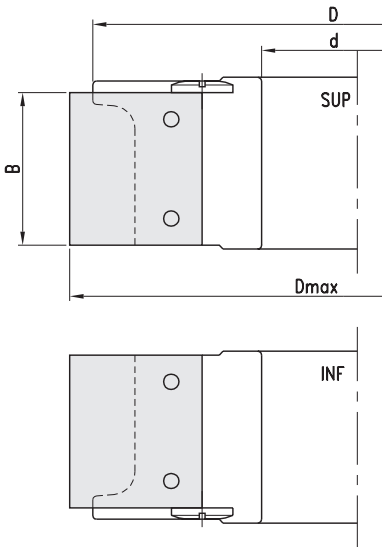

- Typ E: Standardblankett
- Type E: standard blank knife

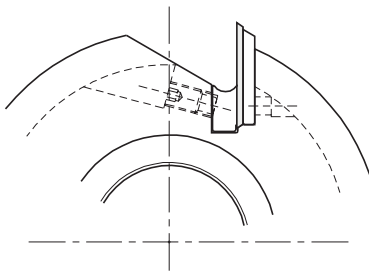

- Klemmung: Standardblankett
- clamping: standard blank knife

Mit achsparallelen Schneiden zur Aufnahme von HW-Sonderprofilmessern mit Stützplatte  
 With axis-parallel blades for holding TC-tipped special profile knives with back support plate

MEC

HW

D	B	d	Z	n <sub>min</sub> - n <sub>max</sub>	Art.Nr.
138	40	30/50	3	9000	<b>9184.138.040</b>
	50	30/50	3	9000	<b>9184.138.050</b>
	60	30/50	3	9000	<b>9184.138.060</b>

- ① Ohne Wechselmesser und Stützplatten, bitte bestellen Sie diese separat.  
*replacement knives and back support plates are not included, please order them separately*
- HW-Sonderprofilmesser können bis zu ca. 3-4 Mal nachgeschärft werden
- Ausführung für mechanischen Vorschub
- *TC-tipped special profile knives can be resharpened approx. 3-4 times for mechanical feed*

**Ersatzteile**  
*Spare parts*

	Dim.	Art.Nr.
Spannkeil - Clamping wedge	40	<b>707.300.38</b>
	50	<b>707.300.48</b>
	60	<b>707.300.58</b>
Gewindestift - Set screw	M8x16	<b>705.542</b>
Sechskantschlüssel - Allen key	SW4	<b>706.104</b>

**Wechselmesser/Ersatzteile**  
*Replacement knives/Spare parts*

	Dmax	Dim.	B	Art.Nr.
Wechselmesser - Replacement knife	140	40x30x2	40	<b>769.203</b>
		50x30x2	50	<b>769.205</b>
		60x30x2	60	<b>769.215</b>
Stützplatten - Back support plate	140	40x35x2	40	<b>769.204</b>
		50x35x2	50	<b>769.206</b>
		60x35x2	60	<b>769.208</b>
Stützplatten - Back support plate	150	38x26x3,8	40	<b>710.201</b>
		48x26x3,8	50	<b>710.202</b>
		58x26x3,8	60	<b>710.203</b>
Stützplatten - Back support plate	150	38x31x3,8	40	<b>710.210</b>
		48x31x3,8	50	<b>710.211</b>
		58x31x3,8	60	<b>710.212</b>

- Blanketts nach Kundenwunsch frei profilierbar
- *blank knives can be profiled individually according to customer requirements*

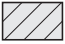

 Profilierzone (1:1)  
 available area for profiling (1:1)

- Alle Blanketts auch im System 2-Punkt-Auflage erhältlich  
 on request we supply all blank knives with 2-point support system

Typ E • type E

Typ C • type C

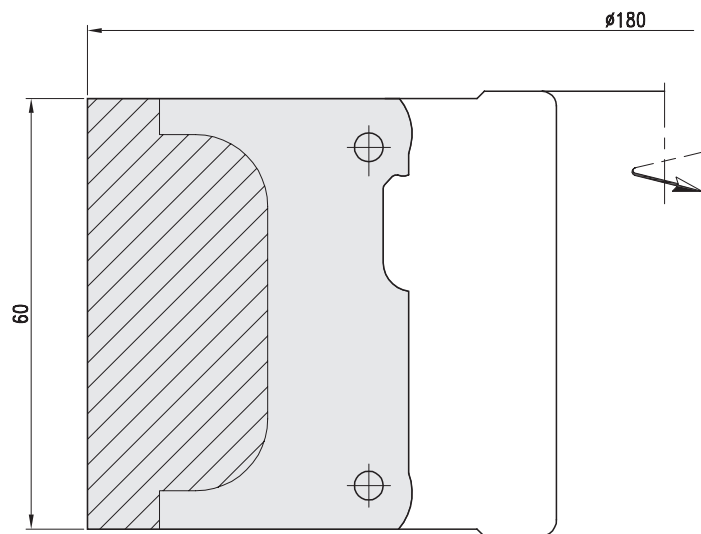
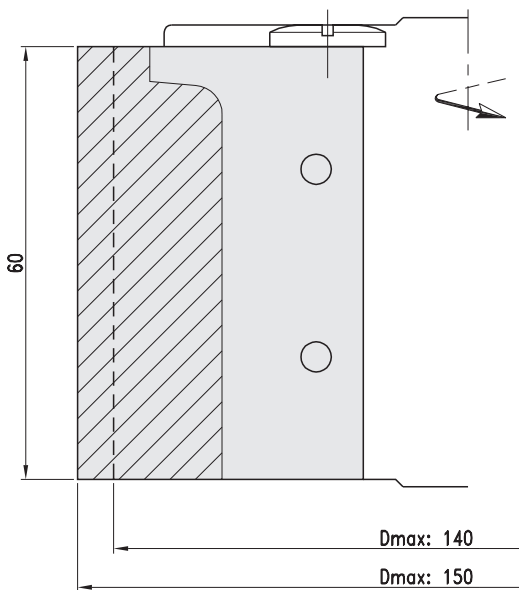
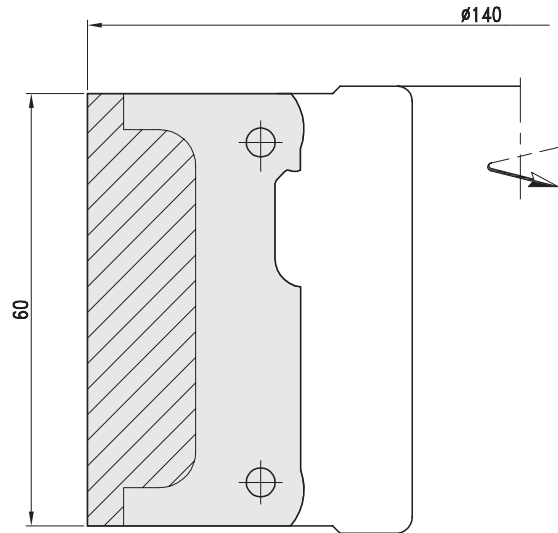
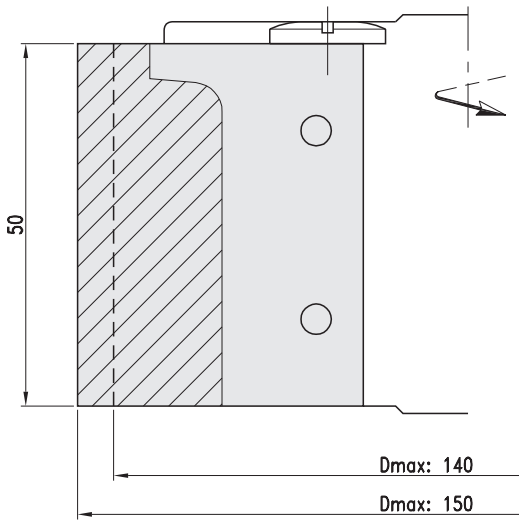
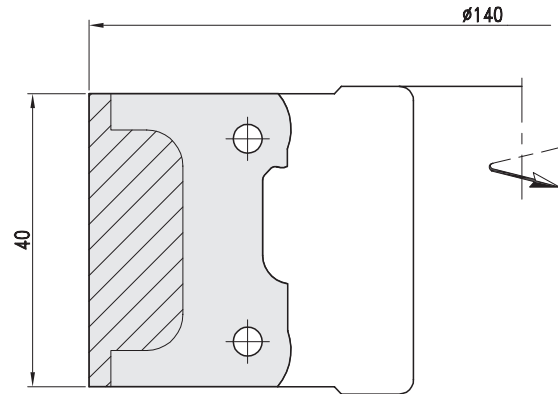
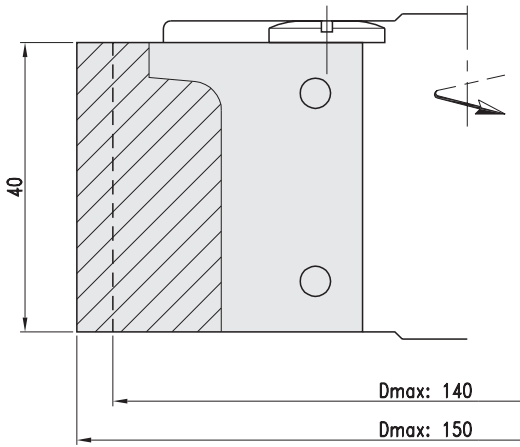

- Standardblankett  
 standard blank knife

- Blankett mit 2-Punkt Auflage  
 blank knife with 2-point support

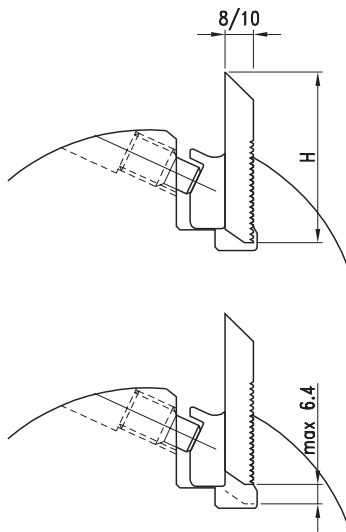

- Ohne rückenverzahnte Hobelmesser
- Cutterhead supplied without knives

H	Pt max	
	HS	HW
50	20	20
60	28	20/25*
70	38	24/35*

\*System Mikroverzahnung  
\*Microserrated system

Monoblock-Profilmesserkopf für universelles Profilieren auf Kehlmaschinen HSK85WS Schnittstelle  
Monobloc-Profilecutterhead for profiling on moulders with HSK85WS interface

**MEC**
**HW**

D	B	S	Z	n max.		Art. Nr. LH	Art.Nr. RH	
90	60	HSK85WS	2	12000	●	2412.090.060	2412.090.160	
	80	HSK85WS	2	12000	●	2412.090.080	2412.090.180	
	100	HSK85WS	2	12000	●	2412.090.100	2421.090.200	
	130	HSK85WS	2	12000	●	2412.090.130	2412.090.230	
	150	HSK85WS	2	12000	●	2412.090.150	2412.090.250	
	170	HSK85WS	2	12000	●	2412.090.170	2412.090.270	
	210	HSK85WS	2	12000	●	2412.090.210	2412.090.310	
	240	HSK85WS	2	12000	●	2412.090.240	2412.090.340	
90	60	HSK85WS	4	12000	●	2412.090.062	2412.090.162	
	80	HSK85WS	4	12000	●	2412.090.082	2412.090.182	
	100	HSK85WS	4	12000	●	2412.090.102	2412.090.202	
	130	HSK85WS	4	12000	●	2412.090.132	2412.090.232	
	170	HSK85WS	4	12000	●	2412.090.172	2412.090.272	
	240	HSK85WS	4	12000	●	2412.090.242	2412.090.342	
	115	60	HSK85WS	6	10000	●	2412.115.061	2412.115.060
		80	HSK85WS	6	10000	●	2412.115.081	2412.115.080
100		HSK85WS	6	10000	●	2412.115.101	2412.115.100	
130		HSK85WS	6	10000	●	2412.115.130	2412.115.230	
170		HSK85WS	6	10000	●	2412.115.171	2412.115.170	
240	HSK85WS	6	8000	●	2412.115.241	2412.115.240		

- Ohne rückenverzahnte Hobelmesser
- Cutterhead supplied without knives
- Bei Verwendung der Standard-Spannkeile passen RVZ-Messer der Stärken 8mm - 10mm.
- Zum Spannen von schwächeren RVZ-Messern als 8mm sind Sonder-Spannkeile zu verwenden.
- Bearbeitung abrasiver Werkstoffe durch die Verwendung des verschleißfesten HW-Massiv-Messersystems mit Mikroverzahnung. Siehe Kapitel Ersatzteile.
- The use of standard-clamping wedges of serrated knives with thickness of 8mm - 10mm. To clamp serrated knives with smaller thickness than 8mm, special clamping wedges have to be used. Machining of abrasive materials by using TC-solid knife system with micro serrations. See chapter spare parts.
- Art. 2412: Maximale Profiltiefen in Abhängigkeit der Messerhöhe H

**Ersatzteile**  
**Spare parts**

	Dim.	Art.Nr.
Ersatzteile - Spare parts	B=60	707.431
Spannkeil - Clamping wedge	B=80	707.432
	B=100	707.433
	B=130	707.435
	B=150	707.436
	B=170	707.440
	B=210	707.442
	B=240	707.443
Schraube - Screw	M10x1x20	705.552.01
T-Schlüssel - T Wrench	SW6	706.106

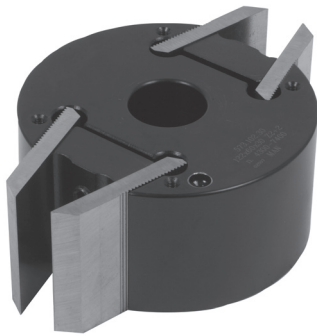
**Profilmesserkopf für rückenverzahnte Messer und Abweiser**  
*Profile cutterhead for back-serrated knives and limiters*
**MEC****HW**

D	B	d	Z	n <sub>min</sub> - n <sub>max</sub>	Art.Nr.
122	40	30/40	2+2	4300-7400	<b>2119.122.040</b>
	60	30/40	2+2	4300-7400	<b>2119.122.060</b>
	80	30/40	2+2	4300-7400	<b>2119.122.080</b>
	100	30/40	2+2	4300-7400	<b>2119.122.100</b>
137	40	50	2+2	4000-6800	<b>2119.137.040</b>
	60	50	2+2	4000-6800	<b>2119.137.060</b>
	80	50	2+2	4000-6800	<b>2119.137.080</b>
	100	50	2+2	4000-6800	<b>2119.137.100</b>

- ① Ohne RVZ-Messer
- ① *back-serrated knives are not included*

- Präzise Schnittqualität dank 60° Messer für maximale Spannkraft. Große Auswahl an hochwertigen Schneidstoffen, die perfekt abgestimmt sind auf jedes Werkstückmaterial.
- *Precise cutting performance thanks to 60° serrated-back knives providing maximum clamping force. Wide range of premium cutting materials that are perfectly matched to every type of work-piece material.*

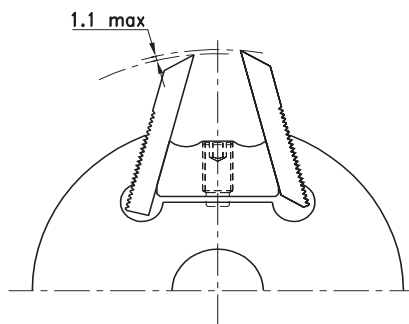
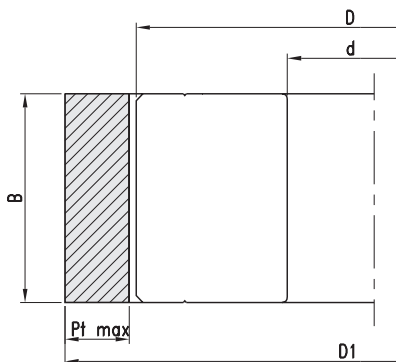
**Ersatzteile**  
*Spare parts*

	Dim.	Art.Nr.
Spannkeil - Clamping wedge	40	<b>707.853.40</b>
	60	<b>707.853.60</b>
	80	<b>707.853.80</b>
	100	<b>707.853.100</b>
Gewindestift - Set screw	M12x20	<b>705.556</b>
Sechskantschlüssel - Allen key	SW6	<b>706.106</b>

- Bei Verwendung der Standard-Spannkeile passen RVZ-Messer mit einer Stärke von 8 mm bis 10 mm
- Zum Spannen von schwächeren RVZ-Messern sind Sonder-Spannkeile zu verwenden
- Die Bearbeitung abrasiver Werkstoffe erfolgt durch die Verwendung des verschleißfesten HW-Massiv-Messersystems mit Mikroverzahnung. Siehe Kapitel 10: Ersatzteile.
- *for using standard clamping wedges, back-serrated knives with a thickness of 8 mm to 10 mm are suitable*
- *for clamping thinner back-serrated knives, special clamping wedges must be used*
- *for machining abrasive materials, a wear-resistant TC solid-blade system with micro-gearing is used, see Chapter 10: Spare Parts*

Art. 2119:

Flugkreisdurchmesser, max. Profiltiefe (Pt<sub>max</sub>) in Abhängigkeit von Fräserdurchmesser D und Messerhöhe H

*cutting circle diameter, maximum profile depth (Pt<sub>max</sub>) depending on cutter diameter D and knife height H*

H	D1		Pt <sub>max</sub>	
	D 122	D 137	HS	HW
50	155	170	12	11/12*
60	175	190	20	17/20*

\* System Mikroverzahnung

\* *micro-serrated system*

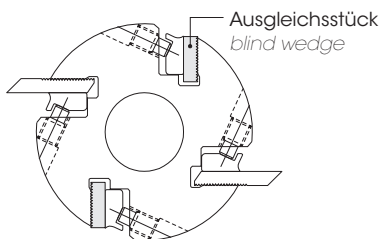
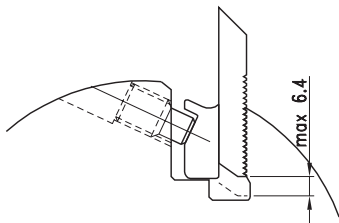
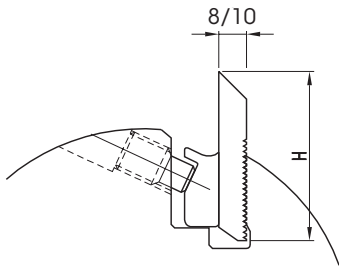
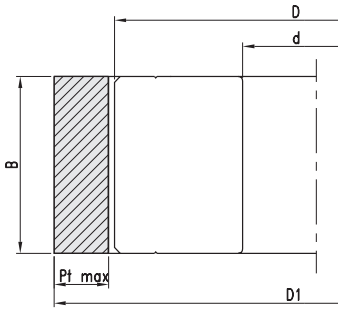
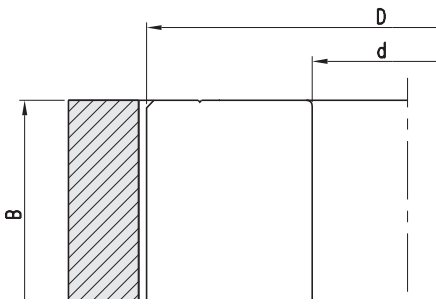

Art. 2114:  
Flugkreisdurchmesser, max. Profiltiefe (Pt<sub>max</sub>)  
in Abhängigkeit von Fräserdurchmesser D  
und Messerhöhe H  
cutting circle diameter, maximum profile depth  
(Pt<sub>max</sub>) depending on cutter diameter D and  
knife height H

**Profilmesserkopf für rückenverzahnte Messer und Abweiser**  
Profile cutterhead for back-serrated knives and limiters

MEC

HW

D	B	d	Z	n <sub>max</sub>	Art.Nr.
122	40	40	2	9000	2114.122.040
	60	40	2	9000	2114.122.060
	80	40	2	9000	2114.122.080
122	40	40	4	9000	2114.122.140
	60	40	4	9000	2114.122.160
	80	40	4	9000	2114.122.180
	100	40	4	9000	2114.122.100
	130	40	4	9000	2114.122.130
	150	40	4	9000	2114.122.150
	180	40	4	9000	2114.122.280
	230	40	4	9000	2114.122.230
137	40	50	4	9000	2114.137.040
	60	50	4	9000	2114.137.060
	80	50	4	9000	2114.137.080
	100	50	4	9000	2114.137.100
	130	50	4	9000	2114.137.130
	150	50	4	9000	2114.137.150
	180	50	4	9000	2114.137.180
	230	50	4	9000	2114.137.230

- ① Ohne RVZ-Messer  
① back-serrated knives are not included
- Präzise Schnittqualität dank 60° Messer für maximale Spannkraft. Große Auswahl an hochwertigen Schneidstoffen, die perfekt abgestimmt sind auf jedes Werkstückmaterial.
- Precise cutting performance thanks to 60° serrated-back knives providing maximum clamping force. Wide range of premium cutting materials that are perfectly matched to every type of work-piece material.

**Ersatzteile**  
Spare parts

	Dim.	Art.Nr.
Spannkeil - Clamping wedge	40	707.430
	60	707.431
	80	707.432
	100	707.433
	130	707.435
	150	707.436
	180	707.437
	230	707.439
Ausgleichsstück - Blind wedge	40	707.330
	60	707.331
	80	707.332
	100	707.333
	130	707.334
	150	707.335
	180	707.336
	230	707.337
Gewindestift - Set screw	M12x20	705.556
	M10x20	705.552
Sechskantschlüssel - Allen key	SW6	706.106

H	D1		Pt <sub>max</sub>	
	D 122	D 137	HS	HW
50	160	175	15	11/15*
60	179	194	25	17/25*
70	198	214	35	20/35*

\* System Mikroverzahnung  
\* micro-serrated system

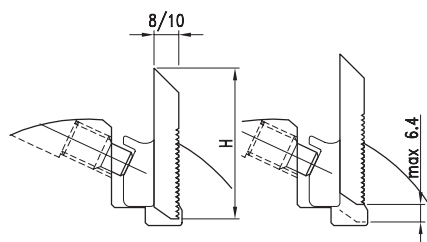
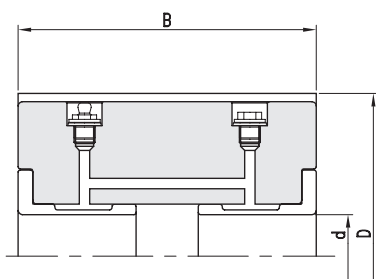

H	D1				P <sub>i</sub> max	
	D137	D150	D163	D190	HS	HW
50	175	188	200	228	15	11/15*
60	194	207	219	247	25	17/25*
70	214	227	239	266	35	20/35*

\* System Mikroverzahnung

\* micro-serrated system

**Hydro-Profilmesserkopf für rückenverzahnte Messer**  
*Hydro profile cutterhead for back-serrated knives*
**MEC**
**HW**

D	B	d	Z	n <sub>max</sub>	Art.Nr.	
137	60	40	4	9000	<b>2111.137.060</b>	
	100	40	4	9000	<b>2111.137.100</b>	
	130	40	4	9000	<b>2111.137.130</b>	
	150	40	4	9000	<b>2111.137.150</b>	
150	60	50	4	8000	<b>2111.150.060</b>	
	100	50	4	8000	<b>2111.150.100</b>	
	130	50	4	8000	<b>2111.150.130</b>	
	150	50	4	8000	<b>2111.150.150</b>	
	180	50	4	8000	<b>2111.150.180</b>	
150	60	50	6	8000	<b>2111.150.061</b>	
	100	50	6	8000	<b>2111.150.101</b>	
	130	50	6	8000	<b>2111.150.131</b>	
	150	50	6	8000	<b>2111.150.151</b>	
	180	50	6	8000	<b>2111.150.181</b>	
230	60	50	6	8000	<b>2111.150.231</b>	
	100	50	8	6000	<b>2111.163.060</b>	
	130	50	8	6000	<b>2111.163.130</b>	
	150	50	8	6000	<b>2111.163.150</b>	
	180	50	8	6000	<b>2111.163.180</b>	
230	60	50	8	6000	<b>2111.163.230</b>	
	190	60	50	12	6000	<b>2111.190.060</b>
	80	50	12	6000	<b>2111.190.080</b>	
	100	50	12	6000	<b>2111.190.100</b>	
	130	50	12	6000	<b>2111.190.130</b>	
150	60	50	12	6000	<b>2111.190.150</b>	
	180	50	12	6000	<b>2111.190.180</b>	
	230	50	12	6000	<b>2111.190.230</b>	

① Ohne RVZ-Messer

① *back-serrated knives are not included*

- Messerkopf aus Stahl mit offenem Hydrospannsystem
- Hydrosystem als Zentrier-Spannsystem bei Betriebsdruck von ca. 300-400 bar (tägliche Kontrolle empfohlen)
- Ausführung für mechanischen Vorschub
- *steel-cutterhead with integrated, open hydro-clamping system for grease gun*
- *hydro-clamping system as central clamping system at an operating pressure of approx. 300 to 400 bar (daily checks recommended)*
- *for mechanical feed*

**Ersatzteile**
*Spare parts*

	Dim.	Art.Nr.
Spannkeil - Clamping wedge	60	<b>707.431</b>
	100	<b>707.433</b>
	130	<b>707.435</b>
	150	<b>707.436</b>
	180	<b>707.437</b>
Ausgleichsstück - Blind wedge	230	<b>707.439</b>
	60	<b>707.331</b>
	100	<b>707.333</b>
	130	<b>707.334</b>
	150	<b>707.335</b>
Gewindestift - Set screw	180	<b>707.336</b>
	230	<b>707.337</b>
Sechskantschlüssel - Allen key	M12x20	<b>705.556</b>
Fettpresse - Grease gun	SW6	<b>706.106</b>
Fettkartusche - Grease cartridge		<b>724.401</b>
Sicherheits-Klemmring für Maschinenspindel - Safety ring		<b>724.402</b>
		<b>724.404</b>

**2184**  
**2189**

**SP-Universal-Profilmesserkopf – Wechselsmesser**  
*SP Universal Profile Cutterhead - Replaceable Knives*

**PG**  
**02**

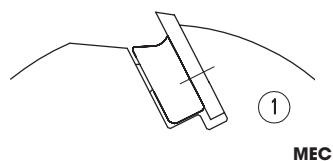

**MEC**

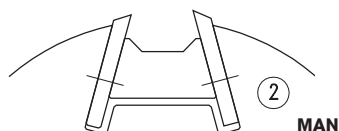

**MAN**

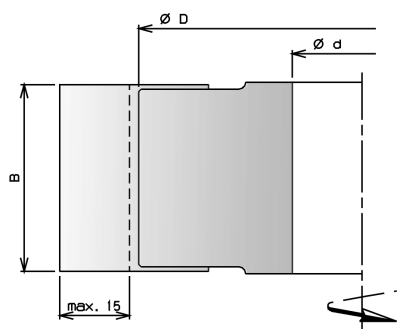

- Sondermesser und Abweiser auf Anfrage
- special knives and limiters available upon request

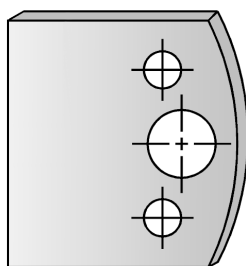

**778.000 / 778.001**

**Typ 1 Universal-Profilmesserkopf mit Stahlgrundkörper für 40 mm breite Profilmesser**  
*Type 1 universal profile cutterhead with steel support body for 40 mm wide profile knives*

**MEC**

**HW**

D	B	d	Z	Messer	n <sub>max</sub>	Art.Nr.
Mit 2 Falzmessern - With two rebate knives						
100	40	30	2		9000	<b>2184.100.040</b>
120	40	50	2		9000	<b>2184.120.040</b>
Kompletter Messersatz mit Holzkiste - Complete set of knives with wooden box						
100	40	30	2	1-6	9000	<b>2184.100.140</b>
	40	30	2	1-12	9000	<b>2184.100.240</b>
	40	30	2	9/12/14/15/19/36	9000	<b>2184.100.340</b>
120	40	50	2	1-6	9000	<b>2184.120.140</b>
	40	50	2	1-12	9000	<b>2184.120.240</b>
	40	50	2	9/12/14/15/19/36	9000	<b>2184.120.340</b>

- Große Auswahl an diversen hochwertigen Standardprofilen
- Ausführung für mechanischen Vorschub
- wide range of various premium standard profiles
- for mechanical feed

**Typ 2 Universal-Profilmesserkopf mit Stahlgrundkörper für 40 mm breite Profilmesser und Abweiser**  
*Type 2 universal profile cutterhead with steel support body for 40 mm wide profile knives and limiters*

**MAN**

**HW**

D	B	d	Z	Messer	n <sub>max</sub>	Art.Nr.
Mit 2 Falzmessern - With two rebate knives						
100	40	30	2		6000-9000	<b>2189.100.040</b>
120	40	50	2		6000-9000	<b>2189.120.040</b>
Kompletter Messersatz mit Holzkiste - Complete set of knives with wooden box						
100	40	30	2	1-6	6000-9000	<b>2189.100.140</b>
	40	30	2	1-12	6000-9000	<b>2189.100.240</b>
	40	30	2	9/12/14/15/19/36	6000-9000	<b>2189.100.340</b>
120	40	50	2	1-6	6000-9000	<b>2189.120.140</b>
	40	50	2	1-12	6000-9000	<b>2189.120.240</b>
	40	50	2	9/12/14/15/19/36	6000-9000	<b>2189.120.340</b>

- Große Auswahl an diversen hochwertigen Standardprofilen
- Ausführung für manuellen Vorschub
- wide range of various premium standard profiles
- for manual feed

**Ersatzteile**  
*Spare parts*

	Nr.	Dim.	Art.Nr.
Spannkeil - Clamping wedge	1		<b>707.850</b>
	2		<b>707.851</b>
Gewindestift - Set screw	1	M10x20	<b>705.552</b>
	2	M10x16	<b>705.551</b>
Sechskantschlüssel - Allen key		SW5	<b>706.105</b>
Messerrohling B=40 - Knife for profiling B=40			<b>778.000</b>
Abweiser-Rohling B=40 - Limiter for profiling B=40			<b>778.001</b>



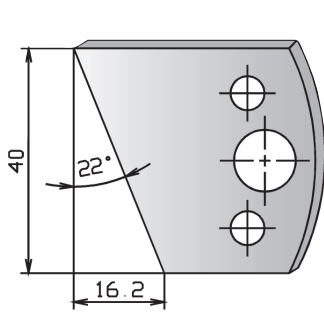

**Art.Nr.**  
Profilmesser - profile knives **778.101**  
Abweiser - limiters **778.201**

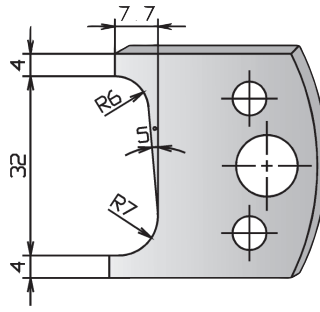

**Art.Nr.**  
**778.102**  
**778.202**

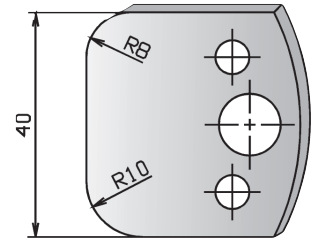

**Art.Nr.**  
**778.103**  
**778.203**

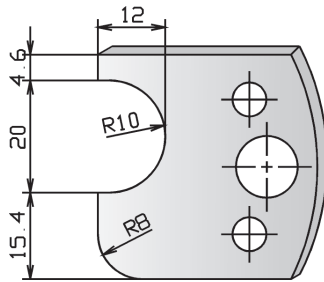

**Art.Nr.**  
Profilmesser - profile knives **778.104**  
Abweiser - limiters **778.204**

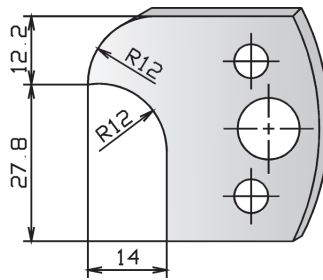

**Art.Nr.**  
**778.105**  
**778.205**

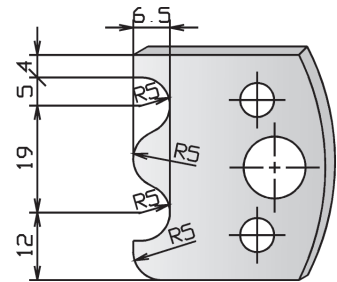

**Art.Nr.**  
**778.106**  
**778.206**

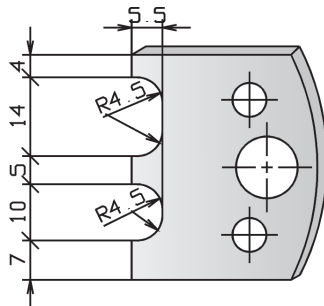

**Art.Nr.**  
Profilmesser - profile knives **778.107**  
Abweiser - limiters **778.207**

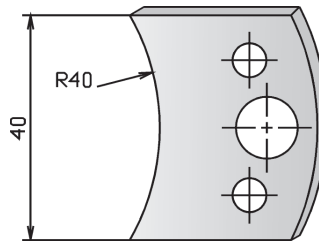

**Art.Nr.**  
**778.108**  
**778.208**

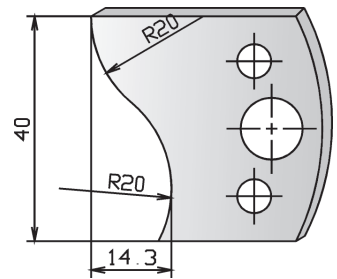

**Art.Nr.**  
**778.109**  
**778.209**

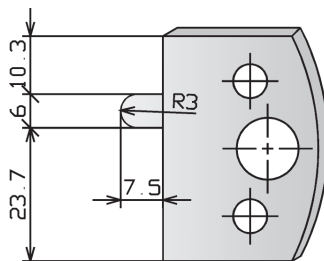

**Art.Nr.**  
Profilmesser - profile knives **778.110**  
Abweiser - limiters **778.210**

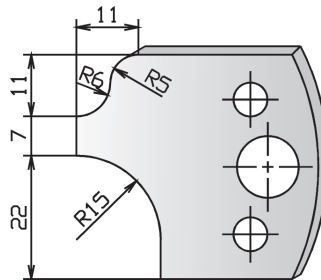

**Art.Nr.**  
**778.111**  
**778.211**

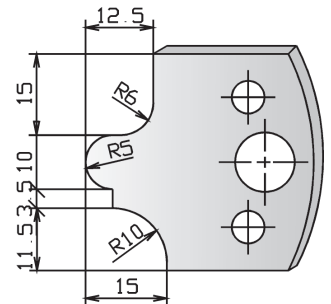

**Art.Nr.**  
**778.112**  
**778.212**

**2184**  
**2189**

**SP-Universal-Profilmesserkopf – Profilmesserauswahl**  
**SP Universal Profile Cutterhead - Selection of Profile Knives**

**PG**  
**02**

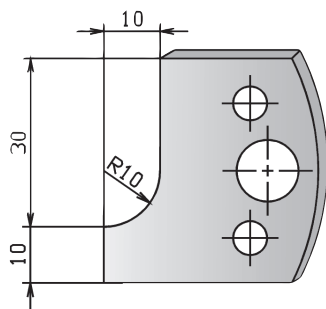

**Art.Nr.**  
**Profilmesser - profile knives 778.113**  
**Abweiser - limiters 778.213**

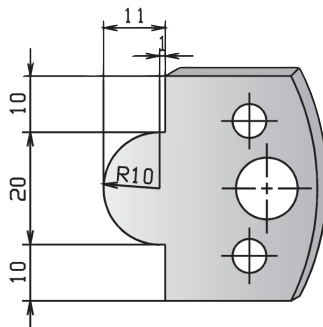

**Art.Nr.**  
**778.114**  
**778.214**

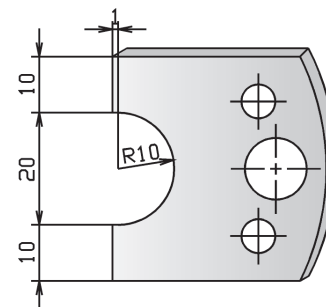

**Art.Nr.**  
**778.115**  
**778.215**

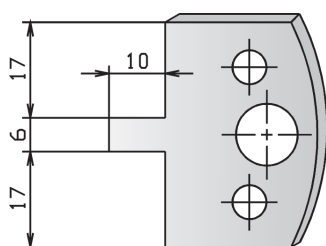

**Art.Nr.**  
**Profilmesser - profile knives 778.116**  
**Abweiser - limiters 778.216**

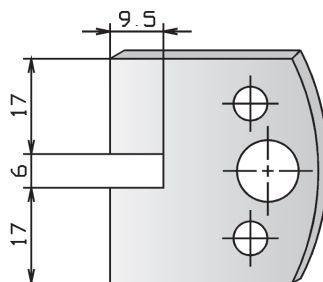

**Art.Nr.**  
**778.117**  
**778.217**

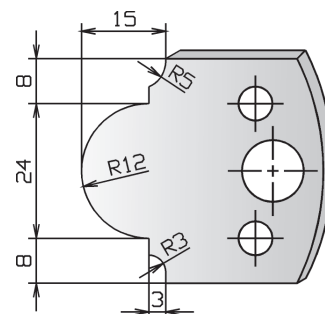

**Art.Nr.**  
**778.118**  
**778.218**

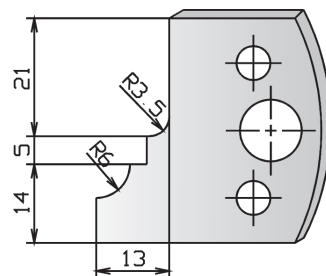

**Art.Nr.**  
**Profilmesser - profile knives 778.119**  
**Abweiser - limiters 778.219**

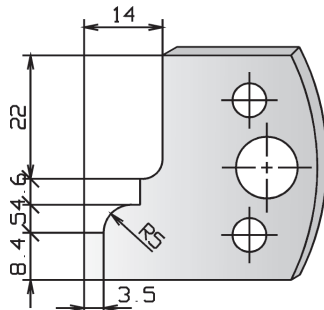

**Art.Nr.**  
**778.120**  
**778.220**

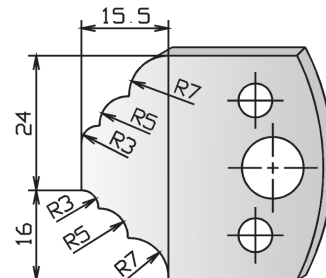

**Art.Nr.**  
**778.121**  
**778.221**

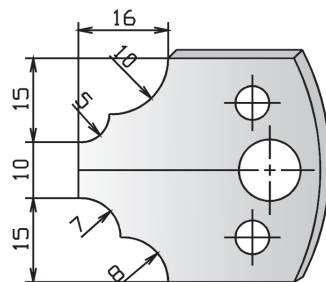

**Art.Nr.**  
**Profilmesser - profile knives 778.122**  
**Abweiser - limiters 778.222**

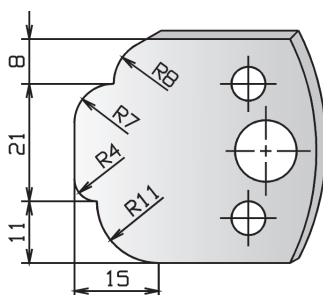

**Art.Nr.**  
**778.123**  
**778.223**

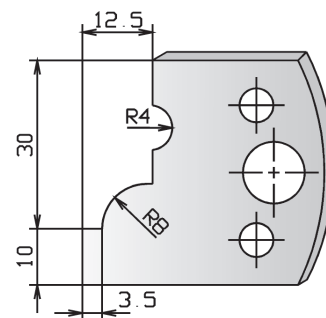

**Art.Nr.**  
**778.124**  
**778.224**



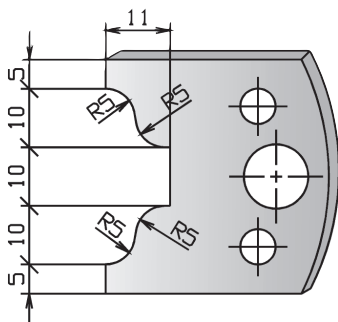

**Art.Nr.**  
Profilmesser - profile knives **778.125**  
Abweiser - limiters **778.225**

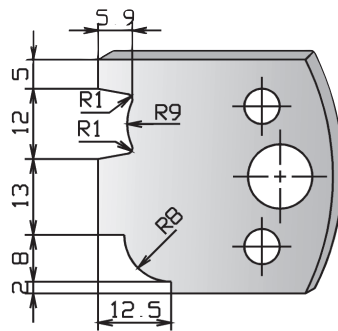

**Art.Nr.**  
778.126  
778.226

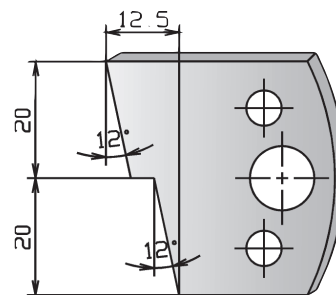

**Art.Nr.**  
778.127  
778.227

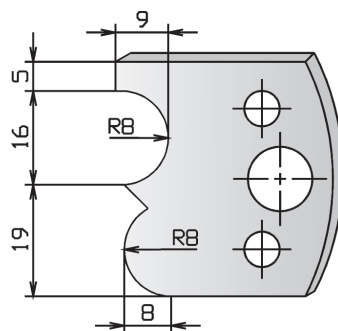

**Art.Nr.**  
Profilmesser - profile knives **778.128**  
Abweiser - limiters **778.228**

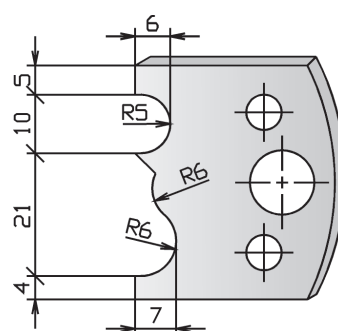

**Art.Nr.**  
778.129  
778.129

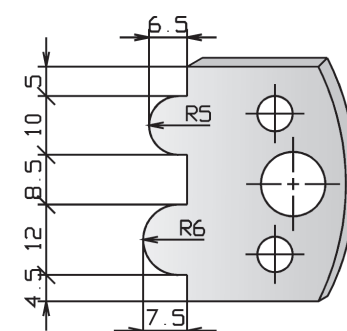

**Art.Nr.**  
778.130  
778.230

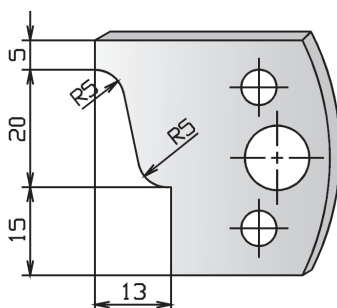

**Art.Nr.**  
Profilmesser - profile knives **778.131**  
Abweiser - limiters **778.231**

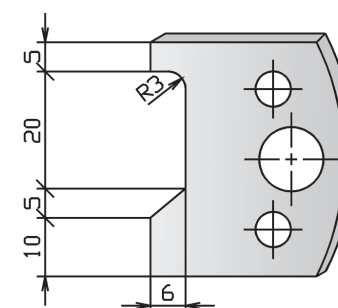

**Art.Nr.**  
778.132  
778.232

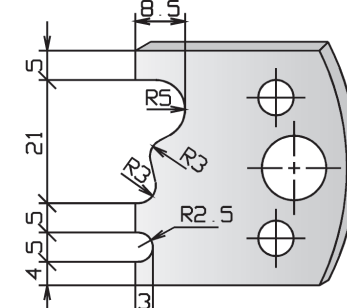

**Art.Nr.**  
778.133  
778.233

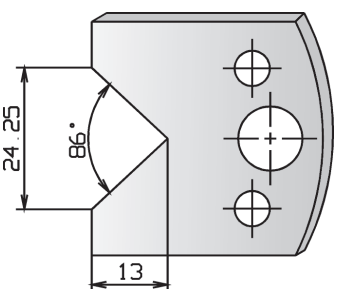

**Art.Nr.**  
Profilmesser - profile knives **778.134**  
Abweiser - limiters **778.234**

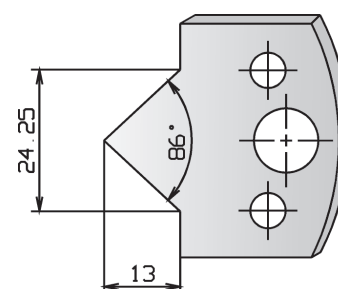

**Art.Nr.**  
778.135  
778.235

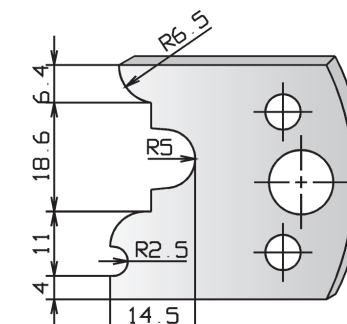

**Art.Nr.**  
778.136  
778.236

**2184**  
**2189**

**SP-Universal-Profilmesserkopf - Profilmesserauswahl**  
*SP Universal Profile Cutterhead - Selection of Profile Knives*

**PG**  
**02**

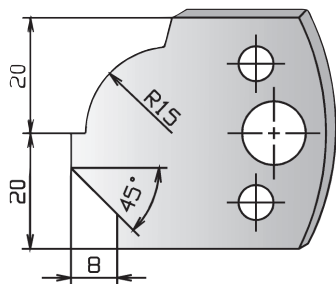

**Art.Nr.**  
**778.137**  
Profilmesser - profile knives  
Abweiser - limiters

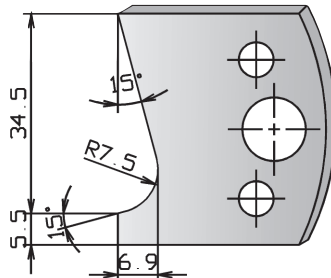

**Art.Nr.**  
**778.138**  
**778.238**

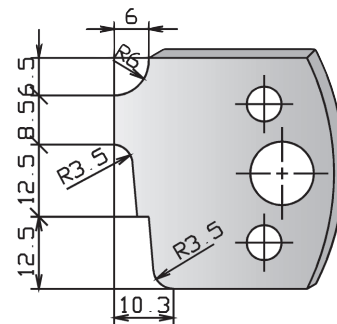

**Art.Nr.**  
**778.139**  
**778.239**

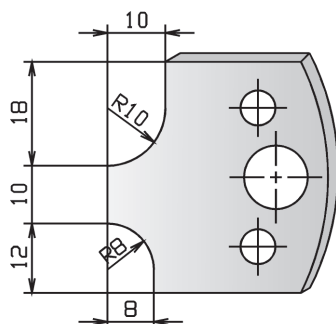

**Art.Nr.**  
**778.140**  
Profilmesser - profile knives  
Abweiser - limiters

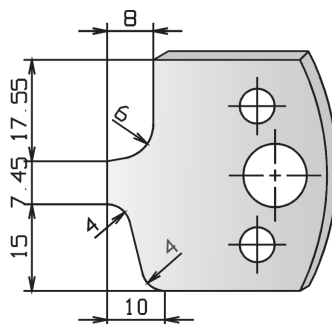

**Art.Nr.**  
**778.141**  
**778.241**

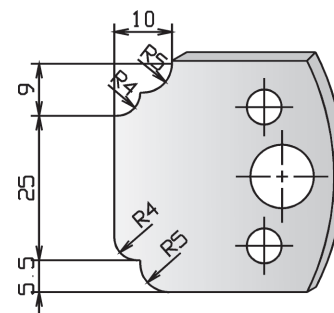

**Art.Nr.**  
**778.142**  
**778.242**

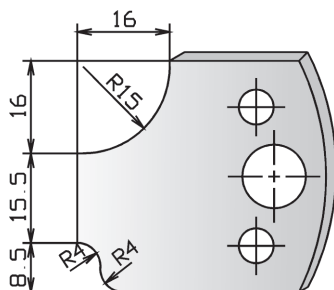

**Art.Nr.**  
**778.143**  
Profilmesser - profile knives  
Abweiser - limiters

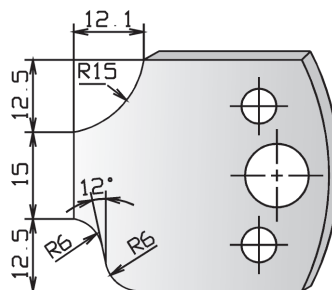

**Art.Nr.**  
**778.144**  
**778.244**

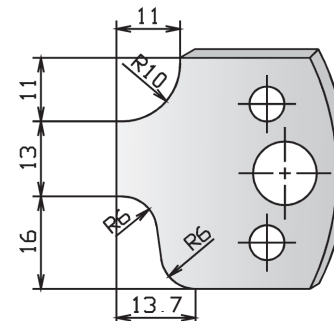

**Art.Nr.**  
**778.145**  
**778.245**

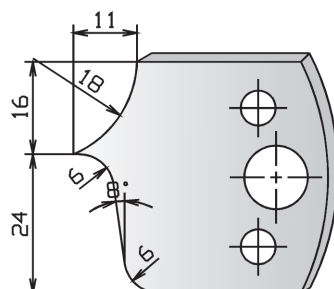

**Art.Nr.**  
**778.146**  
Profilmesser - profile knives  
Abweiser - limiters

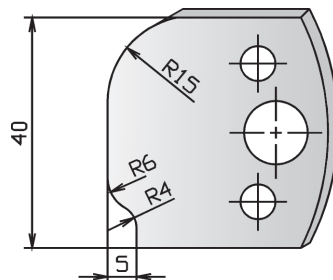

**Art.Nr.**  
**778.147**  
**778.247**

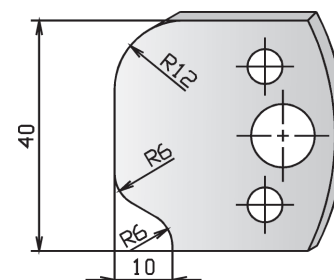

**Art.Nr.**  
**778.148**  
**778.248**



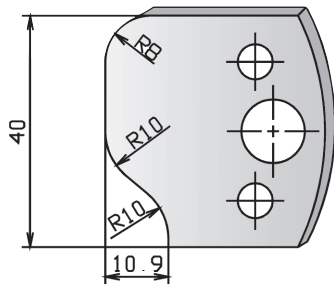

**Art.Nr.**  
Profilmesser - profile knives **778.149**  
Abweiser - limiters **778.249**

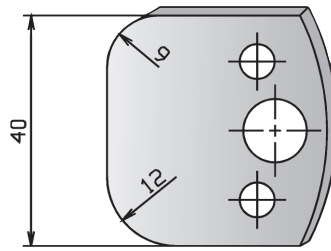

**Art.Nr.**  
778.150  
778.250

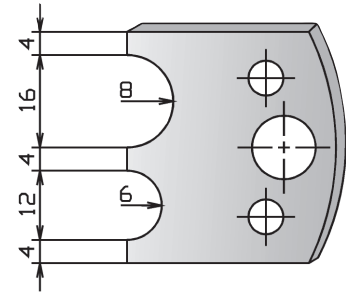

**Art.Nr.**  
778.151  
778.251

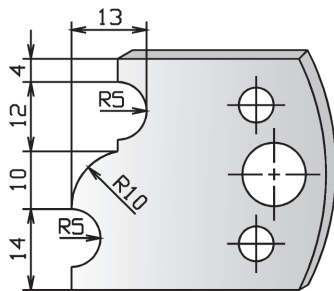

**Art.Nr.**  
Profilmesser - profile knives **778.152**  
Abweiser - limiters **778.252**

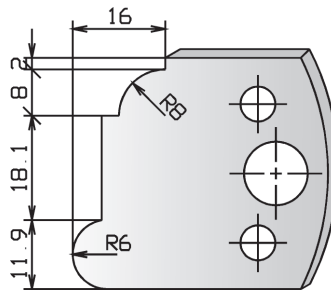

**Art.Nr.**  
778.153  
778.253

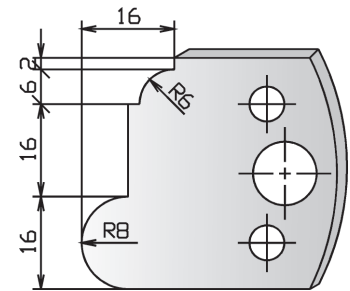

**Art.Nr.**  
778.154  
778.254

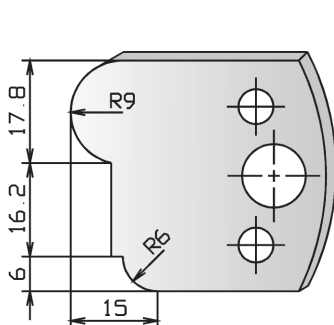

**Art.Nr.**  
Profilmesser - profile knives **778.155**  
Abweiser - limiters **778.255**

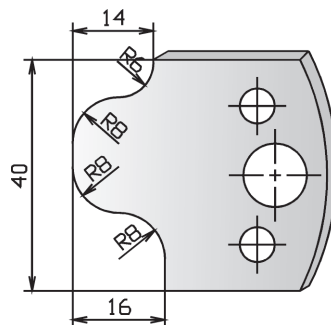

**Art.Nr.**  
778.156  
778.256

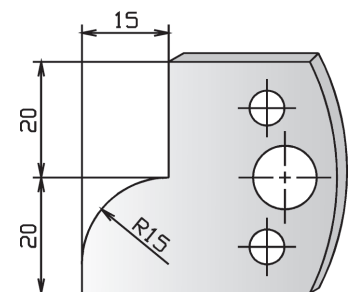

**Art.Nr.**  
778.157  
778.257

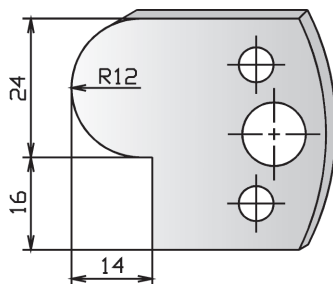

**Art.Nr.**  
Profilmesser - profile knives **778.158**  
Abweiser - limiters **778.258**

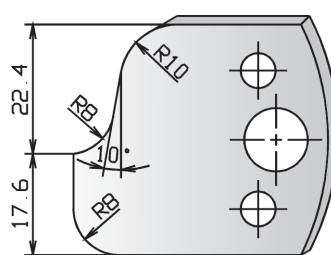

**Art.Nr.**  
778.159  
778.259

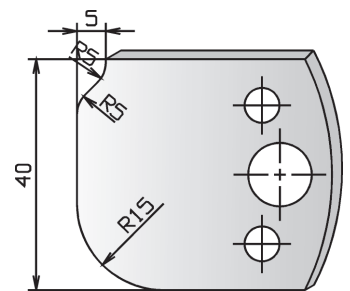

**Art.Nr.**  
778.160  
778.260

**2184**  
**2189**

**SP-Universal-Profilmesserkopf - Profilmesserauswahl**  
*SP Universal Profile Cutterhead - Selection of Profile Knives*

**PG**  
**02**

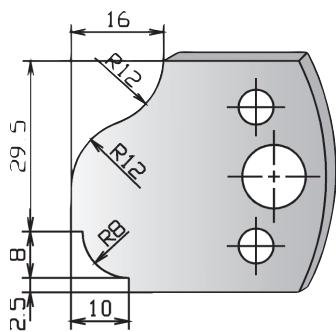

**Art.Nr.**  
**778.161**  
Profilmesser - profile knives  
Abweiser - limiters

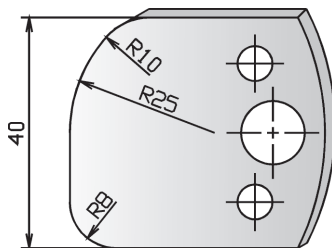

**Art.Nr.**  
**778.162**  
778.262

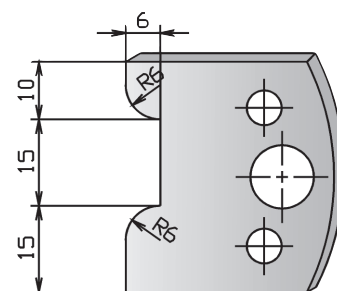

**Art.Nr.**  
**778.163**  
778.263

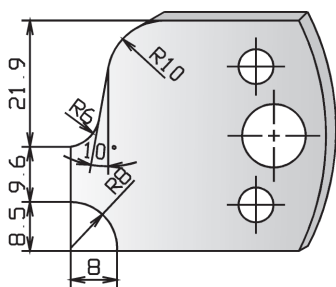

**Art.Nr.**  
**778.164**  
Profilmesser - profile knives  
Abweiser - limiters

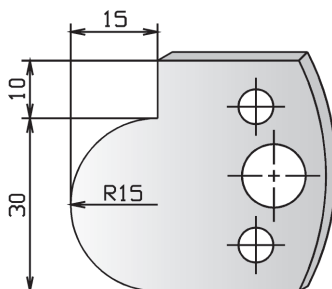

**Art.Nr.**  
**778.165**  
778.265

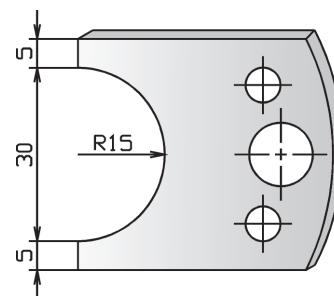

**Art.Nr.**  
**778.166**  
778.266

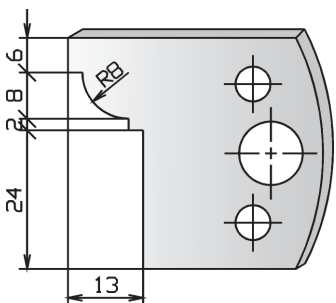

**Art.Nr.**  
**778.167**  
Profilmesser - profile knives  
Abweiser - limiters

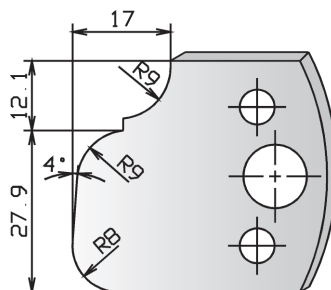

**Art.Nr.**  
**778.168**  
778.268

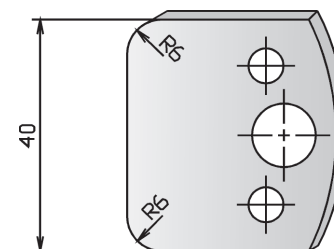

**Art.Nr.**  
**778.169**  
778.269

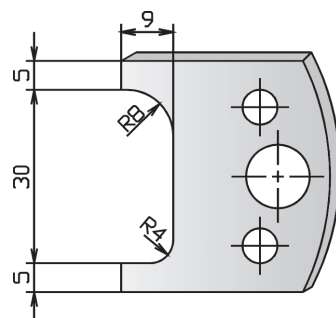

**Art.Nr.**  
**778.170**  
Profilmesser - profile knives  
Abweiser - limiters

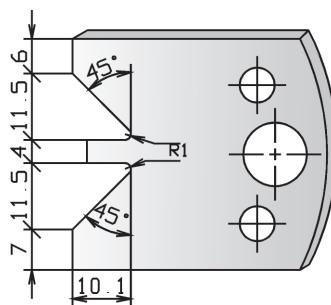

**Art.Nr.**  
**778.171**  
778.271

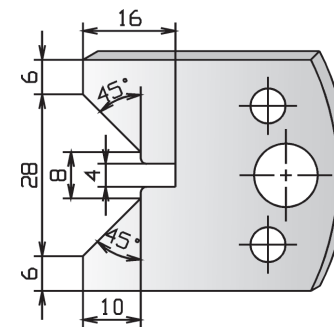

**Art.Nr.**  
**778.172**  
778.272





**2184**  
**2189**

**SP-Universal-Profilmesserkopf – Profilmesserauswahl**  
*SP Universal Profile Cutterhead - Selection of Profile Knives*

**PG**  
**02**

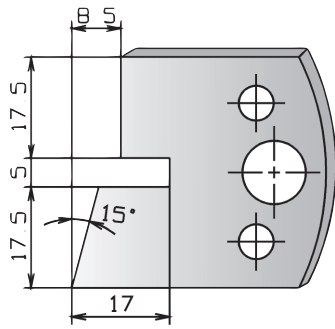

**Art.Nr.**  
**778.185**  
Profilmesser - profile knives  
Abweiser - limiters

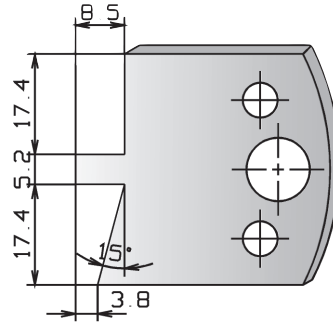

**Art.Nr.**  
**778.186**  
**778.286**

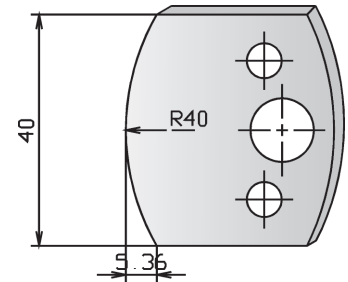

**Art.Nr.**  
**778.187**  
**778.287**

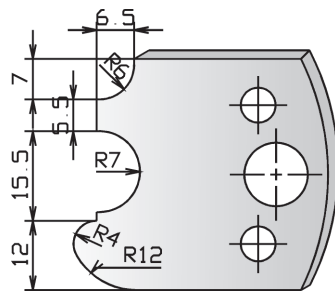

**Art.Nr.**  
**778.188**  
Profilmesser - profile knives  
Abweiser - limiters

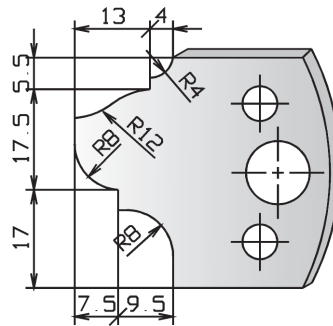

**Art.Nr.**  
**778.189**  
**778.289**

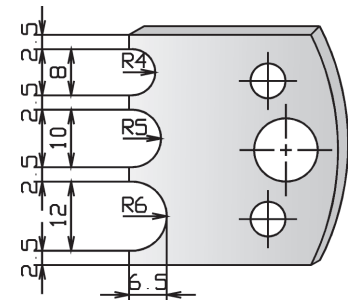

**Art.Nr.**  
**778.190**  
**778.290**

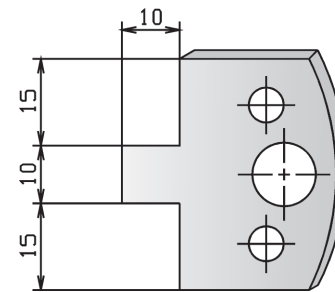

**Art.Nr.**  
**778.191**  
Profilmesser - profile knives  
Abweiser - limiters

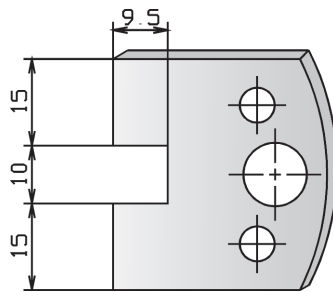

**Art.Nr.**  
**778.192**  
**778.292**

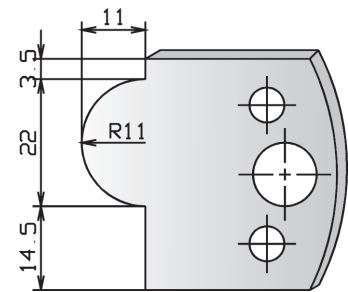

**Art.Nr.**  
**778.193**  
**778.293**

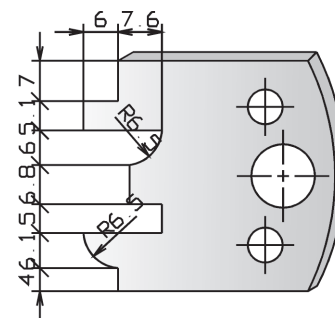

**Art.Nr.**  
**778.194**  
Profilmesser - profile knives  
Abweiser - limiters

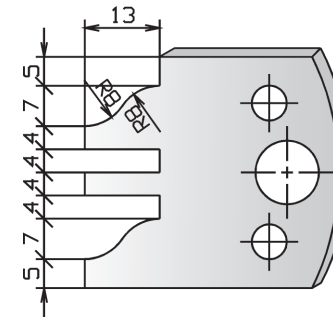

**Art.Nr.**  
**778.195**  
**778.295**

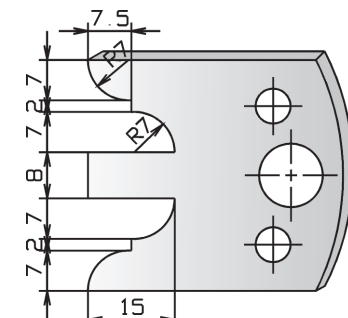

**Art.Nr.**  
**778.196**  
**778.296**





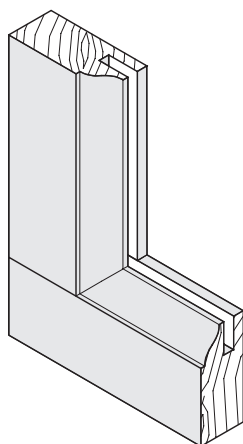
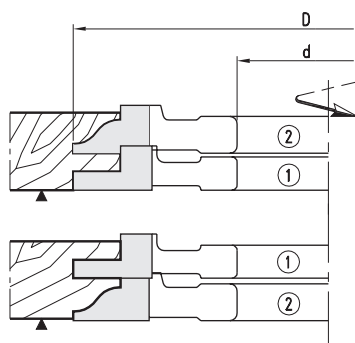

- HW-Profilmesserkopf mit Stahlgrundkörper zum Fräsen von Profilen und Konterprofilen an Massivholz-Rahmentüren
- Lieferbar in elf Profilvarianten
- Ausführung für manuellen Vorschub
- *TC-tipped profile cutterhead with a steel body for cutting profiles and counter profiles in solid-wood frame doors*
- *available in eleven different profiles for manual feed*

**P1**  
 P1

MAN

HW

Nr.	D	B	d	Z	$n_{min} - n_{max}$	Art.Nr.
1	140	12	50	3	5500-9500	<b>8289.140.012</b>
2		13	50	3	5500-9500	<b>8289.140.013</b>

Garnitur - Set (1+2)

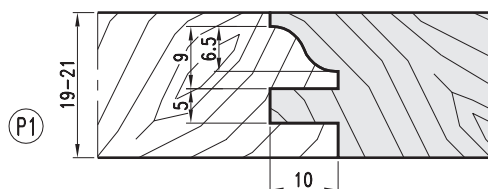
**8289.001.000**
**P2**  
 P2

MAN

HW

Nr.	D	B	d	Z	$n_{min} - n_{max}$	Art.Nr.
1	140	12	50	3	5500-9500	<b>8289.140.112</b>
2		13	50	3	5500-9500	<b>8289.140.113</b>

Garnitur - Set (1+2)

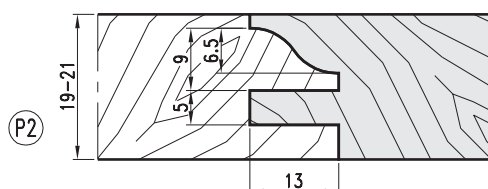
**8289.002.000**
**P3**  
 P3

MAN

HW

Nr.	D	B	d	Z	$n_{min} - n_{max}$	Art.Nr.
1	140	12	50	3	5500-9500	<b>8289.140.212</b>
2		14	50	3	5500-9500	<b>8289.140.014</b>

Garnitur - Set (1+2)

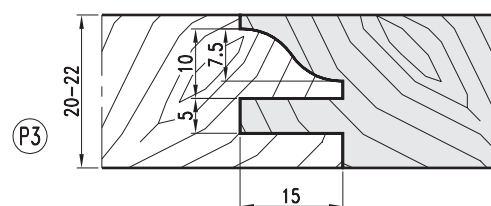
**8289.003.000**
**P4**  
 P4

MAN

HW

Nr.	D	B	d	Z	$n_{min} - n_{max}$	Art.Nr.
1	140	12	50	3	5500-9500	<b>8289.140.312</b>
2		13	50	3	5500-9500	<b>8289.140.213</b>

Garnitur - Set (1+2)

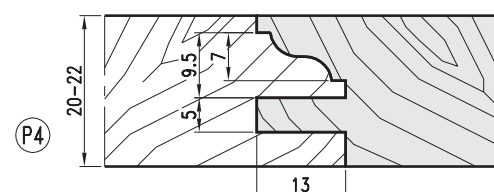
**8289.004.000**

**P5**  
P5

**MAN**
**HW**

Nr.	D	B	d	Z	$n_{min} - n_{max}$	Art.Nr.
1	140	12	50	3	5500-9500	<b>8289.140.112</b>
2		13	50	3	5500-9500	<b>8289.140.313</b>
Garnitur - Set (1+2)						<b>8289.005.000</b>

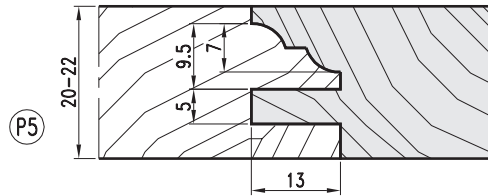
**P6**  
P6

**MAN**
**HW**

Nr.	D	B	d	Z	$n_{min} - n_{max}$	Art.Nr.
1	140	12	50	3	5500-9500	<b>8289.140.012</b>
2		13	50	3	5500-9500	<b>8289.140.114</b>
Garnitur - Set (1+2)						<b>8289.006.000</b>

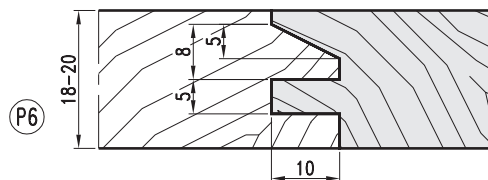
**P7**  
P7

**MAN**
**HW**

Nr.	D	B	d	Z	$n_{min} - n_{max}$	Art.Nr.
1	140	12	50	3	5500-9500	<b>8289.140.212</b>
2		13	50	3	5500-9500	<b>8289.140.015</b>
Garnitur - Set (1+2)						<b>8289.007.000</b>

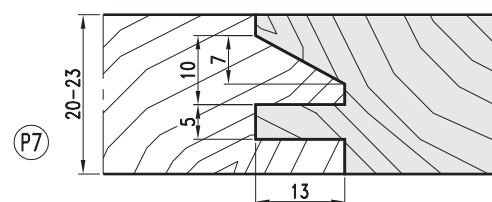
**P8**  
P8

**MAN**
**HW**

Nr.	D	B	d	Z	$n_{min} - n_{max}$	Art.Nr.
1	140	12	50	3	5500-9500	<b>8289.140.312</b>
2		13	50	3	5500-9500	<b>8289.140.115</b>
Garnitur - Set (1+2)						<b>8289.008.000</b>

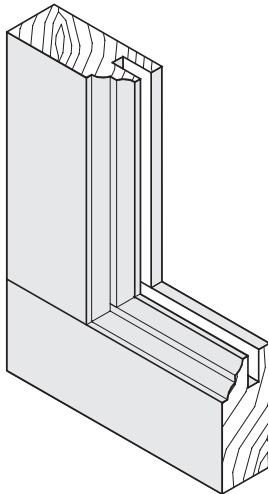
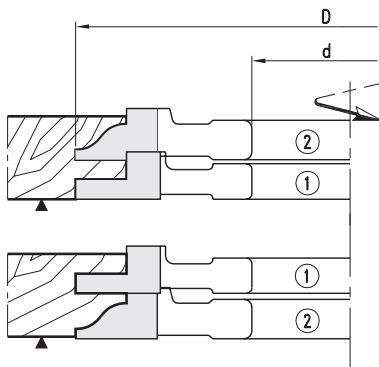
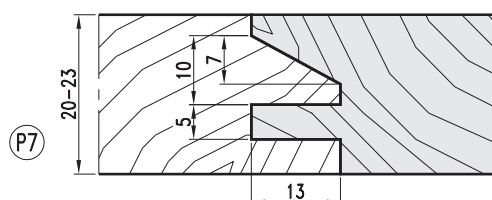

- HW-Profilmesserkopf mit Stahlgrundkörper zum Fräsen von Profilen und Konterprofilen an Massivholz-Rahmen-türen
- Lieferbar in elf Profilvarianten
- Ausführung für manuellen Vorschub

- *TC-tipped profile cutterhead with a steel body for cutting profiles and counter profiles in solid-wood frame doors*
- *available in eleven different profiles for manual feed*

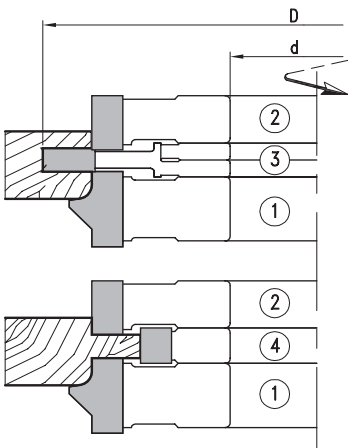
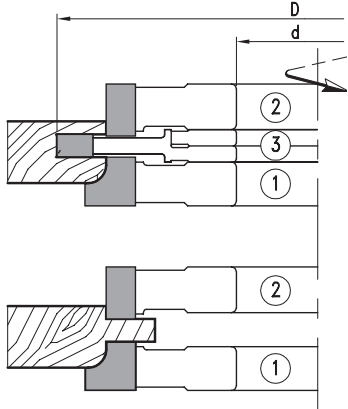
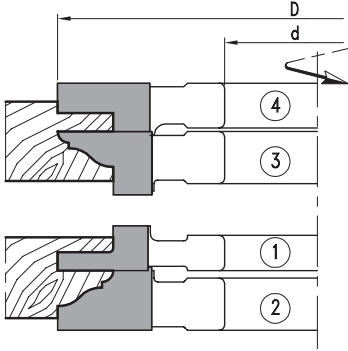

- HW-Profilmesserkopf mit Stahlgrundkörper zum Fräsen von Profilen und Konterprofilen an Massivholz-Rahmentüren
- Lieferbar in elf Profilvarianten
- Ausführung für manuellen Vorschub
- *TC-tipped profile cutterhead with steel body for cutting profiles and counter profiles in solid-wood frame doors*
- *available in eleven different profiles*
- *for manual feed*

**P9**  
P9

MAN

HW

Nr.	D	B	d	Z	n <sub>min</sub> - n <sub>max</sub>	Art.Nr.
1	140	12	50	3	5500-9500	<b>8289.140.212</b>
2		17	50	3	5500-9500	<b>8289.140.017</b>
3		17	50	3	5500-9500	<b>8289.140.117</b>
4		15	50	3	5500-9500	<b>8289.140.215</b>
Garnitur - Set (1+2)						<b>8289.009.000</b>
Garnitur - Set (3+4)						<b>8289.009.001</b>

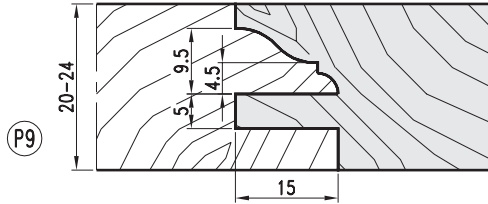

**P10**  
P10

MAN

HW

Nr.	D	B	d	Z	V	n <sub>min</sub> - n <sub>max</sub>	Art.Nr.
1	143	10	50	3		5300-9100	<b>8289.143.010</b>
2	130	16	50	3		6000-10200	<b>8289.130.016</b>
3	160	7-13,5	50	4	4	4800-8300	<b>8289.160.007</b>
Garnitur - Set (1+2+3)						<b>8289.010.000</b>	

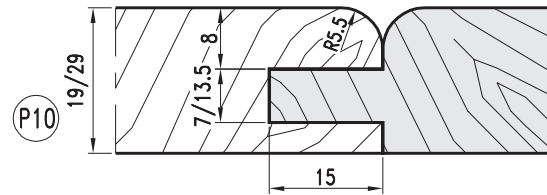

**P11**  
P11

MAN

HW

Nr.	D	B	d	Z	V	n <sub>min</sub> - n <sub>max</sub>	Art.Nr.
1	143	22,5	50	3		5300-9100	<b>8289.143.023</b>
2	130	16	50	3		6000-10200	<b>8289.130.116</b>
3	160	7-13,5	50	4	4	4800-8300	<b>8289.160.107</b>
4	100	15	50	3		7700-13300	<b>8289.100.015</b>
Garnitur - Set (1+2+3)						<b>8289.011.000</b>	

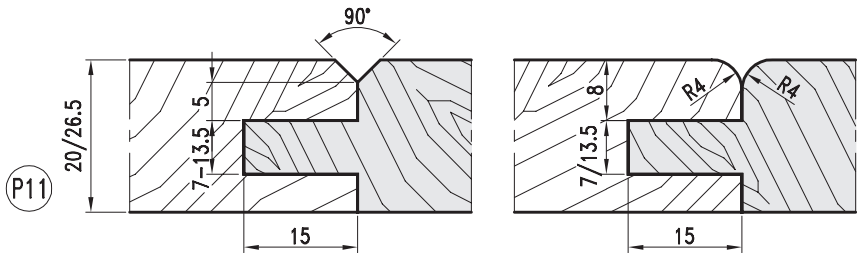

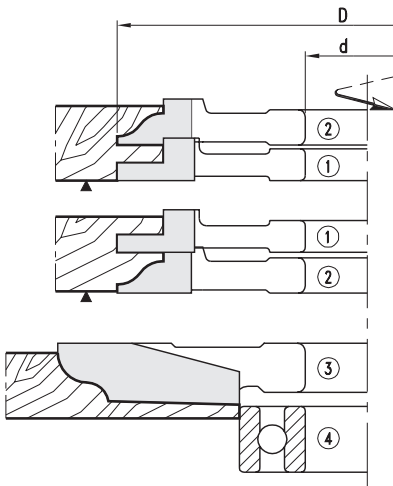
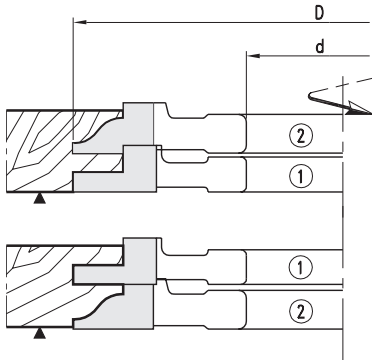
**Türprofil- und Konterprofilgarnitur Z=3**  
*Door profile and counter-profile set Z=3*
**MAN**
**HW**

Nr.	D	B	d	Z	$n_{min} - n_{max}$	Art.Nr.
1	120	10,5	30	2	6400-11100	<b>8289.120.011</b>
2	120	11,8	30	2	6400-11100	<b>8289.120.012</b>
Garnitur - Set (1+2)						<b>8289.012.000</b>

- HW-Profilmesserkopf mit Stahlgrundkörper zum Fräsen von Profilen und Konterprofilen an Massivholz-Rahmentüren
- Ausführung für manuellen Vorschub
- *TC-tipped profile cutterhead with steel body for cutting profiles and counter profiles in solid-wood frame doors*
- *for manual feed*

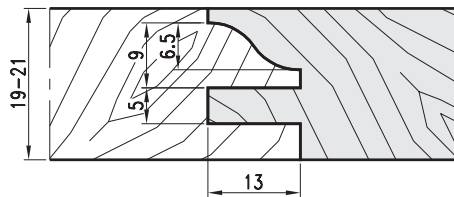
**Türprofil- und Konterprofilgarnitur Z=2**  
*Door profile and counter-profile set Z=2*
**MAN**
**HW**

Nr.	D	B	d	Z	$n_{min} - n_{max}$	Art.Nr.
1	120	10,5	30	2	6400-11100	<b>8289.120.111</b>
2	120	11,8	30	2	6400-11100	<b>8289.120.112</b>
3	150	14,0	30	2	5200-8900	<b>8289.150.014</b>
4	62					<b>8289.062.000</b>
Garnitur - Set (1+2+3+4)						<b>8289.013.000</b>

- HW-Profilmesserkopf mit Stahlgrundkörper zum Fräsen von Profilen und Konterprofilen sowie zum Abplattan von Füllungen mit Anlauftring
- Ausführungen für manuellen Vorschub
- *TC-tipped profile cutterhead with steel body for cutting profiles and counter profiles, as well as for flattening panels with guide ring*
- *for manual feed*

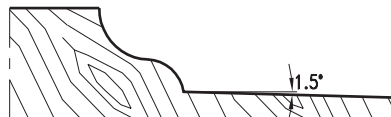
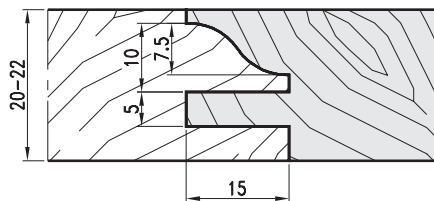

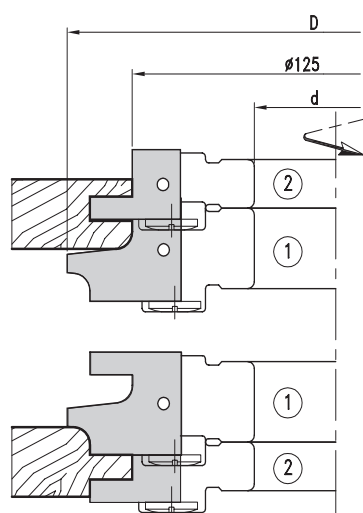
**Türprofil- und Konterprofilgarnitur**  
*Door profile and counter-profile set*

MEC

HW

Nr.	D	B	d	Z	n <sub>min</sub> - n <sub>max</sub>	Art.Nr.
1	165	30	30/50	2	5500-9500	● 4814.165.030
2	151	20	30/50	2	5500-9500	● 4814.151.020
Garnitur - Set (1+2)						4814.000.000

- Ohne Wendemesser, bitte bestellen Sie diese separat.
- *without replacement knives, please order them separately*

- WP-Profilmesserkopf mit Stahlgrundkörper zum Fräsen von Profilen und Konterprofilen an Massivholz-Rahmentüren. Erhältlich in vier verschiedenen Profilvarianten.
- Ausführung für mechanischen Vorschub
- *profile cutterhead with steel body and replaceable knives for cutting profiles and counter profiles in solid-wood frame doors, available in four different profiles*
- *for mechanical feed*

**Wechselmesser/Ersatzteile**  
*Replacement knives/Spare parts*

	Nr.	P	Dim.	Art.Nr.
Wechselmesser - Replacement knife	1	P1	30x35x2	785.790
		P2	30x35x2	785.791
		P3	30x35x2	785.792
		P4	30x35x2	785.793
Spannkeil - Clamping wedge	2		20x30x2	785.794
	1			707.578.01
Gewindestift - Set screw			M8x16	705.542
Sechskantschlüssel - Allen key			SW4(M8)	706.104

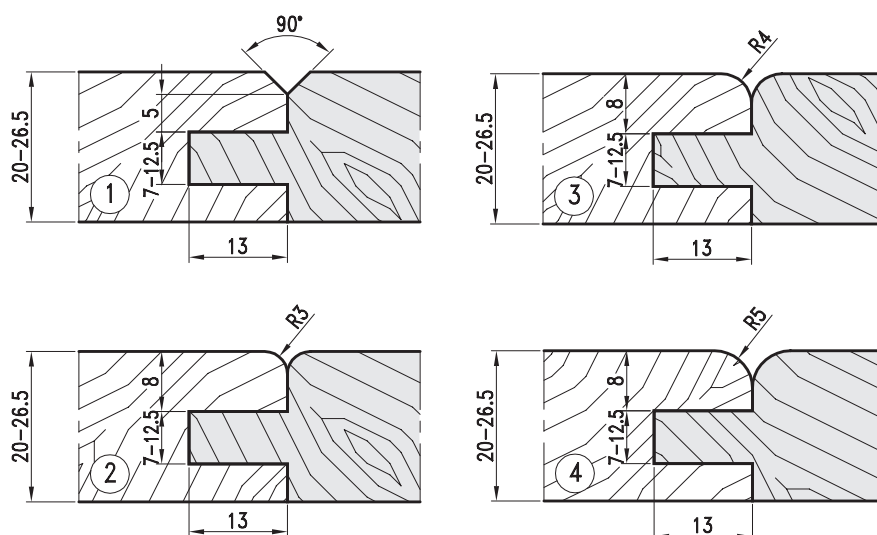
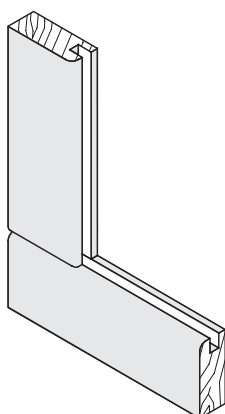

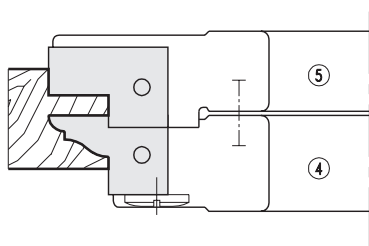
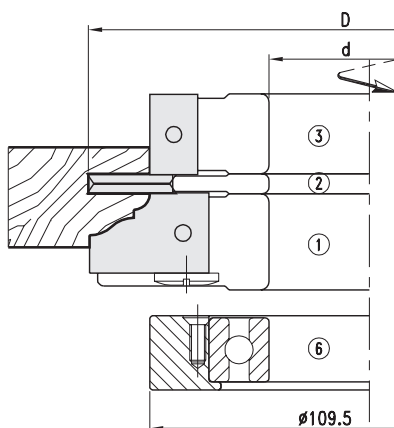

**Türprofil- und Konterprofilgarnitur**  
*Door profile and counter-profile set*
**MAN**
**HW**

Nr.	D	B	d	Z	n <sub>min</sub> - n <sub>max</sub>	Art.Nr.
1	139,5	20	50	4	5500-9500	● <b>4819.140.020</b>
2	140,0	5	50	4	5500-9500	<b>4849.140.005</b>
3	109,5	20	50	4	7000-11900	<b>4819.110.020</b>
4	160,0	20	50	3	4800-8300	● <b>4819.160.020</b>
5		20	50	3	4800-8300	<b>4819.160.120</b>
6	109,5	Anlaufring - Guide ring				<b>702.224</b>
Garnitur - Set						<b>4819.000.000</b>

- Ohne Wechselmesser, bitte bestellen Sie diese separat.
- *replacement knives are not included, please order them separately*
- WP-Profilmesserkopf mit Stahlgrundkörper zum Fräsen von Profilen und Konterprofilen an Massivholz-Rahmentüren mit Anlaufring. Erhältlich in drei verschiedenen Profilvarianten.
- Ausführung für manuellen Vorschub.
- *profile cutterhead with steel body and replaceable knives for cutting profiles and counter profiles in solid-wood frame doors with guide ring, available in three different profiles for manual feed*

**Wechselmesser/Ersatzteile**
*Replacement knives/Spare parts*

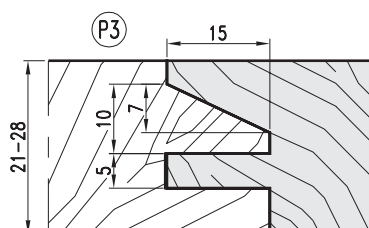
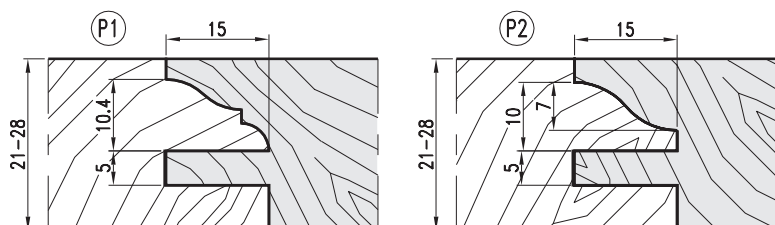
	Nr.	P	Dim.	Art.Nr.
Wechselmesser - Replacement knife	1	P1	20x30x2	<b>785.750</b>
		P2	20x30x2	<b>785.751</b>
		P3	20x30x2	<b>785.752</b>
	3		20x12x15	<b>750.102</b>
	4	P1	20x30x2	<b>785.753</b>
		P2	20x30x2	<b>785.754</b>
		P3	20x30x2	<b>785.755</b>
Spannkeil - Clamping wedge	5		20x30x2	<b>785.756</b>
	1			<b>707.091</b>
	3			<b>707.130.20</b>
	4			<b>707.092</b>
	5			<b>707.093</b>
Gewindestift - Set screw			M8x16	<b>705.542</b>
Kugellager - Ball bearing	6		D-80	<b>701.105</b>
Sechskantschlüssel - Allen key			SW4	<b>706.104</b>





**Türprofil- und Konterprofilgarnitur**  
*Door profile and counter-profile set*

MAN

HW

Nr.	D	B	d	Z	V	I	n <sub>min</sub> - n <sub>max</sub>	Art.Nr.
1	150,2	24,0	30/50	2	2+2	2	5200-8900	<b>4819.150.024</b>
2	150,0	29,5	30/50	2			5200-8900	<b>4819.150.030</b>
Garnitur - Set (1+2)								<b>4819.000.001</b>

- WP-Profilmesserkopf mit Stahlgrundkörper zum Fräsen von Profilen und Konterprofilen an Massivholz-Rahmentüren. Erhältlich in drei verschiedenen Profilvarianten.
- Ausführung für manuellen Vorschub
- *profile cutterhead with steel body and replaceable knives for cutting profiles and counter profiles in solid-wood frame doors, available in three different profiles*
- *for manual feed*

**Wechselmesser/Ersatzteile**  
*Replacement knives/Spare parts*

	Nr.	P	Dim.	Art.Nr.
Wechselmesser - Replacement knife	2	P1	29,5X27,5X2	<b>785.404</b>
		P2	29,5X27,5X2	<b>785.405</b>
		P3	29,5X27,5X2	<b>785.406</b>
Spannkeil - Clamping wedge	1	P4	20x12x1,5	<b>750.102</b>
	2			<b>707.253</b>
Gewindestift - Set screw	1		M8x16	<b>705.542</b>
Vorschneider - Scoring blade			22x19x2	<b>760.101</b>
Spannschraube - Clamping screw			M5x7	<b>705.425</b>
Nutmesser - Grooving blade			13x24,5x5	<b>783.102</b>
Schraube - Screw			M5x13,5	<b>705.318</b>
Sechskantschlüssel - Allen key			SW3(M5)	<b>706.103</b>
			SW4(M8)	<b>706.104</b>

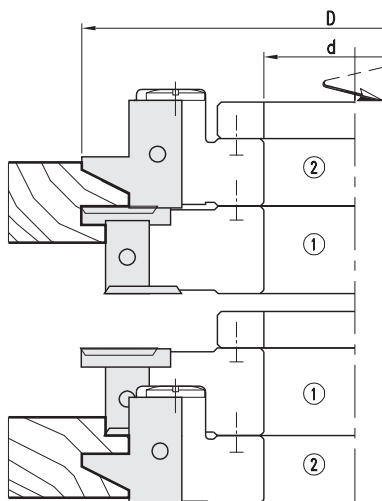

- Garnitur Art. 4819.000.001 wird vollständig mit 3 Profilen geliefert
- *set with Art. No. 4819.000.001 includes three profiles*

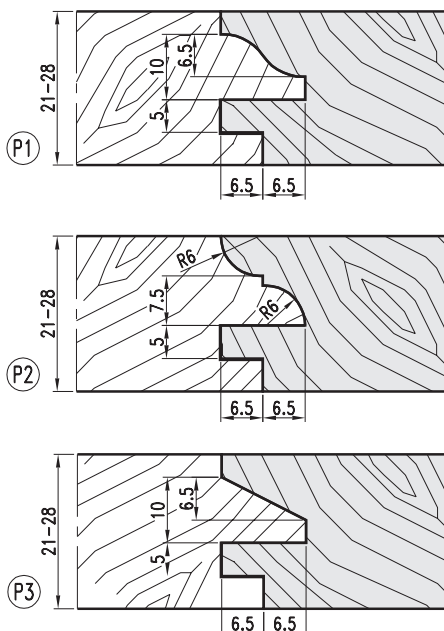
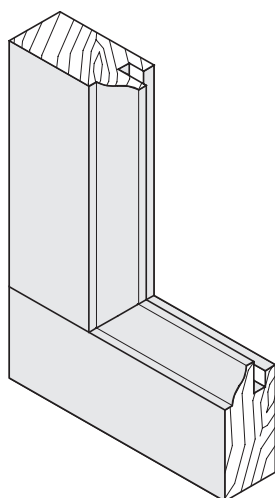



**HW Türprofil- und Konterprofilgarnitur - Wechselmesser**
*TC Profile- and counterprofile cutterset for doors - Reversible knife*
**MAN**
**HW**

Nr.	D	B	d	Z	V	I	n min - n max	Art.Nr.
1	160	30	30/50	3	3	3	5500-9500	● <b>4819.160.030</b>
2		20	30/50	3	3+3		5500-9500	<b>4849.160.220</b>
3	138	20	30/50	3			7000-11900	<b>4819.138.020</b>
4	135	19	30/50					<b>4819.135.019</b>
Garnitur - Cutterset								<b>4819.000.002</b>

- Ohne Wechselmesser
- *Cutterhead supplied without knives*
- WP-Profilmesserkopf mit Stahlrgkörper zum Fräsen von Profil und Konterprofil an Massivholz-Rahmentüren. Drei verschiedene Profilvarianten.
- Ausführung für manuellen Vorschub.
- *TC-Profile cutterhead with steel tool body and reversible knives for profiles and counter profiles in solid wood framed doors in cabinetry. Three tool sets for frames with different profiles.*
- *Layout for manual feed.*

**Wechselmesser/Ersatzteile**
*Reversible knives/Spare parts*

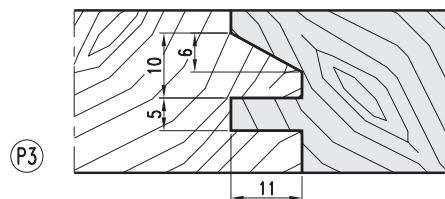
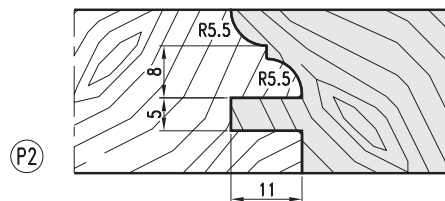
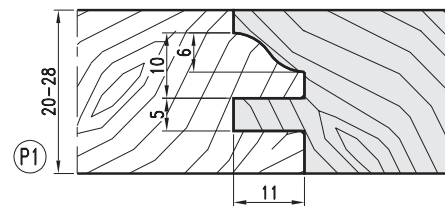
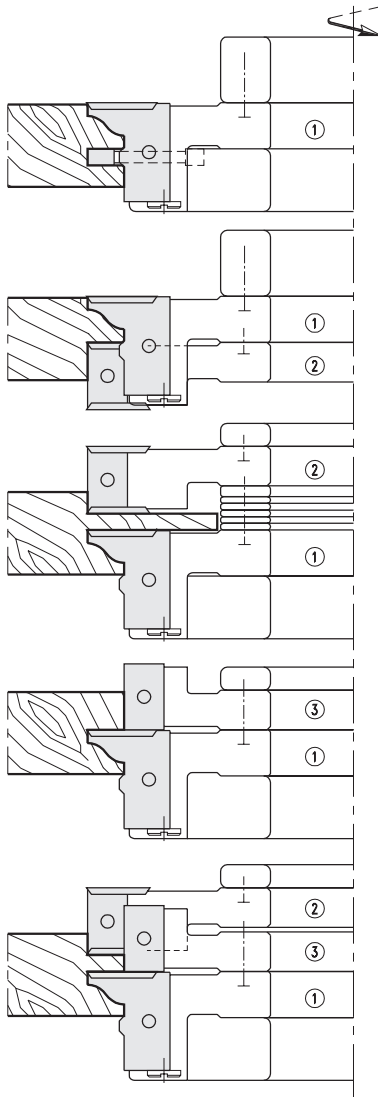
	Nr.	P	Dim.	Art.Nr.
Wechselmesser - Reversible knife	1	P1	30x25x2	<b>785.302</b>
		P2	30x25x2	<b>785.301</b>
		P3	30x25x2	<b>785.303</b>
Spannkeil - Clamping wedge	2/3		20x12x1,5	<b>750.102</b>
	1			<b>707.807</b>
Gewindestift - Screw	2/3			<b>707.002.18</b>
	1		M8x12	<b>705.541</b>
Vorschneider - Spur	2/3		M8x16	<b>705.542</b>
	1		22x19x2	<b>760.101</b>
Spannschraube - Screw	2		14x14x2	<b>750.111</b>
			M5x8	<b>705.422</b>
Nutmesser - Groover			35x17x5	<b>783.121</b>
Schraube - Screw			M5x13,5	<b>705.318</b>
Sechskantschlüssel - T Wrench			SW3(M5)	<b>706.103</b>
			SW4(M8)	<b>706.104</b>





**Für Weich- und Harthölzer sowie beschichtete oder furnierte Holzwerkstoffe**  
*For softwoods and hardwoods, and coated or veneered wood-based materials*

**MAN**

**HW**

Nr.	D	B	d	Z	V	I	n <sub>min</sub> - n <sub>max</sub>	Art.Nr.
1	125	4,0	40/50	2		2	6100-10500	<b>4879.125.004</b>
2	155	8,0	40/50	2	4		4300-8400	<b>4879.155.008</b>
3	139	9,8	40/50	2	2		5600-9600	<b>4879.139.010</b>
4	153	15,0	40/50	2	2	2	5000-8600	<b>4879.153.015</b>
5	147	15,0	40/50	2	2		5200-8900	<b>4879.147.015</b>

- WP-Profilmesserkopf mit Stahlgrundkörper zum Fräsen von Türfutter und -bekleidung. Geeignet für Weich- und Harthölzer sowie beschichtete oder furnierte Span- und Faserwerkstoffe.
- Ausführung für manuellen Vorschub
- *profile cutterhead with a steel body for cutting door linings and frames - suitable for softwoods and hardwoods, as well as coated or veneered chipboard and fibre materials*
- *for manual feed*

**Wechselmesser/ Ersatzteile**  
*Replacement knives/Spare parts*

	Nr.	Dim.	Art.Nr.
Wechselmesser - Replacement knife	2	7,5x12x1,5	<b>750.097</b>
	3	9,6x12x1,5	<b>750.098</b>
	4/5	15x12x1,5	<b>750.101</b>
Spannkeil - Clamping wedge	2		<b>707.002.07</b>
	3		<b>707.002.08</b>
	4/5		<b>707.133.15</b>
Schraube - Screw	2	M5x12	<b>705.523</b>
	3	M6x16	<b>705.535</b>
	4/5	M8x12	<b>705.541</b>
Vorschneider - Scoring blade		14x14x2	<b>750.111</b>
Schraube - Screw		M5x7	<b>705.425</b>
Nutmesser - Grooving blade	1	20x34x5	<b>783.123</b>
	1	20x26x5	<b>783.124</b>
Abrundmesser - Rounding blade		R3	<b>780.251</b>
Fasemesser - Chamfering blade		45°	<b>780.260</b>
Schraube - Screw		M5x13,5	<b>705.318</b>
Sechskantschlüssel - Allen key		SW2,5(M5)	<b>706.102</b>
		SW3(M6)	<b>706.103</b>
		SW4(M8)	<b>706.104</b>

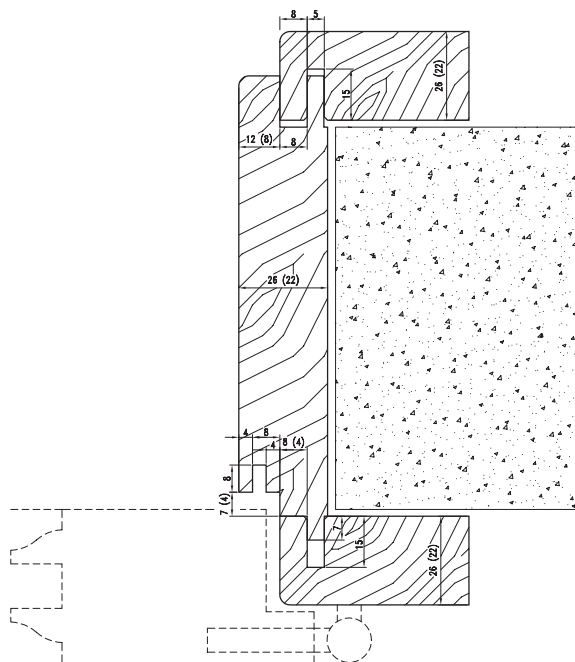
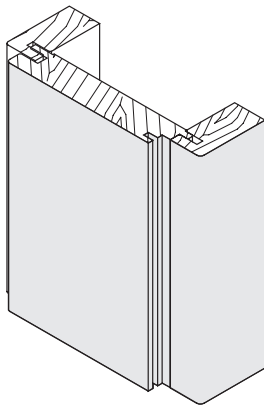
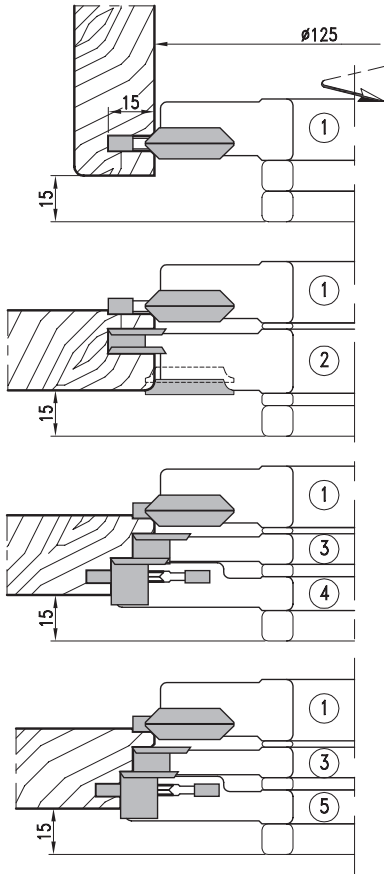

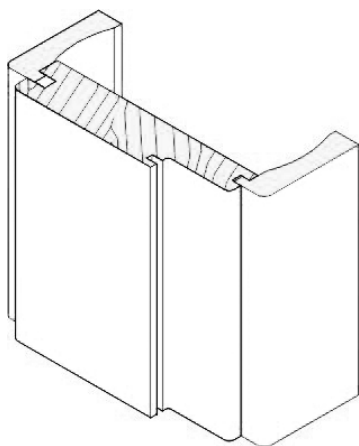

**Für Weich- und Harthölzer sowie beschichtete oder furnierte Holzwerkstoffe**  
*For softwoods and hardwoods, and coated or veneered wood-based materials*

MEC

HW

Nr.	D	B	d	Z	V	I	n <sub>min</sub> - n <sub>max</sub>	Art.Nr.
1	166	20	40/50	4		2	7800	<b>4884.166.020</b>
2	102	25	40	4			14200	<b>4884.102.025</b>
	112	25	40/50	4			12000	<b>4884.112.025</b>
3	137	40	40/50	4			9500	<b>4884.137.040</b>
4	149	6	40/50	4	4		8900	<b>4884.149.006</b>

- WP-Profilmesssägekopf mit Stahlgrundkörper zum Fräsen von Türfutter und -bekleidung. Geeignet für Weich- und Harthölzer sowie beschichtete oder furnierte Span- und Faserwerkstoffe.
- Ausführung für manuellen Vorschub
- *profile cutterhead with a steel body for cutting door linings and frames - suitable for softwoods and hardwoods, as well as coated or veneered chipboard and fibre materials*
- *for manual feed*

**Wechselmesser/Ersatzteile**  
*Replacement knives/Spare parts*

	Nr.	Dim.	Art.Nr.
Wechselmesser - <i>Replacement knife</i>	1	20x12x1,5	<b>785.110</b>
	2	25x17x2	<b>785.111</b>
	3	40x20x2	<b>785.112</b>
	4	7,6x12x1,5	<b>750.097</b>
Spannkeil - <i>Clamping wedge</i>	1		<b>707.130.20</b>
	2		<b>707.012.23</b>
	3		<b>707.002.38</b>
	4		<b>707.002.07</b>
Schraube - <i>Screw (DIN 963)</i>	1/3	M8x16	<b>705.542</b>
	2	M6x16	<b>705.535</b>
	4	M5x12	<b>705.523</b>
Vorschneider - <i>Scoring blade</i>		14x14x2	<b>750.111</b>
Schraube - <i>Screw (DIN 963)</i>		M5x7	<b>705.425</b>
Nutmesser - <i>Grooving blade</i>		25,55x13x4	<b>783.101</b>
Schraube - <i>Screw</i>		M5x13,5	<b>705.318</b>
Sechskantschlüssel - <i>Allen key</i>		SW4 (M8)	<b>706.104</b>
		SW3 (M6)	<b>706.103</b>
		SW2,5 (M5)	<b>706.102</b>

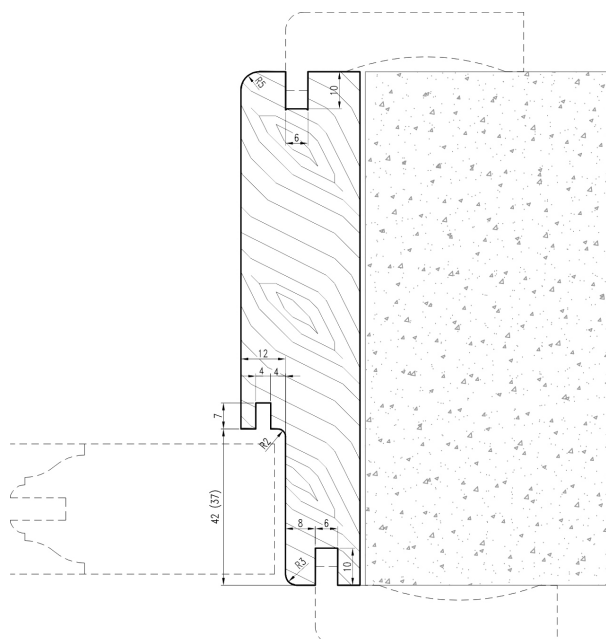
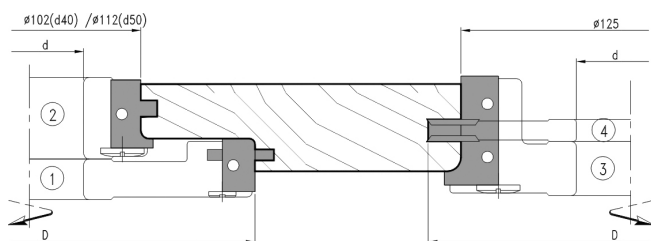

**WP-Profilmesserkopf für Weich- und Harthölzer**
*Profile cutterhead with replaceable knives for softwoods and hardwoods*
**MEC**
**HW**

Nr.	D	B	d	Z	V	S	n <sub>max</sub>	Art.Nr.
1	147	20	50	2			8900	● 4884.147.020
2	125	100	50	2			8900	4884.125.100
3	147	50	50	2	2	2	8900	4884.147.050
4	50	190	40					704.901

Garnitur (1+2+3+4) - Set (1+2+3+4)

**4884.000.000**

- Ohne Wechselmesser, bitte bestellen Sie diese separat.  
*replacement knives are not included, please order them separately*
- WP-Profilmesserkopf mit Stahlgrundkörper zum Fräsen von Türfuttern  
Ausführung für mechanischen Vorschub
- *profile cutterhead with steel tool body and replaceable knives for cutting door linings for mechanical feed*

**Wechselmesser/Ersatzteile**
*Replacement knives/Spare parts*

	Nr.	Dim.	Art.Nr.
Wechselmesser - Replacement knife	1	20x25x2	785.621
		20x25x2	785.622
		20x25x2	785.623
Spannkeil - Clamping wedge	2	100x13x2,2	750.109
	3	50x12x1,5	750.106
			707.084
Gewindestift - Set screw (DIN915)	1		707.002.98
	2		707.130.48
	3		705.542
Vorschneider - Scoring blade		M8x16	750.111
Spannschraube - Clamping screw (DIN963)		14x14x2	705.425
Abrundmesser - Rounding blade		M5x7	780.205
Schraube - Screw		R1,5	705.318
Sechskantschlüssel - Allen key		M5x13,5	706.103
		SW3(M5)	706.104
		SW4(M8)	

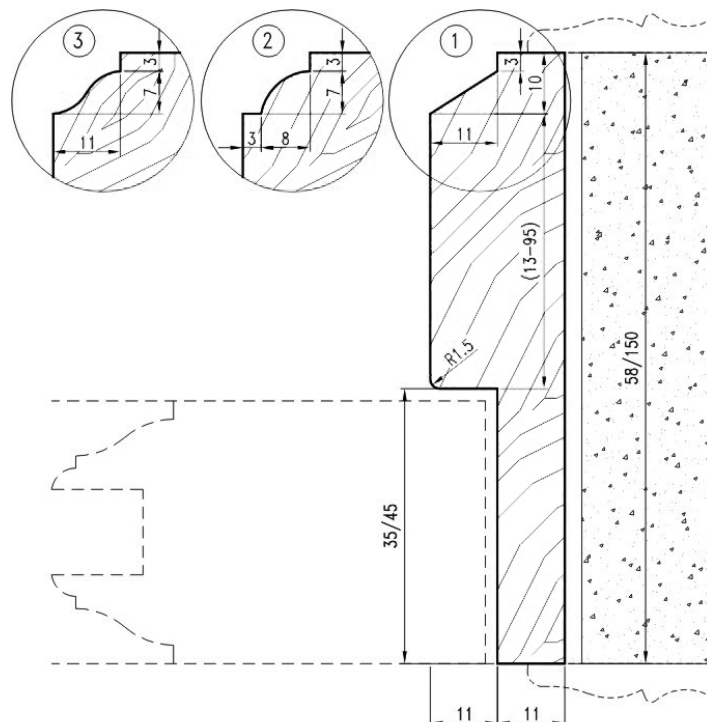
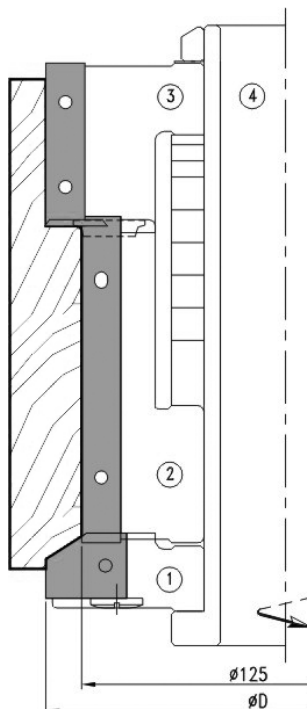

**WP-Profilmesserkopf für Weich- und Harthölzer**
*Profile cutterhead with replaceable knives for softwoods and hardwoods*

MEC

HW

Nr.	D	B	d	Z	V	n <sub>min</sub> - n <sub>max</sub>	Art.Nr.
1	302	20	50	3		2600-4400	● 5239.302.020
2		10	50	3	6	2600-4400	5239.302.010
3	280	10	50	3	6	2800-4700	5239.280.010
4		50	50	3	3	2800-4700	5239.280.050
5	302	10	50	3	6	2800-4400	5239.302.010

- Ohne Wechselmesser, bitte bestellen Sie diese separat.
- *replacement knives are not included, please order them separately*

- WP-Profilmesserkopf mit Stahlgrundkörper zum Fräsen von Türfuttern
- Ausführung für mechanischen Vorschub
- *profile cutterhead with replaceable blades and a steel body for cutting door linings*
- *for mechanical feed*

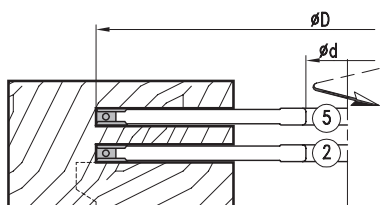
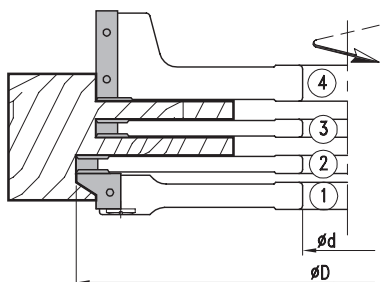

Profile, siehe Art. 4884  
*profiles, see Art. 4884*

**Wechselmesser/ Ersatzteile**
*Replacement knives/Spare parts*

	Nr.	P	Dim.	Art.Nr.
Wechselmesser - <i>Replacement knife</i>	1	P1	20x25x2	785.625
		P2	20x25x2	785.626
		P3	20x25x2	785.627
	2/3/5		9,6x12x1,5	750.098
	4		50x12x1,5	750.106
Spannkeil - <i>Clamping wedge</i>	1			707.085
	2/3/5			707.002.08
	4			707.130.50
Gewindestift - <i>Set screw</i>			M8x16	705.542
	2/3/5		M6x16	705.535
Vorschneider - <i>Scoring blade</i>			14x14x2	705.111
Spannschraube - <i>Clamping screw</i>			M5x7	705.425
Sechskantschlüssel - <i>Allen key</i>			SW3(M6)	706.103
			SW4(M8)	706.104

- Serienartikel, kurzfristige Fertigung bei Bestellung
- *standard product, manufactured promptly upon order*

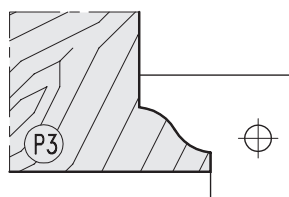
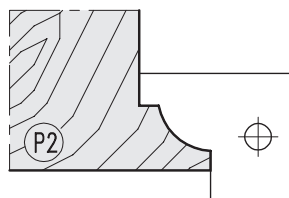
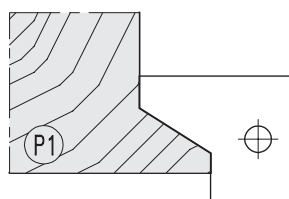
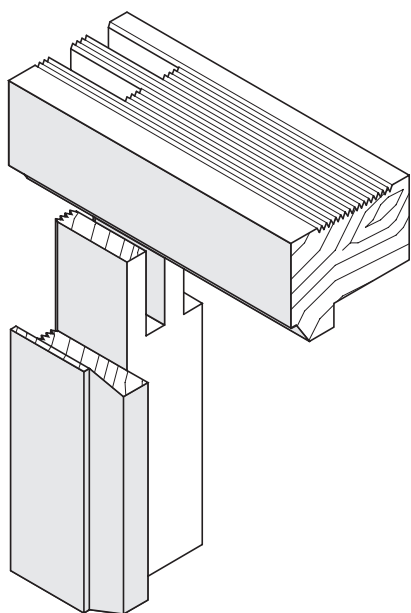



**Profil- und Konterprofilgarnitur**  
Profile and counter-profile set

MAN

HW

Nr.	D	B	d	Z	V	n min - n max	Art.Nr.
1	140	20	50	3		5500-9500	● 4899.140.020
2		8	50	4	4	5500-9500	5149.140.008
3		20	50	3		5500-9500	● 4899.140.120
4	302	20	50	3		2600-4400	● 4899.302.020
5		20	50	3		2600-4400	● 4899.302.120
8	140	50	50	4	4	5500-9500	4899.140.050
9	272	30	50	3	3	2800-4800	4899.272.030
10	302	30	50	3	3	2600-4400	4899.302.030

- ohne Wechselmesser
- supplied without knives

- WP-Profilmesserkopf mit Stahltragkörper zum Fräsen von Profil und Konterprofil an Massivholz-Rahmentüren.
- Zehn verschiedene Profilfräsergarnituren.
- Ausführung für manuellen Vorschub.
- TC-Profile cutterhead with steel tool body and reversible knives for profiles and counter profiles in solid wood framed doors.
- Ten different profilecuttersets.
- Layout for manual feed.

**Wechselmesser/Ersatzteile**  
Replacement knives/Spare parts

	P	Dim.	Nr.	Art.Nr.
Wechselmesser - Replacement knife	P1	20x30x2 (P1)	1	785.601
	P1	20x30x2 (P1)	3	785.602
	P1	20x30x2 (P1)	4	785.603
	P1	20x30x2 (P1)	5	785.604
	P2	20x30x2 (P2)	1	785.605
	P2	20x30x2 (P2)	3	785.606
	P2	20x30x2 (P2)	4	785.607
	P2	20x30x2 (P2)	5	785.608
	P3	20x30x2 (P3)	1	785.609
	P3	20x30x2 (P3)	3	785.610
Spannkeil - Clamping wedge	P4	20x30x2 (P4)	1	785.613
	P4	20x30x2 (P4)	3	785.614
	P4	20x30x2 (P4)	4	785.615
	P4	20x30x2 (P4)	5	785.616
		7,5x12x1,5	2	750.097
		30x12x1,5	9/10	750.104
		50x12x1,5	8	750.106
			1	707.080
			2	707.002.07
			3	707.081
Gewindestift - Set screw		M5x16		705.582
		M8x16		705.542
	Vorschneider - Scoring blade	14x14x2		750.111
	Spannschraube - Clamping screw	M5x6		705.424
	Sechskantschlüssel - Allen key		SW2,5 (M5)	
		SW4 (M8)		706.104

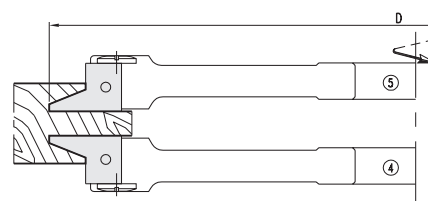
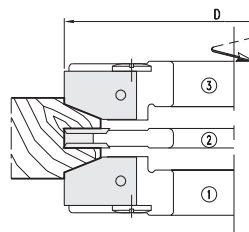
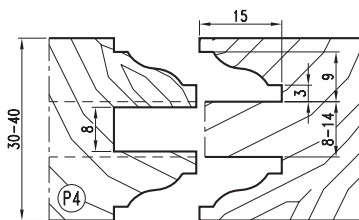
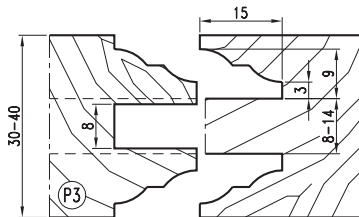
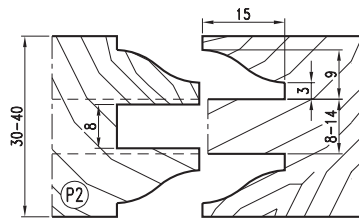
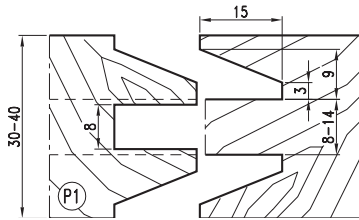

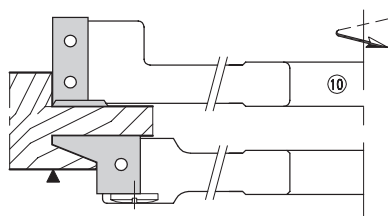
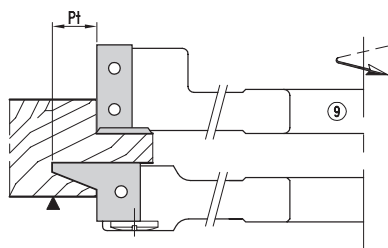
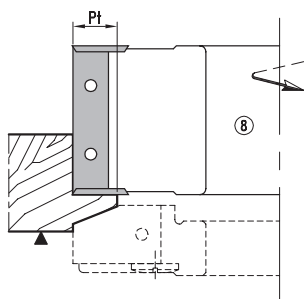
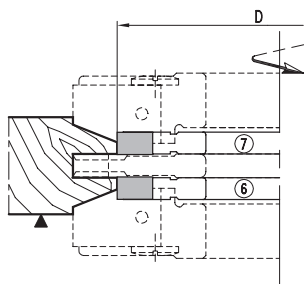
**Profil- und Konterprofilgarnitur für Türen**  
*Profile and counter-profile set for doors*
**HW**

Nr.	D	B	d	Z	V	Pt	n <sub>min</sub> - n <sub>max</sub>	Art.Nr.
6	110	7,6	50	3			6900-12000	<b>4899.110.008</b>
7		7,6	50	3			6900-12000	<b>4899.110.108</b>
8	132	30,0	50	3	3	11	5800-10000	<b>4899.132.030</b>
8		50,0	50	3	3	11	5800-10000	<b>4899.132.050</b>
8	140	50,0	50	4	4	15	5500-9500	<b>5769.140.050</b>
9	272	30,0	50	3	3	15	2800-4800	<b>5249.272.230</b>
9	280	30,0	50	3	3	11	2800-4700	<b>5249.280.230</b>
10	302	30,0	50	3	3		2600-4400	<b>5249.302.230</b>

**Wechselmesser/Ersatzteile**  
*Replacement knives/Spare parts*

	Nr.	Dim.	Art.Nr.
Wechselmesser - Replacement knife	6/7	7,5x12x1,5	<b>750.097</b>
	9/10	30x12x1,5	<b>750.104</b>
	8	50x12x1,5	<b>750.106</b>
Spannkeil - Clamping wedge	6/7		<b>707.002.07</b>
	9/10		<b>707.130.30</b>
	8		<b>707.130.50</b>
Gewindestift - Set screw	6/7	M6x12	<b>705.533</b>
		M8x16	<b>705.542</b>
Vorschneider - Scoring blade		14x14x2	<b>705.111</b>
Spannschraube - Clamping screw		M5x7	<b>705.425</b>
Sechskantschlüssel - Allen key		SW3(M6)	<b>706.103</b>
		SW4(M8)	<b>706.104</b>





**Profil- und Konterprofilgarnitur für Türen**  
*Profile and counter-profile set for doors*

MAN

HW

Nr.	D	B	d	Z	V	n <sub>min</sub> - n <sub>max</sub>	Art.Nr.
1	160	25	30/50	2		4800-8300	● 4894.160.025
2		8-15	30/50	4	4	4800-8300	4894.160.008
3		25	30/50	2		4800-8300	● 4894.160.125
Garnitur (1+2+3) - Set (1+2+3)							4894.000.000

- WP-Profilmesserkopf mit Stahlgrundkörper zum Fräsen von Profilen und Konterprofilen an Massivholz-Rahmentüren. Garnitur aus drei verschiedenen Profilmessern.
- Ausführung für manuellen Vorschub
- *profile cutterhead with steel body and replaceable knives for cutting profiles and counter profiles in solid-wood frame doors, set includes three different profile cutters*
- *for manual feed*

**Wechselmesser/Ersatzteile**  
*Replacement knives/Spare parts*

	P	Nr.	Dim.	Art.Nr.
Wechselmesser - Replacement knife	P1	1	29,5x25x2	785.502
	P1	3	29,5x25x2	785.501
	P2	1	29,5x25x2	785.504
	P2	3	29,5x25x2	785.503
	P3	1	29,5x25x2	785.506
	P3	3	29,5x25x2	785.505
Spannkeil - Clamping wedge		2	7,5x12x1,5	750.097
		1		707.531
		2		707.002.06
Gewindestift - Set screw		3		707.530
		2	M5x12	705.523
		1/3	M6x16	705.535
Vorschneider - Scoring blade			14x14x2	750.111
Spannschraube - Clamping screw			M5x7	705.425
Sechskantschlüssel - Allen key			SW2,5	706.102
			SW3	706.103

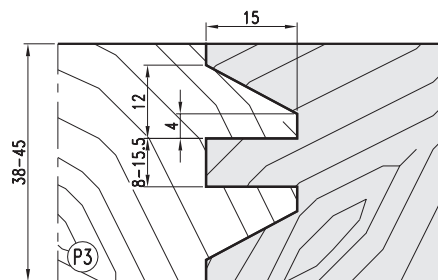
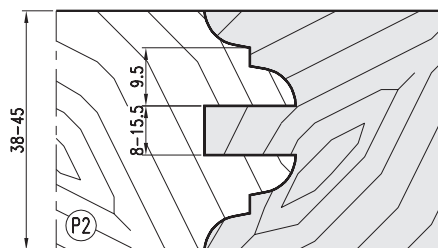
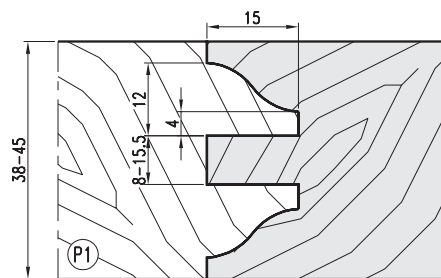
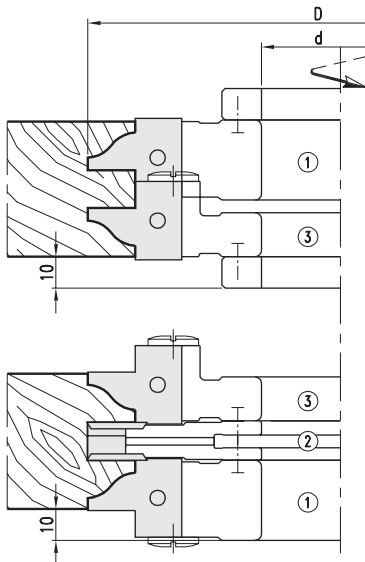



**Türprofil- und Konterprofilgarnitur**  
*Door profile and counter-profile set*
**MAN**
**HW**

Nr.	D	B	d	Z	n <sub>min</sub> - n <sub>max</sub>	Art.Nr.
1	138	25	30/50	3	5600-9600	<b>4839.138.025</b>
2	153	20	30/50	3	5000-8600	<b>4839.153.020</b>
3	151	20	30/50	3	5000-8600	<b>4839.151.020</b>

- WP-Profilmesserkopf mit Stahlgrundkörper zum Fräsen von Sprossen und Leisten an Massivholz-Rahmentüren. Garnitur aus drei verschiedenen Profilfräsern.
- Ausführung für manuellen Vorschub
- *profile cutterhead with steel body and replaceable knives for cutting rungs and mouldings on solid-wood frame doors, set includes three different profile cutters for manual feed*

**Wechselmesser/Ersatzteile**  
*Replacement knives/Spare parts*

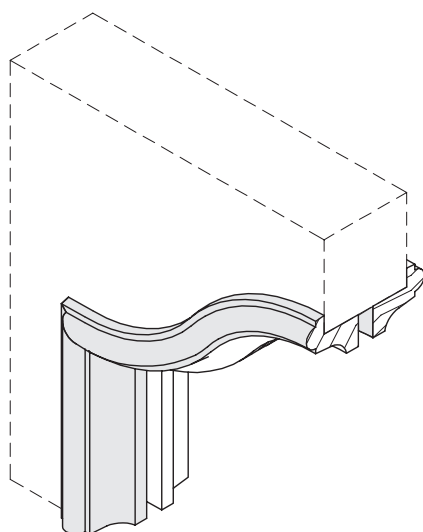
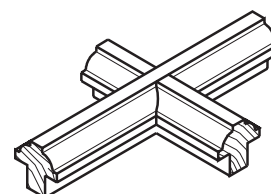
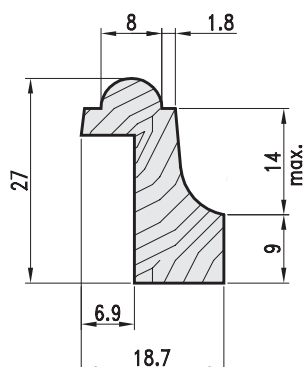
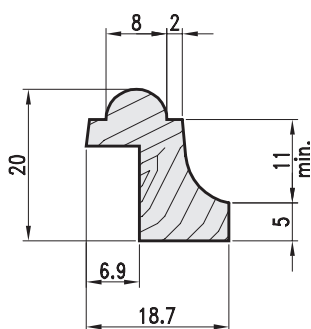
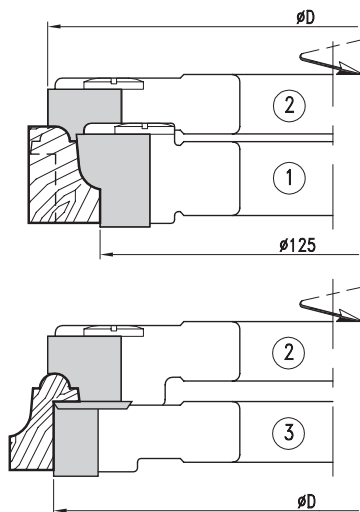
	Nr.	Dim.	Art.Nr.
Wechselmesser - <i>Replacement knife</i>	1	25x20x2	<b>785.774</b>
	2	20x20x2	<b>785.775</b>
	3	20x12x1,5	<b>750.102</b>
Spannkeil - <i>Clamping wedge</i>	1		<b>707.002.23</b>
	2		<b>707.576.01</b>
	3		<b>707.133.20</b>
Gewindestift - <i>Set screw</i>		M8x16	<b>705.542</b>
Vorschneider - <i>Scoring blade</i>		14x14x2	<b>750.111</b>
Spannschraube - <i>Clamping screw</i>		M5x7	<b>705.425</b>
Sechskantschlüssel - <i>Allen key</i>		SW4	<b>706.104</b>

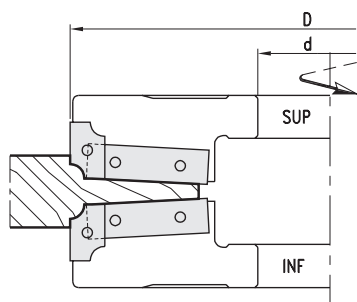

**Abplattfräser**  
*Panel raising cutter*
**MAN**
**HW**

D	B	d	Z	n <sub>min</sub> - n <sub>max</sub>	SUP	INF
180	30	30/50	2+2	4300-7400	● 5279.180.030	5279.180.130

- Abplattfräser wird mit P1 geliefert, auf Anfrage mit P2, P3 oder Profilen nach Wunsch.
- *panel raising cutter is supplied P1; on request, it can be supplied with P2, P3, or custom profiles*
- WP-Pofilmesserkopf mit Stahlgrundkörper zum Abplatten von Rahmenfüllungen
- Profilmesserkopf für drei verschiedene Abplattprofile zum einseitigen oder beidseitigen Abplatten
- Ausführung für manuellen Vorschub
- *panel raising cutter with steel tool body and replaceable knives for flattening frame panels*
- *profile cutterhead for three different panel raising profiles for one-sided or double-sided flattening for manual feed*

**Wechselmesser/Ersatzteile**  
*Replacement knives/Spare parts*

	Nr.	Dim.	Art.Nr.
Wechselmesser - <i>Replacement knife</i>	1 (SUP)	20x12x1,5	<b>781.111</b>
	2	20x12x1,5	<b>781.112</b>
	3	20x12x1,5	<b>781.113</b>
	1 (INF)	20x12x1,5	<b>781.114</b>
	2	20x12x1,5	<b>781.115</b>
	3	20x12x1,5	<b>781.116</b>
Spannkeil - <i>Clamping wedge</i>	SUP		<b>707.273</b>
	INF		<b>707.275</b>
Wendemesser - <i>Reversible knife</i>		50x12x1,5	<b>750.106</b>
Spannkeil - <i>Clamping wedge</i>	SUP		<b>707.274</b>
	INF		<b>707.276</b>
Gewindestift - <i>Set screw</i>		M8x16	<b>705.542</b>
Sechskantschlüssel - <i>Allen key</i>	SW4		<b>706.104</b>
Einstellehre - <i>Setting gauge</i>		1,0	<b>709.504</b>

- Standardprofil P1 und weitere Profilvarianten
- *basic profile P1 and additional profiles*

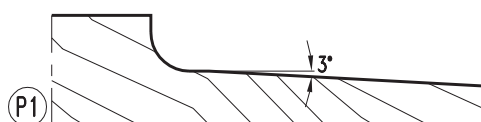
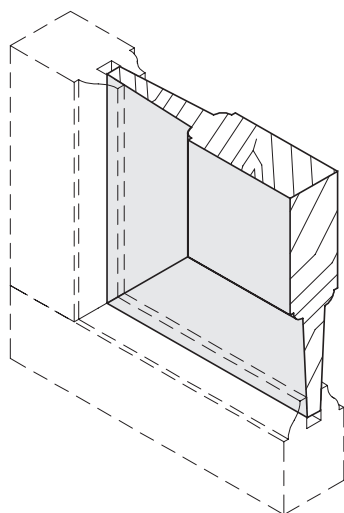

- Weitere Profilvarianten
- *additional profiles*

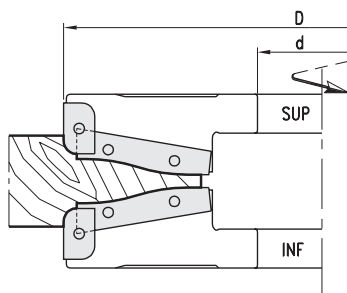
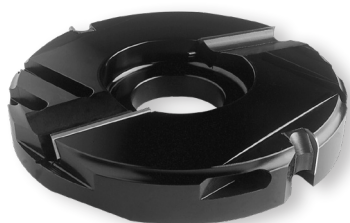
**Abplattfräser**  
*Panel raising cutter*
**MAN**
**HW**

D	B	d	Z	n <sub>min</sub> - n <sub>max</sub>	SUP	INF
200	30	30/50	2+2	3900-6600	● 5279.200.030	5279.200.130

- Abplattfräser wird mit P1 geliefert, auf Anfrage mit P2, P3 oder Profilen nach Wunsch.
- *panel raising cutter is supplied P1; on request, it can be supplied with P2, P3, or custom profiles*
- WP-Profilmesserkopf mit Stahlgrundkörper zum Abplatten von Rahmenfüllungen
- Profilmesserkopf für drei verschiedene Abplattprofile zum einseitigen oder beidseitigen Abplatten
- Ausführungen für manuellen Vorschub
- *panel raising cutter with steel tool body and replaceable knives for flattening frame panels*
- *profile cutterhead for three different panel raising profiles for one-sided or double-sided flattening*
- *for manual feed*

**Wechselmesser/Ersatzteile**
*Replacement knives/Spare parts*

	Nr.	Dim.	Art.Nr.
Wechselmesser - <i>Replacement knife</i>	1 (SUP)	20x12x1,5	<b>781.111</b>
	2	20x12x1,5	<b>781.112</b>
	3	20x12x1,5	<b>781.113</b>
	1 (INF)	20x12x1,5	<b>781.114</b>
	2	20x12x1,5	<b>781.115</b>
	3	20x12x1,5	<b>781.116</b>
Spannkeil - <i>Clamping wedge</i>	SUP		<b>707.273</b>
	INF		<b>707.275</b>
Wendemesser - <i>Reversible knife</i>	SUP	60x12x1,5	<b>781.120</b>
	INF	60x12x1,5	<b>781.121</b>
Spannkeil - <i>Clamping wedge</i>	SUP		<b>707.272</b>
	INF		<b>707.277</b>
Gewindestift - <i>Set screw</i>		M8x16	<b>705.542</b>
Sechskantschlüssel - <i>Allen key</i>		SW4	<b>706.104</b>
Einstelllehre - <i>Setting gauge</i>		1,0	<b>709.504</b>

- Standardprofil P1 und weitere Profilvarianten
- *basic profile P1 and additional profiles*

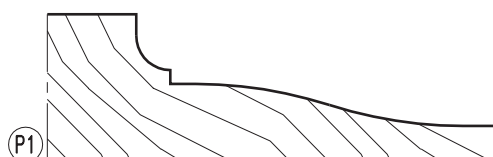
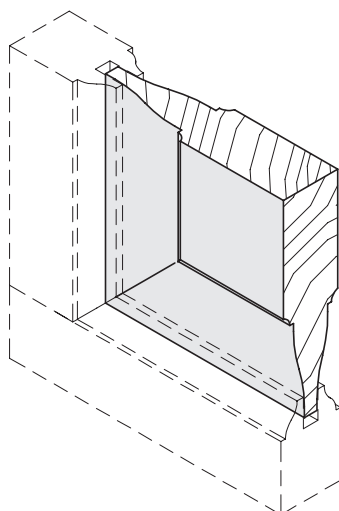

- Weitere Profilvarianten
- *additional profiles*



**Abplattfräser**  
*Panel raising cutter*

MAN

HW

D	B	d	Z	n <sub>min</sub> - n <sub>max</sub>	SUP	INF
200	30	30/50	2+2	3900-6600	● 5279.200.030	5279.200.130

- Abplattfräser wird mit P1 geliefert, auf Anfrage mit P2, P3 oder Profilen nach Wunsch.
- *panel raising cutter is supplied P1; on request, it can be supplied with P2, P3, or custom profiles*
- WP-Pofilmesserkopf mit Stahlgrundkörper zum Abplatten von Rahmenfüllungen
- Profilmesserkopf für vier verschiedene Abplattprofile zum einseitigen oder beidseitigen Abplatten
- Ausführungen für manuellen Vorschub.
- *panel raising cutter with steel tool body and replaceable knives for flattening frame panels*
- *profile cutterhead for four different panel raising profiles for one-sided or double-sided flattening*
- *for manual feed*

**Wechselmesser/Ersatzteile**  
*Replacement knives/Spare parts*

	Nr.	Dim.	Art.Nr.
Wechselmesser - <i>Replacement knife</i>	1 (SUP)	25x30x2	782.501
	2	25x30x2	782.502
	3	25x30x2	782.503
	4	25x30x2	782.504
	1 (INF)	25x30x2	782.505
	2	25x30x2	782.506
	3	25x30x2	782.507
	4	25x30x2	782.508
Spannkeil - <i>Clamping wedge</i>	SUP		707.561
	INF		707.953
Wendemesser - <i>Replacement knife</i>		50x12x1,5	750.106
	Spannkeil - <i>Clamping wedge</i>		707.144
	INF		707.139
Gewindestift - <i>Set screw</i>		M8x16	705.542
		M10x16	705.551
Sechskantschlüssel - <i>Allen key</i>		SW4	706.104
		SW5	706.105

- Standardprofil P1 und weitere Profilvarianten
- *basic profile P1 and additional profiles*

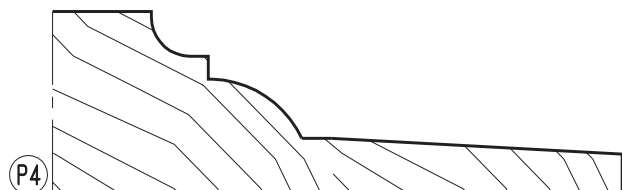
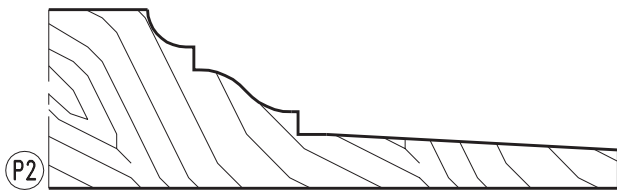
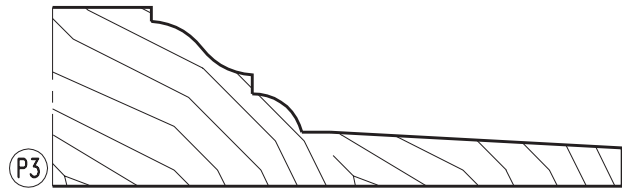
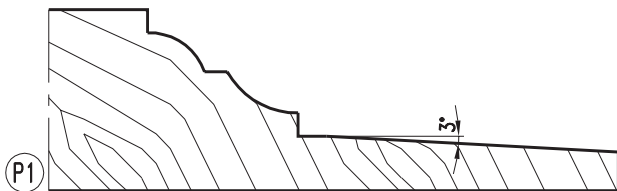
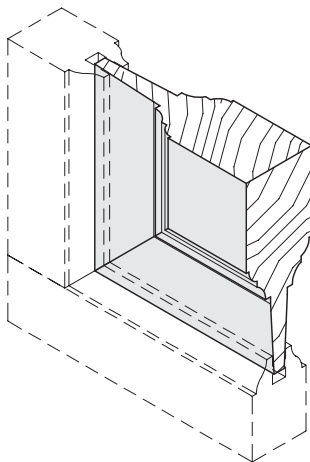
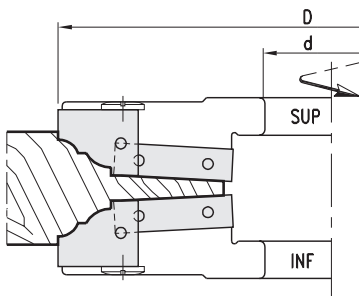

- Weitere Profilvarianten
- *additional profiles*

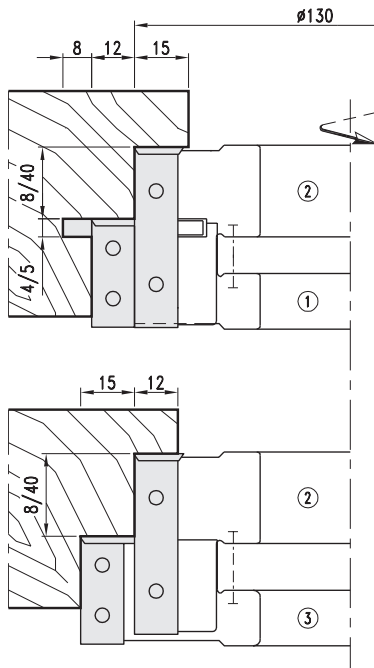

**Doppelfalz-Fräsgarnitur für Türblätter**  
*Double rebate cutter set for door leaves*

MAN

HW

Nr.	D	B	d	Z	V	I	n <sub>min</sub> - n <sub>max</sub>	Art. Nr.
1	154	30	50	2	2	2	5000-8600	<b>5299.154.030</b>
2	130	50	50	2	2		5800-10000	<b>5299.130.050</b>
3	160	30	50	2	2		4800-8200	<b>5299.160.030</b>
4	140	30	50	2	2		5500-9500	<b>5299.140.030</b>
5	124	30	50	2	2		6400-11100	<b>5299.124.030</b>

- WP-Doppelfalz-Messerkopf mit Stahlgrundkörper zum Fräsen von Doppelfalzprofilen mit oder ohne Rahmendichtung. Geeignet für Weich- und Harthölzer sowie Verbundwerkstoffe.
- Ausführung für manuellen Vorschub
- *Double rebate cutterhead with steel body and reversible knives for cutting double rebate profiles with or without frame seals. Suitable for softwoods and hardwoods, and composite materials.*
- *for manual feed*

**Wechselmesser/Ersatzteile**  
*Replacement knives/Spare parts*

	Nr.	Dim.	Art.Nr.
Wechselmesser - <i>Replacement knife</i>		30x12x1,5	<b>750.104</b>
		50x12x1,5	<b>750.106</b>
Spannkeil - <i>Clamping wedge</i>	1/3/4/5		<b>707.002.28</b>
	2		<b>707.002.48</b>
Gewindestift - <i>Set screw</i>		M8x16	<b>705.542</b>
Vorschneider - <i>Scoring blade</i>	2	14x14x2	<b>750.111</b>
Spannschraube - <i>Clamping screw</i>		M5x7	<b>705.425</b>
Nutmesser - <i>Grooving blade</i>		17x35x4	<b>783.120</b>
		17x35x5	<b>783.121</b>
Schraube - <i>Screw</i>		M5x13,5	<b>705.318</b>
Sechskantschlüssel - <i>Allen key</i>		SW3(M5)	<b>706.103</b>
		SW4(M8)	<b>706.104</b>

- Standardprofil P1 und weitere Profilvarianten
- *basic profile P1 and additional profiles*

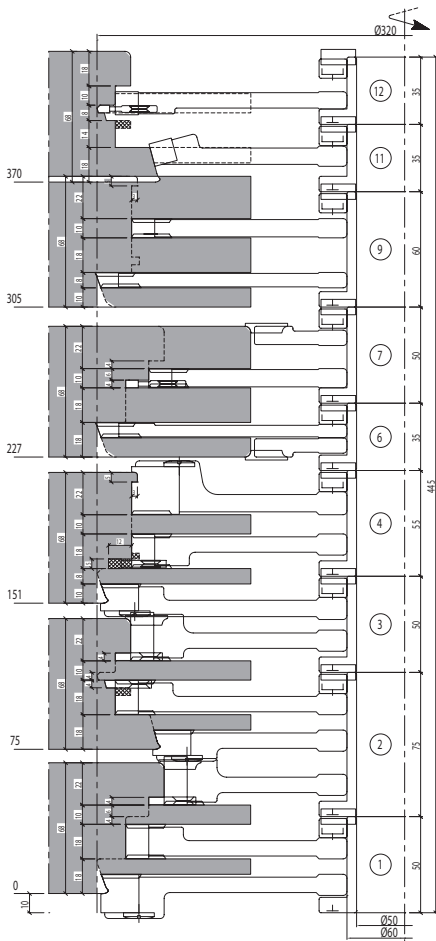

- Werkzeuge zur Fensterherstellung für alle Bearbeitungsmaschinen (manueller oder mechanischer Vorschub). Hergestellt gemäß der Norm DIN EN 847-1.
  - Fenstergarnituren werden auf die erforderlichen Nullabstimmungsdurchmesser aufgebaut
  - Alle Werkzeugsätze sind mit Schraubbüchsen verschraubt sowie in Durchmesser und Höhe abgestimmt
- tools for window manufacturing for all processing machines (manual or mechanical feed) designed in accordance with DIN EN 847-1*
- *all window tool sets are built to the required zero-adjustment diameters, matched in diameter and height, and fastened with screw bushings*

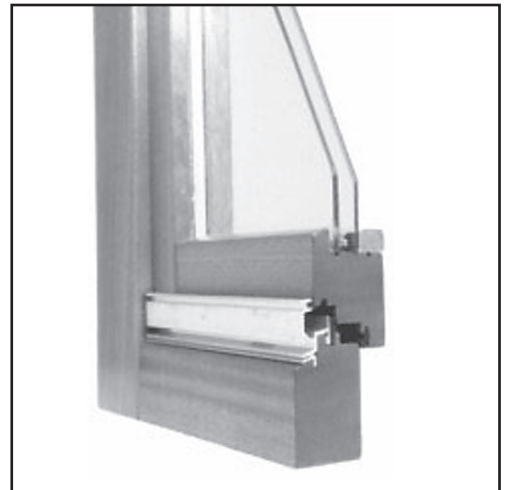
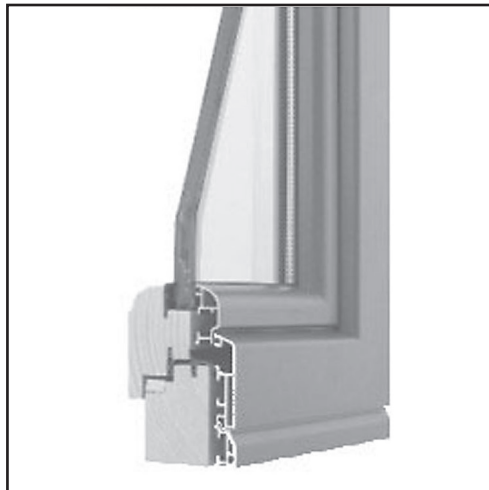
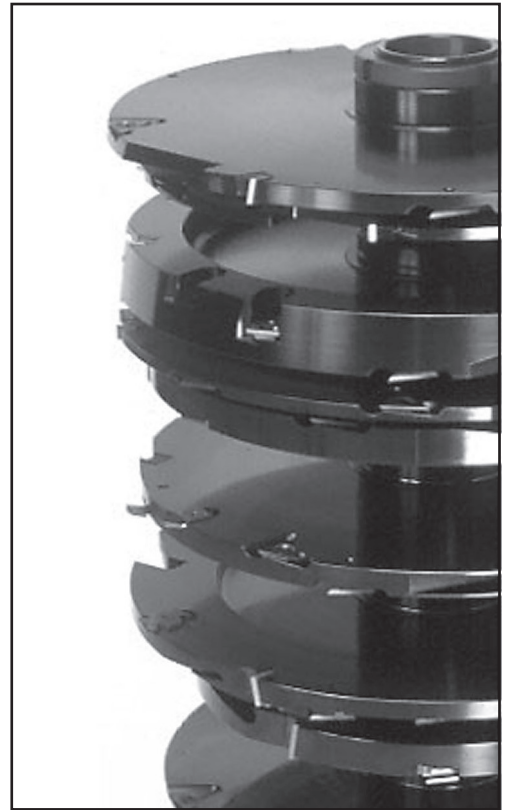

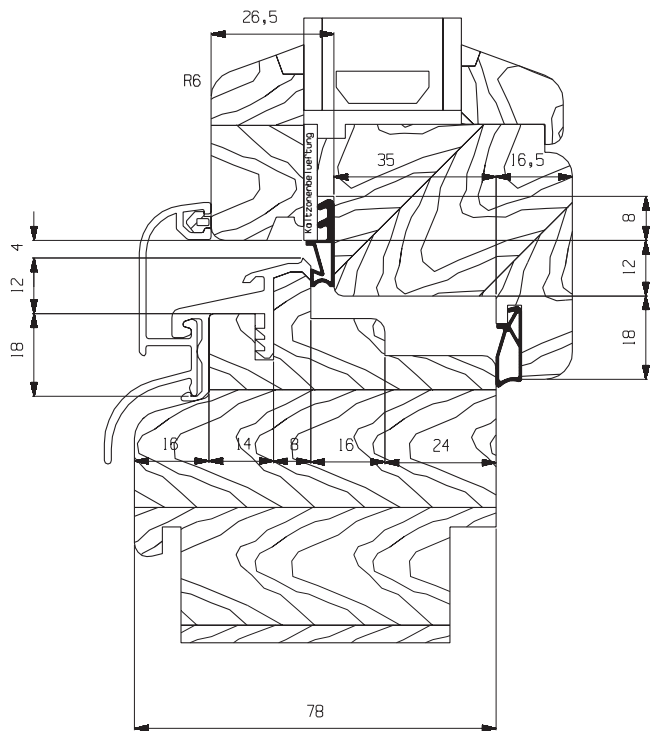
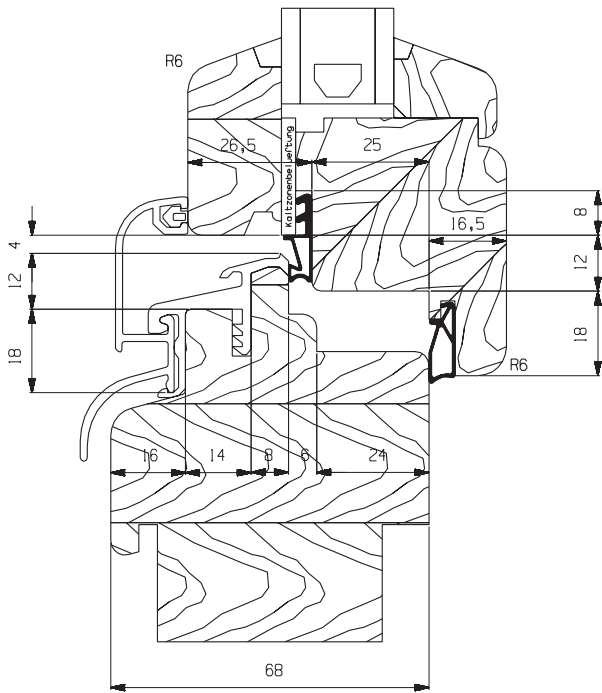
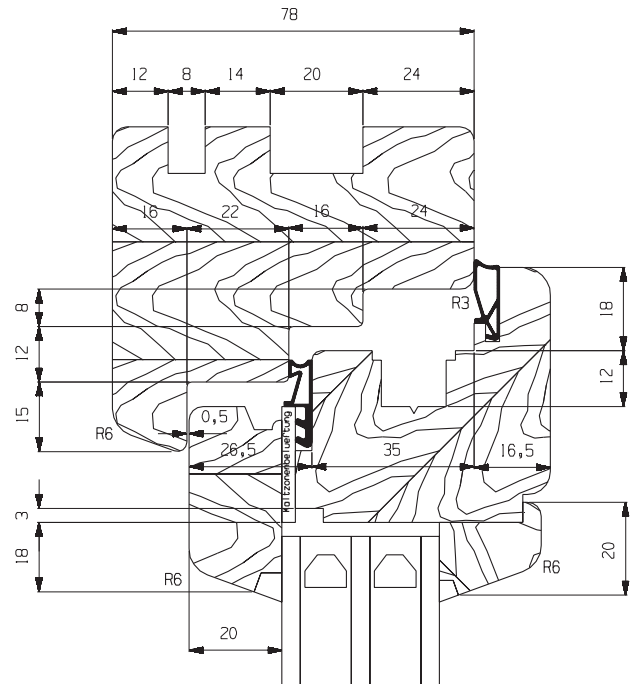
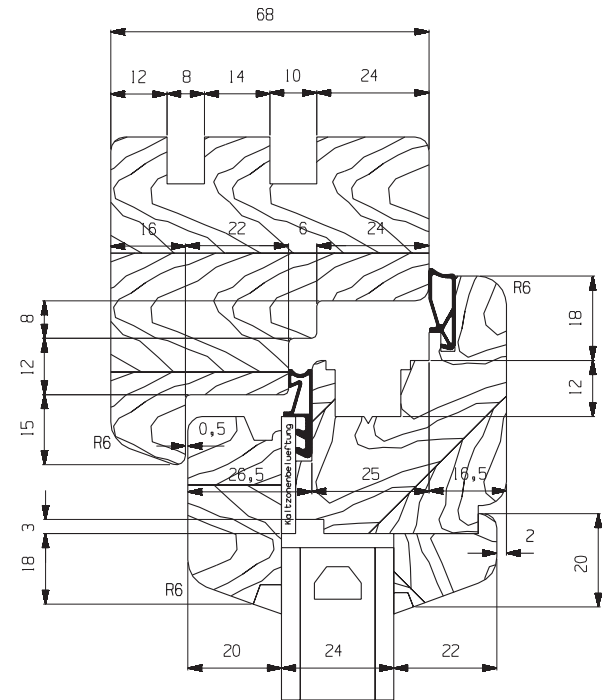

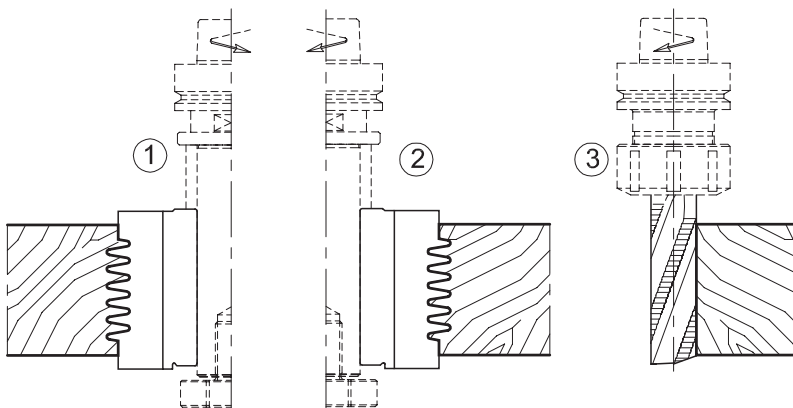
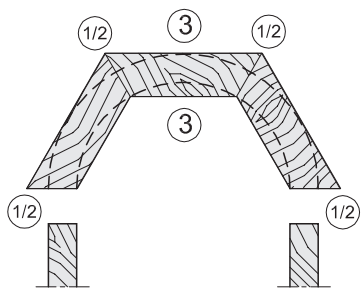

**Option A**

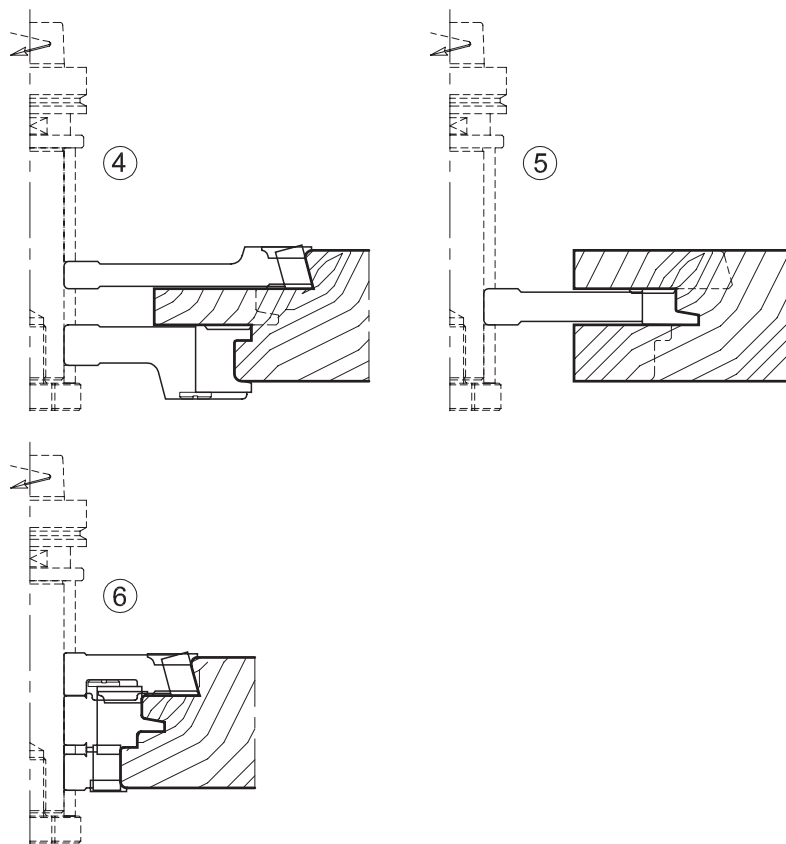
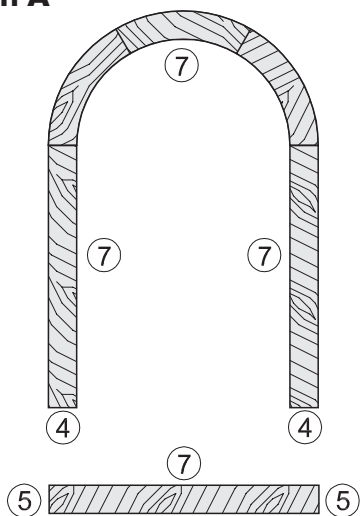

**Option B**

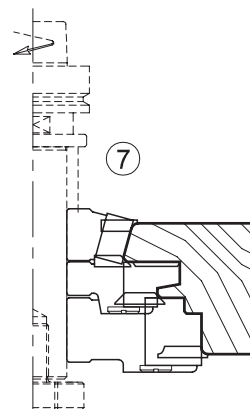
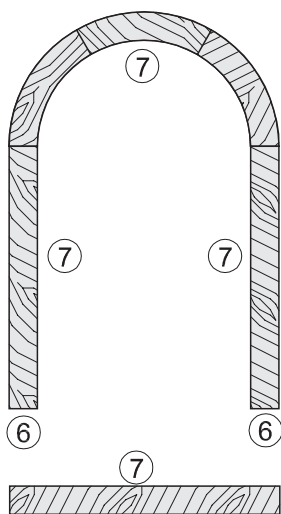

- 01 Sägen
- 02 Spalten
- 03 Hobeln / Fräsen
- 04 Profifräsen**
- 05 Nut- und Federfräsen
- 06 Oberfräsen
- 07 Bohren
- 08 PKD-Werkzeuge
- 09 Spannen
- 10 Ersatzteile
- 11 Informationen

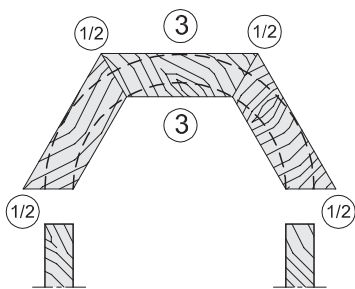

Option A

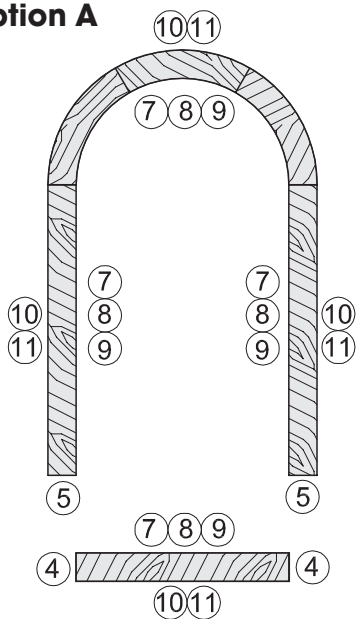
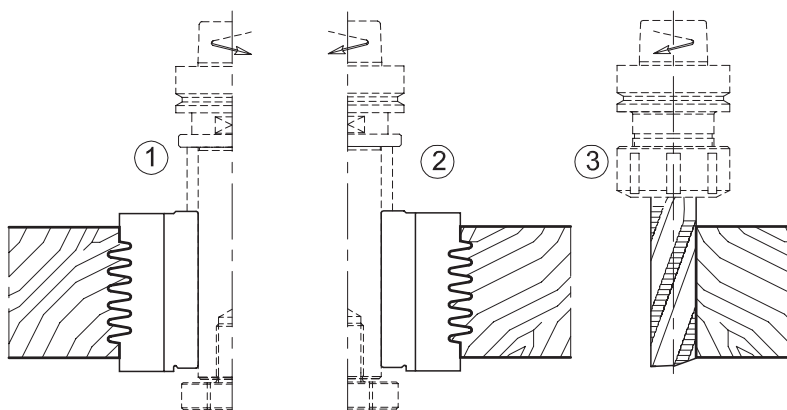

Option B

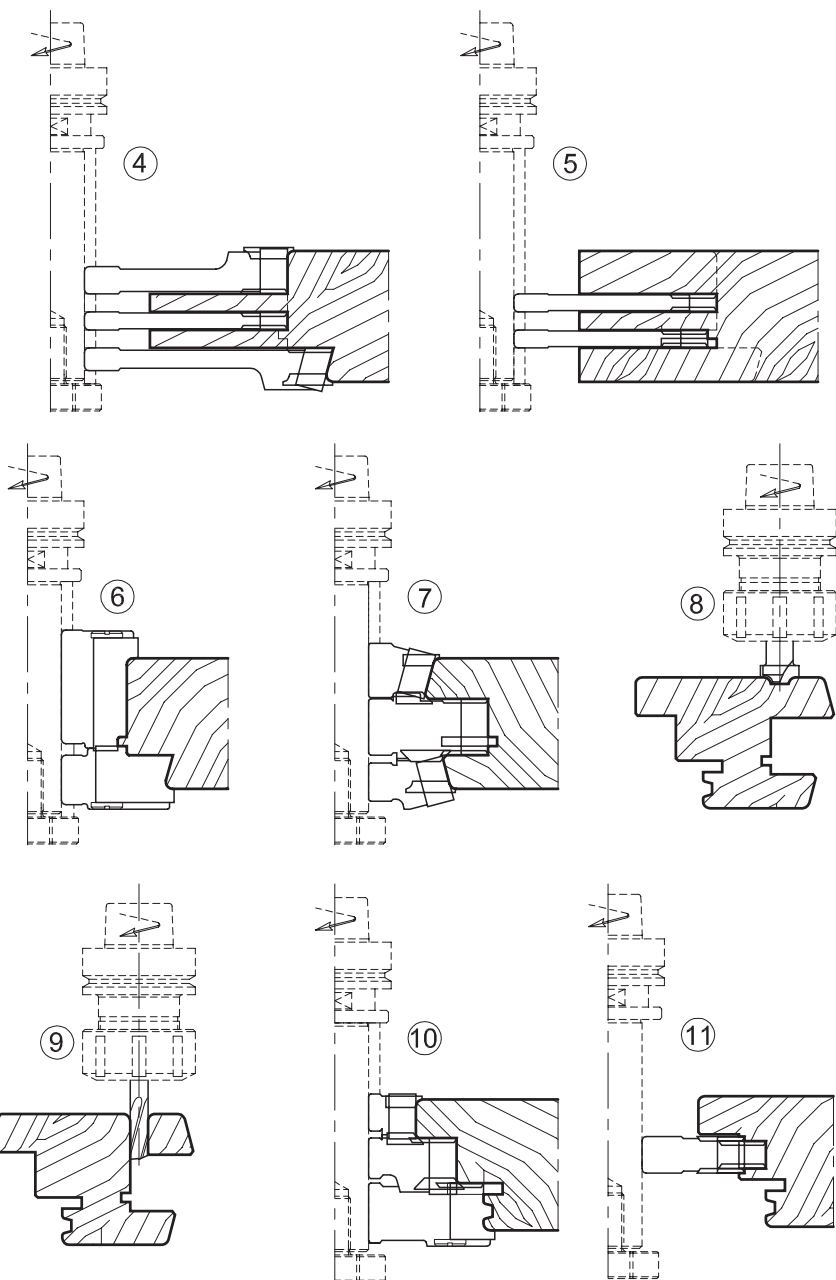

**HW-bestückter Konterprofilfräser für Aluminiumprofile**  
*TC-tipped counter-profile cutter for aluminium profiles*

MEC

HW



Nr.	D	B	d	Z	Art. Nr.
<b>Profil 1 - Profile 1</b>					
1	100	7,5	32	8	<b>8974.100.008</b>
2	100	7,5	32	8	<b>8974.100.108</b>
1+2					<b>8974.001.000</b>
<b>Profil 2 - Profile 2</b>					
1	120	15	32	6	<b>8974.120.015</b>
2	120	15	32	6	<b>8974.120.115</b>
1+2					<b>8974.002.000</b>
<b>Profil 3 - Profile 3</b>					
1	120	15	32	6	<b>8974.120.215</b>
2	120	15	32	6	<b>8974.120.315</b>
1+2					<b>8974.003.000</b>

- HW-Profilmesserkopf mit Stahlgrundkörper zum Fräsen von Profilen und Konterprofilen an Aluminiumprofilen
- Erhältlich in drei Profilvarianten
- Ausführungen für mechanischen Vorschub
- *TC profile cutterhead with steel body for cutting profiles and counter-profiles on aluminium profiles*
- *available in three different profiles*
- *for mechanical feed*

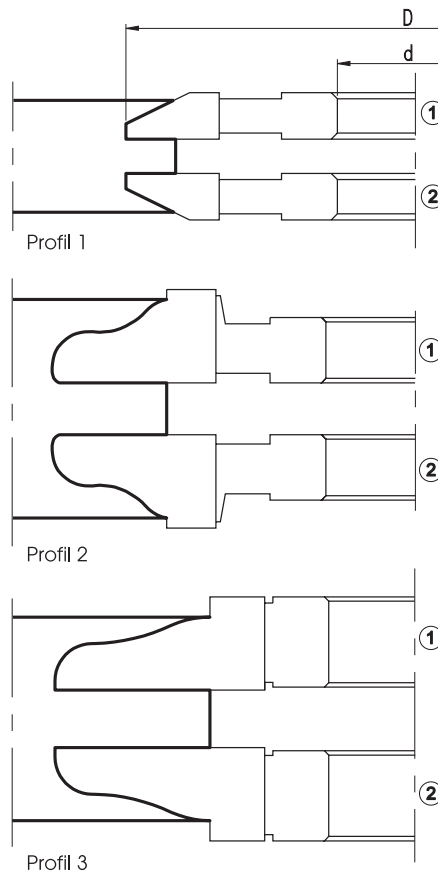



**Verputzfräser** (auf Anfrage)

Zum Überfräsen der verschweißten Gehrungsprofile  
 Profile werden im 45°-Winkel gefertigt und individuell für jeden Auftrag  
 eingerichtet

**Finishing cutters** (on request)

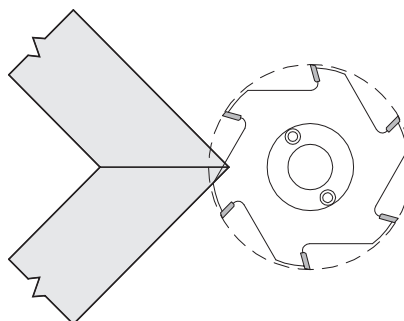
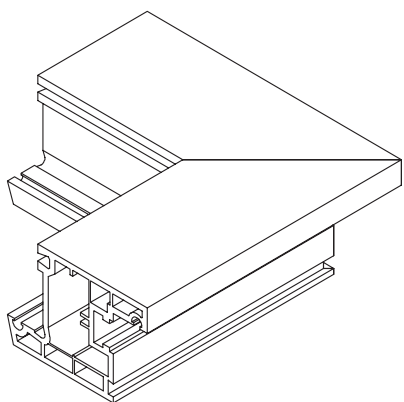
for removing welding excess on PVC windows and frames  
 profiles adjusted at 45° and set up customised for each application

**Profil-Konterprofilfräser** (auf Anfrage)

Zum Fräsen von PVC-Profilen

**Counter-profile cutters** (on request)

for cutting PVC profiles

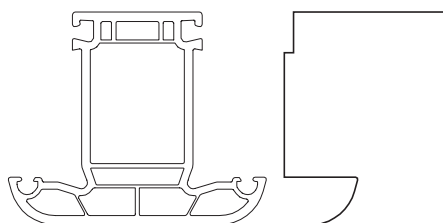
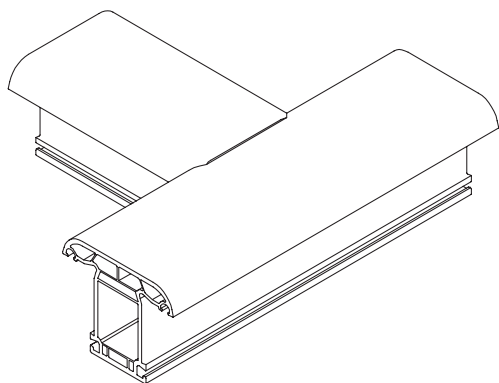



- 01  Sägen
- 02  Zerspanen
- 03  Hobeln / Fräsen
- 04**  Profilfräsen
- 05  Nut- und Federfräsen
- 06  Oberfräsen
- 07  Bohren
- 08  PKD-Werkzeuge
- 09  Spannen
- 10  Ersatzteile
- 11  Informationen

